

KEYNOTES

- ① DM18
- ② 3502-1/2/3
- ③ DM18
- ④ 20-339-1/2
- ⑤ STEELGARD
- ⑥ STEELGARD
- ⑦ DM18
- ⑧ 20-10-1/2
- ⑨ NOT USED
- ⑩ STEELGARD
- ⑪ 4188/89

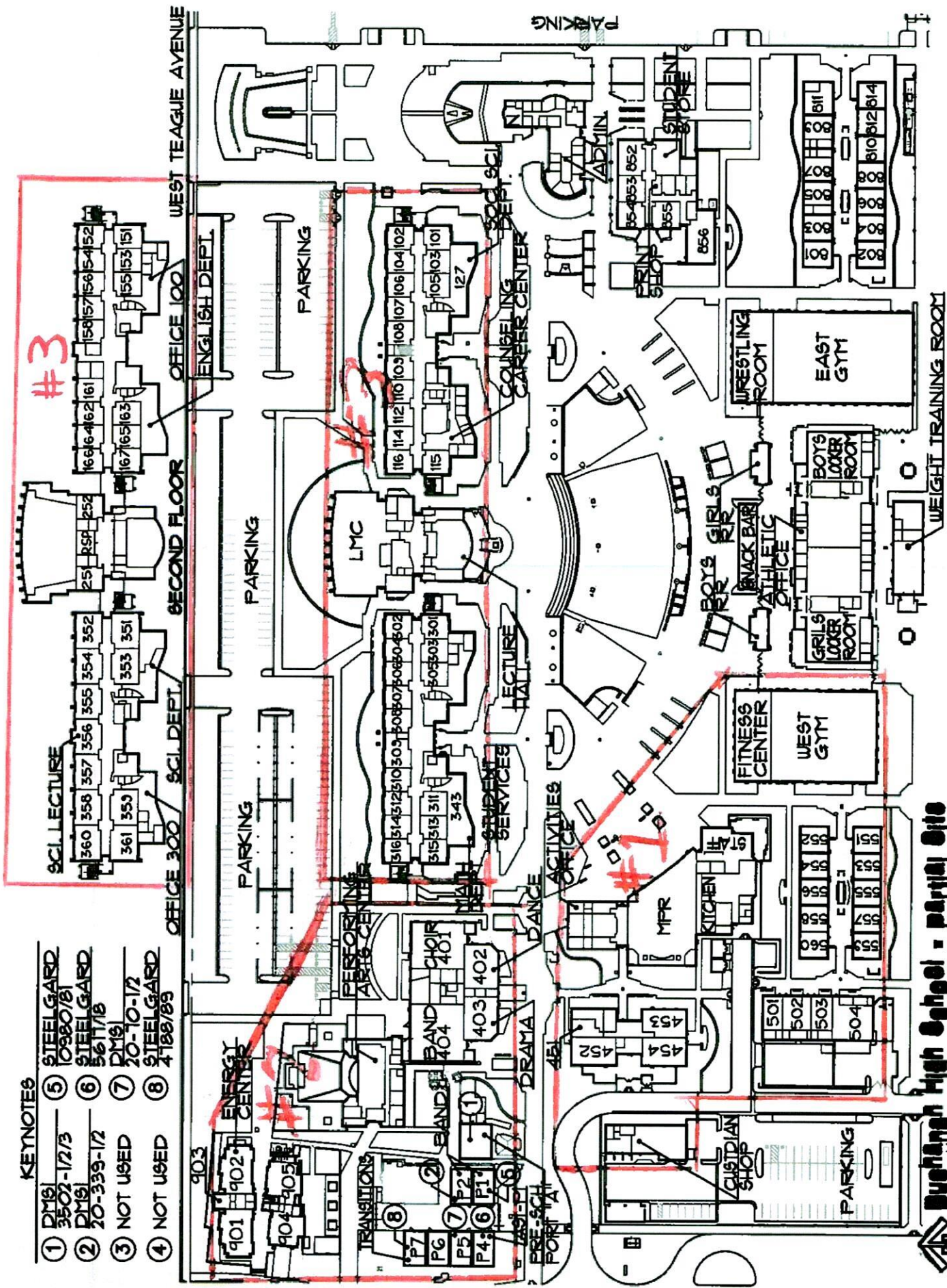

Buchanan High School - partial site
 1860 N. Minnewawa, Clovis California 93612

TECHNICAL SPECIFICATIONS

FOR

Buchanan High School

Buchanan High School

1560 N. Minnewawa Ave
Clovis, ca 93619

CLOVIS UNIFIED SCHOOL DISTRICT
1450 HERNDON AVENUE
CLOVIS, CA. 93611

GENERAL

Buchanan High School (2023) - CUSD

1.01 SCOPE OF WORK:

- A. A pre-job conference will be held prior to the start of the project. At that time the paint specifications will be presented and understood by the job foreman. Any questions are to be addressed at that meeting.

- B. The work to be done consist of providing and furnishing all labor, materials, equipment, tools, services, and incidentals necessary to prepare, paint and refinish the outside and exterior surface of the site buildings listed in the attached bid. The exterior of Clovis Unified School District buildings are to be painted on exposed surfaces shown in District specs. Painting will start only when a sample patch is completed. This will be standard of project; no paint will be applied until sample wall has been approved by C.U.S.D. Work to be performed in strict accordance with these specifications. All work will be corrected which does not comply with the intent of these specifications.

- C. Each item or area in these specifications is described by the most commonly used name and the contractor will inform himself and his employees of the areas that are to be painted. Areas to be painted will be gone over very clearly at the job walk through, including materials and surfaces to be designated.

- D. The school district reserves the right to award the painting work to any contractor as its best interest may appear or reject any or all for any reason.

- E. All lead-based paint surface preparation and paint stabilization shall be performed by California Department of Health Services (DHS) certified personnel. All lead waste shall be properly stored onsite and characterized for disposal. Based on characterization results, hazardous waste shall be handled by a licensed hazardous waste transporter. Disposal must be in accordance with all applicable federal, state and local regulations.

Contractor must provide a DHS Certified Project Monitor or Inspector/Assessor responsible for overseeing the job until the surface preparation process is complete.

Exterior lead preparation work **may not** be done during normal business hours when school is in session.

F. REGULATIONS:

The contractor shall assume full responsibility and liability for the compliance with all applicable Federal, State, and local regulations pertaining to work practices, hauling, disposal, and protection of workers, visitors to the site, persons, and subcontractors occupying areas adjacent to the site. The contractor is responsible for providing medical examinations and maintaining medical records of personnel as required by the applicable Federal, State, and local regulations. The contractor shall hold the District harmless for failure to comply with any applicable work, hauling, disposal, safety, health or other regulation on the part of himself, his employees, or his subcontractors.

Federal Requirements, which govern, lead work or hauling and disposal of lead containing waste materials include, but are not limited to the following:

A. U.S. Department of Labor, Occupational Safety and Health Administration, (OSHA), including but not limited to:

1. Construction Industry
Title 29, Part 1926 of the
Code of Federal Regulations
2. Respiratory Protection
Title 29, Part 1910, Section 134 of the
Code of Federal Regulations
3. Access to Employee Exposure and Medical Records
Title 29, Part 1910, Section 2 of the
Code of Federal Regulations
4. Hazard Communication
Title 29, Part 1910, Section 1200 of the
Code of Federal Regulations

B. California Occupational Safety and Health Administration, (Cal/OSHA), including but not limited to:

1. Title 8 CCR Section 1532 .1
Construction Safety Orders, Lead

C. California Department of Health Services

1. Title 17 CCR Division 1, Chapter 8
Accreditation, Certification, and Work Practices for
Lead-Based Paint and Lead Hazards

F. REGULATIONS: (Cont.)

D. State and Federal Regulations, which govern lead waste hauling, and disposal of lead containing waste materials include but are not limited to the following:

1. Title 40-Parts 262 & 263 of the Code of Federal Regulations
2. Title 22-Code of California Regulations Division 4, Chapter 30

E. DOT: US Department of Transportation Hazardous Substances

1. Title 49, Part 171 and 172 of the Code of Federal Regulations
2. Contractor shall abide by all local requirements, which govern hauling, and disposal of lead containing waste material.

G. SUBMITTALS:

Within ten (10) days of award and prior to the start of work, each contractor or sub-contractor that performs manual demolition, sanding, scraping, abrasive blasting, heat gun applications, welding, or torch cutting of any building construction material that has been identified to contain lead based paint, shall submit the following to the general contractor and the District's Maintenance Manager, 1490 Herndon Ave., Clovis, CA 93611.

1. A diagram for each work area indicating the work site preparation and locations of barriers, decontamination units or hand washing stations.
2. A copy of the contractor's health and safety (SB 198) program for lead paint.
3. A copy of the contractor's respiratory protection program.
4. Medical approval for respirators for each worker.
5. Recent (within 6 months) Lab Certified Lead-in-Blood Level Test Results.

G. SUBMITTALS: (Cont.)

6. A Current training certificate for each worker (24 hour) and supervisor (40 hour) on site.
7. Certificates of Worker Acknowledgement for each worker. Sample attached.
8. Written Cal/OSHA compliance program for the project including:
 - a. A description of each activity in which lead is emitted; e.g., equipment used, material involved, controls in place, employee job responsibilities, operation procedures, and maintenance practices.
 - b. Air monitoring data, which document the source of lead emissions.
 - c. A description of arrangements made among contractors on multi-contractor sites with respect to informing affected employees of potential exposure to lead and with respect to responsibility for compliance with this section.
 - d. Provisions for frequent and regular inspections of the job site, materials, equipment and housekeeping to be made by a DHS Certified Project Monitor or Inspector/Assessor.
9. A letter from contractor provided DHS Certified Project Monitor or Inspector/Assessor, providing their certification number and a statement confirming that they will oversee and monitor the lead surface preparation stage of the contract to ensure compliance with the bid specification and all applicable laws and regulations.

H. WORK PRACTICES:

This procedure shall apply only to projects involving lead paint surface preparation. No exterior lead paint surface preparation, scraping, sanding, etc., will be allowed during regular business hours, when school is in session, on the exterior of the building(s). Suitable times must be worked out with the District at least twenty-four (24) hours in advance to allow for scheduling of inspector and/or the District at least twenty-four (24) hours in advance to allow for scheduling of inspector and/or caretaker to be on site.

Overtime for District personnel will be District responsibility for lead preparation work only.

Interior lead surface preparation work shall be coordinated with other contractors and/or the district to ensure the paint contractor's exclusive access to the work area.

All workers shall be fully trained and certified to work with Lead Based Paint (LAP). Training must be conducted in accordance with Title 17 CAR, Section 35065, Article 7, Lead-Related Construction Work Course.

The following practices shall be followed unless it is verified that the paint is lead free.

Section 1: Personal Protective Equipment

1. Employees shall wear HEPA filter (magenta/purple) equipped half mask or full faced respirators. Employees shall be medically approved and trained to wear respirators.

1.02 SPECIAL CONDITIONS:

- A. Due to the nature of the work, it is strongly recommend that all Contractors bidding on the work visit the site in order that they have full knowledge of all difficulties affecting the work which may not be particularly described herein. The Contractor shall make allowances for the fact that adjacent buildings, students and faculty may use corridors, and their activities will not be adversely interrupted.
- B. The walk-through is to inspect buildings for estimating needs; size, height, surface type, and general knowledge of the scope of the project. The conference will also be for the purpose of inspecting the job sites and to determine the interpretation and specifications for bidding projects. If you don't attend both conferences and walk-through of sites, this will not be a justification to exclude or change any part or work due to these specifications. Any walk-through will be done by the Job Site Inspector.

1.03 CARE OF EXISTING STRUCTURES:

The Contractor shall be liable for all damage done to any structure arising through his operations. Contractor shall repair all damage done to any of the structures through his acts or neglect and shall leave said structures in as good condition as they were prior to the commencement of the work.

1.04 MATERIAL AND WORKMANSHIP

- A. The Contractor shall make the application in a neat and workmanlike manner and be responsible for leaving the area free of debris at completion of each days work.
- B. Application of all materials will be in accordance with the material manufacturer's recommendation and instructions, unless otherwise noted in these specifications, or on the job inspector.
- C. The Contractor shall provide signs informing personnel and students of work in progress, newly painted surfaces and provide other working warning signs as required.
- D. The Contractor will not store flammable materials inside buildings.
- E. The Contractor will mix paint in a location and manner that will protect the environment and facilities.
- F. The Contractor will provide ventilation needed to comply with OSHA, DHS, local or state agency requirements and safety regulations.
- G. The Contractor will provide a portable storage container for his equipment and materials. If flammable materials are stored in his container, the container will be located no closer than 50 feet of any structure and will be plainly marked "FLAMMABLE-KEEP AWAY". The location of said container will be coordinated with and designated by the on-job inspector or District.

1.05 COORDINATION OF WORK:

The Contractor will coordinate all aspects of the work with the on-site District Inspector.

1.06 APPLICABLE STANDARDS:

- A. Uniform Building Code, 1988
- B. OSHA Standards
- C. National Fire Codes (NFC), 1988
- D. Painting and Decorating Contractor of America (PDCA), "Modern Guide to Paint Specifications"
- E. Clovis Unified School District Standards supersedes all others.
- F. All products will comply with the requirements of California Air Resource Board (CARB) and the Environmental Protection Agency (EPA) and OSHA rulings governing the use of applied paint coatings.

1.07 COLOR SELECTION/APPROVAL:

Within five (5) days after receipt of Notice to Proceed and before applying any paint or finish material, the Contractor shall submit to the Plant Operations Department a six (6) inch square sample of each color of each type of paint (latex, enamel, etc.) to be used. The colors desired will be selected from the manufacturer's standard color selection charts, furnished by the Contractor or the District Office. The sample color squares will be given to the on-site inspector.

1.08 CONTRACTOR'S ACCESS TO WORK:

Contractor's vehicles may enter the school property and use any driveways and paved access roads available, however, utmost safety precautions must be observed at all times while driving on and/or around the school grounds. Contractor's employees may park their private vehicles in designated school parking lots or on public streets. Parking of private vehicles on the school grounds adjacent to buildings will not be allowed.

1.09 PRESERVATION:

Floors, furnishings, equipment, finish hardware, name of information plates, dials, gauges, tile, or other such surfaces not requiring job painting shall be protected from spotting, spillage, or damage of any kind. Should any of these surfaces be damaged, they shall be cleaned, repaired, or replaced as directed.

Hardware, fixture canopies, outlet covers, switch plates, and/or other similar items shall be removed, loosened, or masked as required for painting work and then replaced.

Equipment adjacent to walls shall be disconnected by workman skilled in these trades and moved to permit the wall surfaces to be painted, and following completion of painting shall then be replaced and reconnected.

1.10 MATERIALS:

All paint material shall be of best quality as manufactured by a leading manufacturer such as Sherwin Williams, Dunn Edwards, Kelly Moore, PPG, or approved by Los Angeles City Board of Education or equal.

The products listed are as manufactured by the Frazee Company unless otherwise specified. Equal products by others may be used only by submitting product list and substantiating technical information of products proposed for approval before bid opening.

All materials proposed for use shall be delivered to the site in original Containers, seals unbroken, stored where directed, and none shall be used until approved by the on-site District inspector. Materials not approved must be taken for testing where deemed necessary. Cost of testing will not be charged to the Contractor unless material tested fails to meet requirements. Cost for testing which fails to meet requirements will be charged against the Contractor. All materials used will have a ten-year labor and material guarantee issued by paint manufacture.

1.10 MATERIAL

<u>FINISH NO.</u>		<u>EXTERIOR MATERIAL</u>	
1	STUCCO, Concrete, Block, plaster, <i>(Previously painted)</i>	<u>1st Coat:</u> <u>2nd Coat:</u> <u>3rd Coat:</u>	#168 Prime Plus #A84 Super paint Gloss #A84 Super paint Gloss
2	METAL DOORS, DOOR & WINDOW FRAMES (Doors & door frames: Interior & exterior)	<u>1st Coat:</u> <u>2nd Coat:</u> <u>3rd Coat:</u>	#B66 Pro-Cryl #B66-650 Pro Industrial 100% Acrylic #B66-650 Pro Industrial 100% Acrylic
3	CORRUGATED METAL <i>(Siding & Canopy's)</i>	<u>1st Coat:</u> <u>2nd Coat:</u> <u>3rd Coat:</u>	#B66 Pro-Cryl #A84 Super paint Gloss #A84 Super paint Gloss
4	MISCELLANEOUS METALS (Previously finished) <i>(Gates, fences, shade structures)</i>	<u>1st Coat:</u> <u>2nd Coat:</u> <u>3rd Coat:</u>	#B66 Pro-Cryl #B66-650 Pro Industrial 100% Acrylic #B66-650 Pro Industrial 100% Acrylic
5	MISCELLANEOUS METALS (Unfinished) <i>(Conduit, downspouts, electrical Panels)</i>	<u>1st Coat:</u> <u>2nd Coat:</u> <u>3rd Coat:</u>	#B66 Pro-Cryl #A84 Super paint Gloss #A84 Super paint Gloss
6	ALL EXTERIOR WOOD, (Siding, soffits, doors & trim) <i>(Doors & door frames: interior & exterior)</i>	<u>1st Coat:</u> <u>2nd Coat:</u> <u>3rd Coat:</u>	#168 Prime Plus #A84 Super paint Gloss #A84 Super paint Gloss
7	BASEBALL BACKSTOPS	<u>1st Coat:</u> <u>2nd Coat:</u> <u>3rd Coat:</u>	#168 Prime Plus A89-Series super paint Satin A89-Series super paint Satin
8	A/C UNITS, vents, roof jacks	<u>1st Coat:</u> <u>2nd Coat:</u> <u>3rd Coat:</u>	#B66 Pro-Cryl #A84 Super paint Gloss #A84 Super paint Gloss

9 ALL UNPAINTED BLOCK

1st Coat: Seal Krete

Note: 1- *Miscellaneous Metals (#4,#7)) shall be prepped and spot primed with #215969 Rust-Oleum oil based metal primer prior to full coat system*

Note: 2 *All school signs and classroom numbers will be installed or repainted by contractor and will be designated by the on - site inspector or District Representative.*

10 PARKING LINES

Arrows, Basketball and
Volleyball courts, play areas, games,
Safety door circles and curbs

Traffic Paint:

White-Fast Dry TP 6101

Red-Fast Dry TP 1401

Blue-Fast Dry TP 1501

Yellow-Fast Dry TP 6201

Black-Fast Dry TP 6301

Green-Fast Dry TP 1601

Orange-Fast Dry

(Use Sherwin-Williams

Knockout Orange TM 2153

FC 18-366)

International Coatings

Purchase – STATEWIDE

3049 s. Golden State Frontage Rd.

Fresno, CA 93725

(559)291-8500

1.11 PAIN T SCHEDULE:

<u>FINISH NO.</u>	<u>EXTERIOR MATERIAL</u>
1.	Exterior stucco, plaster, block and brick.
2.	Metal doors, door and window frames. <i>(Doors & door frames, interior & exterior)</i>
3.	Corrugated metal
4.	Canopy supports, roof cap, metal gates and fences, Handrails, gutters, downspouts, electrical boxes, Pipes, conduit, ladders, basketball backboards Light poles, sea trains, <i>(all other painted medals not listed)</i>
5.	New conduit, gutters, downspouts, electrical panels <i>(All unpainted or shop primed metals not listed)</i> <i>(Aluminum & stainless steel, no service)</i>
6.	Portables, soffits, doors <i>(All other wood not listed)</i>
7.	Baseball backstops
8.	A/C units on roof
9.	All Unpainted Block <i>(Attached to buildings)</i>
10	Parking lines, arrows, written directions, games, curbs

These specifications are designed to cover all surfaces that are painted at Clovis Unified School District schools. If by chance any surfaces have been left out, there are sufficient material systems to cover any and all areas that are not listed. (See job-site inspector if this should happen for surface systems.)

SECTION 2

2.01 DESCRIPTION AND SCOPE:

The work includes surface preparation, application of necessary primer, and finished coats of paint to doors, windows, trim, flashings, eaves, and other associated items. This work includes the painting of all exterior areas and connecting corridors. Doors will be painted on both sides and shall be done by experienced skilled craftsman.

2.02 PAINT:

The term "paint" as used herein includes emulsions, enamels, epoxies, oil and water base paints, filler and sealers, whether prime, second, or final coat, and whether used on wood, metal, stucco, or masonry surfaces. It also includes stains, varnishes, and heavy bodies texture coatings including roof coating when specified.

2.03 CLEANING, PREPARATION, AND PRETREATMENT OF SURFACES:

- A. General. All surfaces shall be prepared in a skillful manner to produce finish work of first class appearance and durability. Hardware, hardware accessories, machined surfaces, plated, lighting fixtures, and similar items in contact with surfaces to be painted shall be removed, masked or otherwise protected prior to surface preparation and painting operations. Surfaces to be painted shall be cleaned before applying paint or otherwise protected prior to surface preparation and painting operations. Cleaning and painting shall be so programmed that dust and other contaminants from the cleaning process will not fall on wet, newly painted

surfaces. Feather edged sanding will be required where the old surfacing has been removed and the immediate adjacent area has sharp or raised edges.

- B. All exposed mastic, concrete, stucco and/or plaster surfaces shall be thoroughly cleaned with approved cleaner, using Hydro-Cleaning equipment, to thoroughly remove all dirt, loose particles, water base paint, foreign materials, grease and oil, then rinsed with clean water to remove all residue. Efflorescence shall be brushed off the surface neutralized with a strong solution of Muriatic Acid and K-14 tetrapotassium-antpyrophosphate and then thoroughly rinsed with clean water or other approved methods. All dryvit surfaces must patched with dryvit materials not stucco patch.

2.03 CLEANING, PREPARATION, AND PRETREATMENT OR SURFACES (Cont.)

Before any cleaning of water blasting operation is started, the soil at the base of the building shall be trenched to a depth of six inches and eight inches wide. After completing the painting application, allowing sufficient drying time, the trench shall be refilled. All areas where the finish plaster coat is loose shall have the portion removed to a solid surface. All surfaces that are broken, cracked, or damaged, and areas where the finish plaster coat has been removed, shall be coated with Weld-Crete as manufactured by Larsen Products Corporation or equal, then shall be given a cement plaster finish coat consisting of one-part Portland Cement to here parts sand to match the existing finish. All cracks shall be "V-eed" out, filled, finished flush with, and of texture to match the adionina surface.(Zero tip water blasting will not be allowed on any surfaces)

All caulking, which will interfere with the proper application of the waterproof coating, shall be removed. Caulk around door and window frames, flashing, vents, etc., with a caulking compound recommended by the manufacturer of the coating to be used. Caulking and filling to be done with sufficient pressure to for the material to the base of the opening.

- C. Wood Surfaces. Other than surfaces to be given a natural finish, wood surfaces shall be primed and finish coated as specified herein. Wood surfaces to be painted shall be cleaned of dirt, oil and other foreign substances with mineral spirits, scraper and sandpaper. The surface shall be checked thoroughly to ensure all finishing nails have been properly set; then all holes and surface imperfections shall be patched and primed. Laminated beams,

knotholes, cracks and all imperfections shall be filled with appropriate material, primed and finished.

- D. Concrete/Masonry Surfaces. Concrete, stucco, Dryvit system, block and masonry surfaces to be painted shall be prepared by removing chalk, loose paint, dirt, dust, grease, oil and other foreign matter. All holes and cracks in the surface wall will be repaired using an approved patching compound for the size of patch required. Star stucco patching compound is the acceptable standard. It shall be applied to the crack only (not to the sides of the crack). Extreme care shall be used to keep patching material off of sides of the crack.
- E. Galvanized Metal Surfaces. Surfaces to be painted shall be prepared by removing all loose paint, dirt, dust, oil, grease and other foreign matter. The surface will be prewashed, galvawashed, then coated with #168 prime plus.

2.03 CLEANING, PREPARATION, AND PRETREATMENT OR SURFACES
(Cont.)

- F. Ferrous Metal Surfaces. Doors and frames, steel columns and the like, shall be washed with Tri-Sodium Phosphate of equal parts and rinsed to remove all greases, fill all holes and dents with an approved material that appears on the surface of interior and exterior of doors and metal trim then sand and feather edged and primed with #C309 Ultra Tech.
- G. Sash Windows. All loose and deteriorated glazing compounds will be removed and replaced with an approved glazing compound prior to painting.
- H. Stucco, Fascia, Buildings. Mildew accumulation of building will be removed by using a mildew stain remover such as X-14 as manufactured by White Laboratories, Inc. This application will be prior to the water blasting operation.
- I. Sandblasting.
 - 1. On surfaces requiring sandblasting the following shall be done:
 - a. Scaffolding where necessary shall be provided and installed by the painting contractor. It shall be installed so as not to interfere with the opening of exit doors of the buildings and so that all entrances may be used at all times.
 - b. Sandblaster shall protect all wood, metal, and glass surfaces from the sandblasting work. Sandblasting

contractor will be held fully responsible for any damage done to School District buildings and property and shall replace or repair to School District's satisfaction any damage that might be done as a result of sandblasting work.

- c. Sandblasting contractor will be held responsible for cleaning up all dust which sifts inside buildings or into adjacent rooms as well as for cleaning up the dust and debris resulting from his work and removing same from site, and for all damage done to buildings or equipment.
- d. Sandblasting will not be permitted on a Sunday unless written permission is received from School District

2.03 CLEANING, PREPARATION, AND PRETREATMENT OF SURFACES
(Cont.)

- e. Only sharp, dry sand of proper grading to give satisfactory results shall be used, as required by Air Quality Management District.
 - f. All machinery, equipment, etc., which might be damaged by sandblasting, and floor drains shall be sealed against entry of sand dust before sandblasting begins.
 - g. Dirt shall be excavated to a depth of five inches (5") below ground line and surfaces sandblasted to this point. All sand is to be removed from this trench to permit painting to this point.
 - h. Priming coat of paint shall be applied on metal surfaces that same day that sandblasting is done.
2. If cleaned surfaces rust before painting is accomplished, they shall be re-sandblasted at the painting contractor's expense.

2.04 CLEANING GLASS:

Upon completion of all painting work, all exterior glass surfaces shall be cleaned where paint and foreign materials have been left on glass.

2.05 CLEANING:

All cloths and cotton waste, which might constitute a fire hazard, shall be placed in a closed metal container or destroyed at the end of every workday. Upon completion of the work, all staging, scaffolding and containers shall be removed from the jobsite. On the last day of the workweek: pickup paper, plastic, tape and miscellaneous garbage on job-site.

2.06 WORKMANSHIP:

All work shall be done by painters and finishers of established status and reputation for executing their work by the very best methods for each kind of work. Strict adherence to the specifications and the recommendations of the manufacturer whose materials are used shall be followed in the application.

2.07 PAINT APPLICATION:

- A. General. The finished painted surfaces shall be free from runs, drops, ridges, waves, laps, brush marks, and variations in color, texture, and finish. The contractor will be totally responsible for color variation on all materials brought to the jobsite and used on site. The mixing shall be completed and each shall be applied so as to produce a film or uniform thickness. Special attention shall be given to ensure that all surfaces including edges, corners, crevices, welds, and fasteners receive a film thickness equivalent to that of adjacent painted surfaces. Adjacent areas and installations shall be protected by the use of drop cloths or other approved coverings. The contractor shall be liable for all damage caused to personnel, equipment, or facilities by over spray from painting operations where adequate protection was not provided.
- B. Coating Progress. Sufficient time shall elapse between successive coats to permit proper drying. This period shall be modified as necessary to suite adverse weather conditions. Paint shall be considered dry for recoating when the paint feels firm, does not deform or feel tacky under moderate pressure of the thumb, and the application of another coat of paint does not cause lifting or loss of adhesion of the undercoat or manufacturer specifications. Each coat shall be inspected and approved before proceeding with further coats. If a coat has not been inspected, the surface shall be recoated at the contractor's expense.
- C. Storage, Mixing, and Thinning. At the time of application, paint shall show no signs deterioration. Emulsion paints shall be protected from exposure to cold weather by storing in shelter so as to prevent freezing. Paint shall be thoroughly stirred, strained, and kept at a uniform consistency during application. Paints of different manufactures shall not be mixed together. Where necessary to

suit conditions of surface, temperature, weathers, and method of application, packaged paint may be thinned immediately prior to application in accordance with the manufacturer's instructions, but not in excess of one (1) pint of suitable thinner per gallon. The use of thinner shall not relieve the contractor from obtaining complete coverage without holidays.

2.07 PAINT APPLICATION: (Cont.)

- D. Atmospheric Conditions. Paints other than water-thinned coatings shall be applied only to surfaces that are completely free of surface moisture as determined by sight or touch. In no case will paint be applied to surfaces upon which there is visible frost, ice, or dew. While painting is being accomplished, the temperature of the surface being painted and of the atmosphere in contact there with shall be at or above 50° Fahrenheit (50F) for water-thinned coatings, and 45° Fahrenheit (45F) for all other coatings. During periods of inclement weather, painting may be continued by enclosing the surfaces with temporary shelters and applying heat, provided the temperature requirements prescribed above are maintained. Unvented combustion type heaters will not be permitted. Painting will not be done when the temperature exceeds 90°.
- E. Time between Surface Preparation and Painting. Surfaces that have been cleaned, pretreated, and/or otherwise prepared for painting shall be given a coat of the specified first coat material as soon as practical after such preparation has been completed, but in any event, prior to any deterioration of the prepared surfaces.
- F. Method of Paint Application.
- | | | |
|---|-------------------|-------------------------------|
| 1 | Stucco | Spray and back roll each coat |
| 2 | Metal Doors | Brush and roll |
| 3 | Corrugated Metals | Spray |
| 4 | Painted Metals | Brush, Roll and Spray |

5	Unpainted Metals	Brush, Roll and Spray
6	Exterior Wood	Brush, Roll and Spray
7	Baseball Backstops	Spray and back roll each coat
8	A/C Units (<i>Misc. Roof Metals</i>)	Brush, Roll and Spray
9	Unpainted Block	Spray
10	Parking Stalls, Curbs	Brush, Roll and Spray
11	Aluminum	Keep clean
12	Metal Canopies	Spray
13	Coping	Brush and Roll
14	Door and Window Frames	Brush only
15	Metal Container	Spray

2.08 MISCELLANEOUS:

The installation of removed items shall be completed immediately following the finishing of each surface and shall be reinstalled by work people skilled in the trade involved. All numbers, signs, and miscellaneous hardware will be reinstalled as soon as the paint surface is completely dry.

2.09 MAINTENANCE MATERIAL:

Upon completion of work, one gallon of each new color and paint type used shall be turned over to the District inspector.

2.10 GUARANTEE:

- A. All work shall be guaranteed against defective or improper materials, equipment, workmanship, and installation for a period of one (1) year from the date of final acceptance. Said guarantee shall be in writing and transmitted to the District's Purchasing Office.

2.10 GUARANTEE: (Cont.)

- C. Any defects noted during the guarantee period shall be replaced within 14 days of written notice of defects. All costs including labor and materials, resulting from correction of defect shall be borne by the Contractor

TECHNICAL SPECIFICATIONS

FOR

Maple Creek Elementary

MAPLE CREEK ELEMENTARY

2025 E Teague Ave
Fresno ca 93720

CLOVIS UNIFIED SCHOOL DISTRICT
1450 HERNDON AVENUE
CLOVIS, CA. 93611

GENERAL

Maple Creek (2023) - CUSD

1.01 SCOPE OF WORK:

- A. A pre-job conference will be held prior to the start of the project. At that time the paint specifications will be presented and understood by the job foreman. Any questions are to be addressed at that meeting.
- B. The work to be done consist of providing and furnishing all labor, materials, equipment, tools, services, and incidentals necessary to prepare, paint and refinish the outside and exterior surface of the site buildings listed in the attached bid. The exterior of Clovis Unified School District buildings are to be painted on exposed surfaces shown in District specs. Painting will start only when a sample patch is completed. This will be standard of project; no paint will be applied until sample wall has been approved by C.U.S.D. Work to be performed in strict accordance with these specifications. All work will be corrected which does not comply with the intent of these specifications.
- C. Each item or area in these specifications is described by the most commonly used name and the contractor will inform himself and his employees of the areas that are to be painted. Areas to be painted will be gone over very clearly at the job walk through, including materials and surfaces to be designated.
- D. The school district reserves the right to award the painting work to any contractor as its best interest may appear or reject any or all for any reason.
- E. All lead-based paint surface preparation and paint stabilization shall be performed by California Department of Health Services (DHS) certified personnel. All lead waste shall be properly stored onsite and characterized for disposal. Based on characterization results, hazardous waste shall be handled by a licensed hazardous waste transporter. Disposal must be in accordance with all applicable federal, state and local regulations.

Contractor must provide a DHS Certified Project Monitor or Inspector/Assessor responsible for overseeing the job until the surface preparation process is complete.

Exterior lead preparation work may not be done during normal business hours when school is in session.

F. REGULATIONS:

The contractor shall assume full responsibility and liability for the compliance with all applicable Federal, State, and local regulations pertaining to work practices, hauling, disposal, and protection of workers, visitors to the site, persons, and subcontractors occupying areas adjacent to the site. The contractor is responsible for providing medical examinations and maintaining medical records of personnel as required by the applicable Federal, State, and local regulations. The contractor shall hold the District harmless for failure to comply with any applicable work, hauling, disposal, safety, health or other regulation on the part of himself, his employees, or his subcontractors.

Federal Requirements, which govern, lead work or hauling and disposal of lead containing waste materials include, but are not limited to the following:

A. U.S. Department of Labor, Occupational Safety and Health Administration, (OSHA), including but not limited to:

1. Construction Industry
Title 29, Part 1926 of the
Code of Federal Regulations
2. Respiratory Protection
Title 29, Part 1910, Section 134 of the
Code of Federal Regulations
3. Access to Employee Exposure and Medical Records
Title 29, Part 1910, Section 2 of the
Code of Federal Regulations
4. Hazard Communication
Title 29, Part 1910, Section 1200 of the
Code of Federal Regulations

B. California Occupational Safety and Health Administration, (Cal/OSHA), including but not limited to:

1. Title 8 CCR Section 1532 .1
Construction Safety Orders, Lead

C. California Department of Health Services

1. Title 17 CCR Division 1, Chapter 8
Accreditation, Certification, and Work Practices for
Lead-Based Paint and Lead Hazards

F. REGULATIONS: (Cont.)

D. State and Federal Regulations, which govern lead waste hauling, and disposal of lead containing waste materials include but are not limited to the following:

1. Title 40-Parts 262 & 263 of the Code of Federal Regulations
2. Title 22-Code of California Regulations Division 4, Chapter 30

E. DOT: US Department of Transportation Hazardous Substances

1. Title 49, Part 171 and 172 of the Code of Federal Regulations
2. Contractor shall abide by all local requirements, which govern hauling, and disposal of lead containing waste material.

G. SUBMITTALS:

Within ten (10) days of award and prior to the start of work, each contractor or sub-contractor that performs manual demolition, sanding, scraping, abrasive blasting, heat gun applications, welding, or torch cutting of any building construction material that has been identified to contain lead based paint, shall submit the following to the general contractor and the District's Maintenance Manager, 1490 Herndon Ave., Clovis, CA 93611.

1. A diagram for each work area indicating the work site preparation and locations of barriers, decontamination units or hand washing stations.
2. A copy of the contractor's health and safety (SB 198) program for lead paint.
3. A copy of the contractor's respiratory protection program.
4. Medical approval for respirators for each worker.
5. Recent (within 6 months) Lab Certified Lead-in-Blood Level Test Results.

G. SUBMITTALS: (Cont.)

6. A Current training certificate for each worker (24 hour) and supervisor (40 hour) on site.
7. Certificates of Worker Acknowledgement for each worker. Sample attached.
8. Written Cal/OSHA compliance program for the project including:
 - a. A description of each activity in which lead is emitted; e.g., equipment used, material involved, controls in place, employee job responsibilities, operation procedures, and maintenance practices.
 - b. Air monitoring data, which document the source of lead emissions.
 - c. A description of arrangements made among contractors on multi-contractor sites with respect to informing affected employees of potential exposure to lead and with respect to responsibility for compliance with this section.
 - d. Provisions for frequent and regular inspections of the job site, materials, equipment and housekeeping to be made by a DHS Certified Project Monitor or Inspector/Assessor.
9. A letter from contractor provided DHS Certified Project Monitor or Inspector/Assessor, providing their certification number and a statement confirming that they will oversee and monitor the lead surface preparation stage of the contract to ensure compliance with the bid specification and all applicable laws and regulations.

H. WORK PRACTICES:

This procedure shall apply only to projects involving lead paint surface preparation. No exterior lead paint surface preparation, scraping, sanding, etc., will be allowed during regular business hours, when school is in session, on the exterior of the building(s). Suitable times must be worked out with the District at least twenty-four (24) hours in advance to allow for scheduling of inspector and/or the District at least twenty-four (24) hours in advance to allow for scheduling of inspector and/or caretaker to be on site.

Overtime for District personnel will be District responsibility for lead preparation work only.

Interior lead surface preparation work shall be coordinated with other contractors and/or the district to ensure the paint contractor's exclusive access to the work area.

All workers shall be fully trained and certified to work with Lead Based Paint (LAP). Training must be conducted in accordance with Title 17 CAR, Section 35065, Article 7, Lead-Related Construction Work Course.

The following practices shall be followed unless it is verified that the paint is lead free.

Section 1: Personal Protective Equipment

1. Employees shall wear HEPA filter (magenta/purple) equipped half mask or full faced respirators. Employees shall be medically approved and trained to wear respirators.

1.02 SPECIAL CONDITIONS:

- A. Due to the nature of the work, it is strongly recommend that all Contractors bidding on the work visit the site in order that they have full knowledge of all difficulties affecting the work which may not be particularly described herein. The Contractor shall make allowances for the fact that adjacent buildings, students and faculty may use corridors, and their activities will not be adversely interrupted.
- B. The walk-through is to inspect buildings for estimating needs; size, height, surface type, and general knowledge of the scope of the project. The conference will also be for the purpose of inspecting the job sites and to determine the interpretation and specifications for bidding projects. If you don't attend both conferences and walk-through of sites, this will not be a justification to exclude or change any part or work due to these specifications. Any walk-through will be done by the Job Site Inspector.

1.03 CARE OF EXISTING STRUCTURES:

The Contractor shall be liable for all damage done to any structure arising through his operations. Contractor shall repair all damage done to any of the structures through his acts or neglect and shall leave said structures in as good condition as they were prior to the commencement of the work.

1.04 MATERIAL AND WORKMANSHIP

- A. The Contractor shall make the application in a neat and workmanlike manner and be responsible for leaving the area free of debris at completion of each days work.
- B. Application of all materials will be in accordance with the material manufacturer's recommendation and instructions, unless otherwise noted in these specifications, or on the job inspector.
- C. The Contractor shall provide signs informing personnel and students of work in progress, newly painted surfaces and provide other working warning signs as required.
- D. The Contractor will not store flammable materials inside buildings.
- E. The Contractor will mix paint in a location and manner that will protect the environment and facilities.
- F. The Contractor will provide ventilation needed to comply with OSHA, DHS, local or state agency requirements and safety regulations.
- G. The Contractor will provide a portable storage container for his equipment and materials. If flammable materials are stored in his container, the container will be located no closer than 50 feet of any structure and will be plainly marked "FLAMMABLE-KEEP AWAY". The location of said container will be coordinated with and designated by the on-job inspector or District.

1.05 COORDINATION OF WORK:

The Contractor will coordinate all aspects of the work with the on-site District Inspector.

1.06 APPLICABLE STANDARDS:

- A. Uniform Building Code, 1988
- B. OSHA Standards
- C. National Fire Codes (NFC), 1988
- D. Painting and Decorating Contractor of America (PDCA), "Modern Guide to Paint Specifications"
- E. Clovis Unified School District Standards supersedes all others.
- F. All products will comply with the requirements of California Air Resource Board (CARB) and the Environmental Protection Agency (EPA) and OSHA rulings governing the use of applied paint coatings.

1.07 COLOR SELECTION/APPROVAL:

Within five (5) days after receipt of Notice to Proceed and before applying any paint or finish material, the Contractor shall submit to the Plant Operations Department a six (6) inch square sample of each color of each type of paint (latex, enamel, etc.) to be used. The colors desired will be selected from the manufacturer's standard color selection charts, furnished by the Contractor or the District Office. The sample color squares will be given to the on-site inspector.

1.08 CONTRACTOR'S ACCESS TO WORK:

Contractor's vehicles may enter the school property and use any driveways and paved access roads available, however, utmost safety precautions must be observed at all times while driving on and/or around the school grounds. Contractor's employees may park their private vehicles in designated school parking lots or on public streets. Parking of private vehicles on the school grounds adjacent to buildings will not be allowed.

1.09 PRESERVATION:

Floors, furnishings, equipment, finish hardware, name of information plates, dials, gauges, tile, or other such surfaces not requiring job painting shall be protected from spotting, spillage, or damage of any kind. Should any of these surfaces be damaged, they shall be cleaned, repaired, or replaced as directed.

Hardware, fixture canopies, outlet covers, switch plates, and/or other similar items shall be removed, loosened, or masked as required for painting work and then replaced.

Equipment adjacent to walls shall be disconnected by workman skilled in these trades and moved to permit the wall surfaces to be painted, and following completion of painting shall then be replaced and reconnected.

1.10 MATERIALS:

All paint material shall be of best quality as manufactured by a leading manufacturer such as Sherwin Williams, Dunn Edwards, Kelly Moore, PPG, or approved by Los Angeles City Board of Education or equal.

The products listed are as manufactured by the Frazee Company unless otherwise specified. Equal products by others may be used only by submitting product list and substantiating technical information of products proposed for approval before bid opening.

All materials proposed for use shall be delivered to the site in original Containers, seals unbroken, stored where directed, and none shall be used until approved by the on-site District inspector. Materials not approved must be taken for testing where deemed necessary. Cost of testing will not be charged to the Contractor unless material tested fails to meet requirements. Cost for testing which fails to meet requirements will be charged against the Contractor. All materials used will have a ten-year labor and material guarantee issued by paint manufacture.

1.10 MATERIAL

<u>FINISH NO.</u>		<u>EXTERIOR MATERIAL</u>	
1	STUCCO, Concrete, Block, plaster, <i>(Previously painted)</i>	<u>1st Coat:</u> <u>2nd Coat:</u> <u>3rd Coat:</u>	#168 Prime Plus #A84 Super Paint Gloss #A84 Super Paint Gloss
2	METAL DOORS, DOOR & WINDOW FRAMES <i>(Doors & door frames: Interior & exterior)</i>	<u>1st Coat:</u> <u>2nd Coat:</u> <u>3rd Coat:</u>	#B66 Pro-Cryl #B66-650 Pro Industrial 100% Acrylic #B66-650 Pro Industrial 100% Acrylic
3	CORRUGATED METAL <i>(Siding & Canopy's)</i>	<u>1st Coat:</u> <u>2nd Coat:</u> <u>3rd Coat:</u>	#B66 Pro-Cryl #A84 Super Paint Gloss #A84 Super Paint Gloss
4	MISCELLANEOUS METALS <i>(Previously finished) (Gates, fences, shade structures)</i>	<u>1st Coat:</u> <u>2nd Coat:</u> <u>3rd Coat:</u>	#B66 Pro-Cryl #B66-650 Pro Industrial 100% Acrylic #B66-650 Pro Industrial 100% Acrylic
5	MISCELLANEOUS METALS <i>(Unfinished) (Conduit, downspouts, electrical Panels)</i>	<u>1st Coat:</u> <u>2nd Coat:</u> <u>3rd Coat:</u>	#B66 Pro-Cryl #A84 Super Paint Gloss #A84 Super Paint Gloss
6	ALL EXTERIOR WOOD, <i>(Siding, soffits, doors & trim) (Doors & door frames: interior & exterior)</i>	<u>1st Coat:</u> <u>2nd Coat:</u> <u>3rd Coat:</u>	#168 Prime Plus #A84 Super Paint Gloss #A84 Super Paint Gloss
7	BASEBALL BACKSTOPS	<u>1st Coat:</u> <u>2nd Coat:</u> <u>3rd Coat:</u>	#168 Prime Plus A89-Series super paint Satin A89-Series super paint Satin
8	A/C UNITS, vents, roof jacks	<u>1st Coat:</u> <u>2nd Coat:</u> <u>3rd Coat:</u>	#B66 Pro-Cryl #A84 Super Paint Gloss #A84 Super Paint Gloss

9 ALL UNPAINTED BLOCK

1st Coat: Seal Krete

Note: 1- *Miscellaneous Metals (#4,#7)) shall be prepped and spot primed with #215969 Rust-Oleum oil based metal primer prior to full coat system*

Note: 2 *All school signs and classroom numbers will be installed or repainted by contractor and will be designated by the on - site inspector or District Representative.*

10 PARKING LINES

Arrows, Basketball and
Volleyball courts, play areas, games,
Safety door circles and curbs

Traffic Paint:

White-Fast Dry TP 6101

Red-Fast Dry TP 1401

Blue-Fast Dry TP 1501

Yellow-Fast Dry TP 6201

Black-Fast Dry TP 6301

Green-Fast Dry TP 1601

Orange-Fast Dry

(Use Sherwin-Williams

Knockout Orange TM 2153

FC 18-366)

International Coatings

Purchase – STATEWIDE

3049 s. Golden State Frontage Rd.

Fresno, CA 93725

(559)291-8500

1.11 PAINT SCHEDULE:

<u>FINISH NO.</u>	<u>EXTERIOR MATERIAL</u>
1.	Exterior stucco, plaster, block and brick.
2.	Metal doors, door and window frames. <i>(Doors & door frames, interior & exterior)</i>
3.	Corrugated metal
4.	Canopy supports, roof cap, metal gates and fences, Handrails, gutters, downspouts, electrical boxes, Pipes, conduit, ladders, basketball backboards Light poles, sea trains, <i>(all other painted metals not listed)</i>
5.	New conduit, gutters, downspouts, electrical panels <i>(All unpainted or shop primed metals not listed)</i> <i>(Aluminum & stainless steel, no service)</i>
6.	Portables, soffits, doors <i>(All other wood not listed)</i>
7.	Baseball backstops
8.	A/C units on roof
9.	All Unpainted Block <i>(Attached to buildings)</i>
10	Parking lines, arrows, written directions, games, curbs

These specifications are designed to cover all surfaces that are painted at Clovis Unified School District schools. If by chance any surfaces have been left out, there are sufficient material systems to cover any and all areas that are not listed. (See job-site inspector if this should happen for surface systems.)

SECTION 2

2.01 DESCRIPTION AND SCOPE:

The work includes surface preparation, application of necessary primer, and finished coats of paint to doors, windows, trim, flashings, eaves, and other associated items. This work includes the painting of all exterior areas and connecting corridors. Doors will be painted on both sides and shall be done by experienced skilled craftsman.

2.02 PAINT:

The term "paint" as used herein includes emulsions, enamels, epoxies, oil and water base paints, filler and sealers, whether prime, second, or final coat, and whether used on wood, metal, stucco, or masonry surfaces. It also includes stains, varnishes, and heavy bodies texture coatings including roof coating when specified.

2.03 CLEANING, PREPARATION, AND PRETREATMENT OF SURFACES:

- A. General. All surfaces shall be prepared in a skillful manner to produce finish work of first class appearance and durability. Hardware, hardware accessories, machined surfaces, plated, lighting fixtures, and similar items in contact with surfaces to be painted shall be removed, masked or otherwise protected prior to surface preparation and painting operations. Surfaces to be painted shall be cleaned before applying paint or otherwise protected prior to surface preparation and painting operations. Cleaning and painting shall be so programmed that dust and other contaminates from the cleaning process will not fall on wet, newly painted

surfaces. Feather edged sanding will be required where the old surfacing has been removed and the immediate adjacent area has sharp or raised edges.

- B. All exposed mastic, concrete, stucco and/or plaster surfaces shall be thoroughly cleaned with approved cleaner, using Hydro-Cleaning equipment, to thoroughly remove all dirt, loose particles, water base paint, foreign materials, grease and oil, then rinsed with clean water to remove all residue. Efflorescence shall be brushed off the surface neutralized with a strong solution of Muriatic Acid and K-14 tetrapotassium-antypyrphosphate and then thoroughly rinsed with clean water or other approved methods. All dryvit surfaces must patched with dryvit materials not stucco patch.

2.03 CLEANING, PREPARATION, AND PRETREATMENT OR SURFACES (Cont.)

Before any cleaning of water blasting operation is started, the soil at the base of the building shall be trenched to a depth of six inches and eight inches wide. After completing the painting application, allowing sufficient drying time, the trench shall be refilled. All areas where the finish plaster coat is loose shall have the portion removed to a solid surface. All surfaces that are broken, cracked, or damaged, and areas where the finish plaster coat has been removed, shall be coated with Weld-Crete as manufactured by Larsen Products Corporation or equal, then shall be given a cement plaster finish coat consisting of one-part Portland Cement to here parts sand to match the existing finish. All cracks shall be "V-ee'd" out, filled, finished flush with, and of texture to match the adionina surface.

All caulking, which will interfere with the proper application of the waterproof coating, shall be removed. Caulk around door and window frames, flashing, vents, etc., with a caulking compound recommended by the manufacturer of the coating to be used. Caulking and filling to be done with sufficient pressure to for the material to the base of the opening.

- C. Wood Surfaces. Other than surfaces to be given a natural finish, wood surfaces shall be primed and finish coated as specified herein. Wood surfaces to be painted shall be cleaned of dirt, oil and other foreign substances with mineral spirits, scraper and sandpaper. The surface shall be checked thoroughly to ensure all finishing nails have been properly set; then all holes and surface imperfections shall be patched and primed. Laminated beams, knotholes, cracks and all imperfections shall be filled with appropriate material, primed and finished.

- D. Concrete/Masonry Surfaces. Concrete, stucco, Dryvit system, block and masonry surfaces to be painted shall be prepared by removing chalk, loose paint, dirt, dust, grease, oil and other foreign matter. All holes and cracks in the surface wall will be repaired using an approved patching compound for the size of patch required. Star stucco patching compound is the acceptable standard. It shall be applied to the crack only (not to the sides of the crack). Extreme care shall be used to keep patching material off of sides of the crack.
- E. Galvanized Metal Surfaces. Surfaces to be painted shall be prepared by removing all loose paint, dirt, dust, oil, grease and other foreign matter. The surface will be prewashed, galvawashed, then coated with #168 prime plus.

2.03 CLEANING, PREPARATION, AND PRETREATMENT OR SURFACES
(Cont.)

- F. Ferrous Metal Surfaces. Doors and frames, steel columns and the like, shall be washed with Tri-Sodium Phosphate of equal parts and rinsed to remove all greases, fill all holes and dents with an approved material that appears on the surface of interior and exterior of doors and metal trim then sand and feather edged and primed with #C309 Ultra Tech.
- G. Sash Windows. All loose and deteriorated glazing compounds will be removed and replaced with an approved glazing compound prior to painting.
- H. Stucco, Fascia, Buildings. Mildew accumulation of building will be removed by using a mildew stain remover such as X-14 as manufactured by White Laboratories, Inc. This application will be prior to the water blasting operation.
- I. Sandblasting.
1. On surfaces requiring sandblasting the following shall be done:
 - a. Scaffolding where necessary shall be provided and installed by the painting contractor. It shall be installed so as not to interfere with the opening of exit doors of the buildings and so that all entrances may be used at all times.
 - b. Sandblaster shall protect all wood, metal, and glass surfaces from the sandblasting work. Sandblasting contractor will be held fully responsible for any damage done to School District buildings and

property and shall replace or repair to School District's satisfaction any damage that might be done as a result of sandblasting work.

- c. Sandblasting contractor will be held responsible for cleaning up all dust which sifts inside buildings or into adjacent rooms as well as for cleaning up the dust and debris resulting from his work and removing same from site, and for all damage done to buildings or equipment.
- d. Sandblasting will not be permitted on a Sunday unless written permission is received from School District

2.03 CLEANING, PREPARATION, AND PRETREATMENT OF SURFACES
(Cont.)

- e. Only sharp, dry sand of proper grading to give satisfactory results shall be used, as required by Air Quality Management District.
 - f. All machinery, equipment, etc., which might be damaged by sandblasting, and floor drains shall be sealed against entry of sand dust before sandblasting begins.
 - g. Dirt shall be excavated to a depth of five inches (5") below ground line and surfaces sandblasted to this point. All sand is to be removed from this trench to permit painting to this point.
 - h. Priming coat of paint shall be applied on metal surfaces that same day that sandblasting is done.
2. If cleaned surfaces rust before painting is accomplished, they shall be re-sandblasted at the painting contractor's expense.

2.04 CLEANING GLASS:

Upon completion of all painting work, all exterior glass surfaces shall be cleaned where paint and foreign materials have been left on glass.

2.05 CLEANING:

All cloths and cotton waste, which might constitute a fire hazard, shall be placed in a closed metal container or destroyed at the end of every

workday. Upon completion of the work, all staging, scaffolding and containers shall be removed from the jobsite. On the last day of the workweek: pickup paper, plastic, tape and miscellaneous garbage on job-site.

2.06 WORKMANSHIP:

All work shall be done by painters and finishers of established status and reputation for executing their work by the very best methods for each kind of work. Strict adherence to the specifications and the recommendations of the manufacturer whose materials are used shall be followed in the application.

2.07 PAINT APPLICATION:

- A. General. The finished painted surfaces shall be free from runs, drops, ridges, waves, laps, brush marks, and variations in color, texture, and finish. The contractor will be totally responsible for color variation on all materials brought to the jobsite and used on site. The mixing shall be completed and each shall be applied so as to produce a film or uniform thickness. Special attention shall be given to ensure that all surfaces including edges, corners, crevices, welds, and fasteners receive a film thickness equivalent to that of adjacent painted surfaces. Adjacent areas and installations shall be protected by the use of drop cloths or other approved coverings. The contractor shall be liable for all damage caused to personnel, equipment, or facilities by over spray from painting operations where adequate protection was not provided.
- B. Coating Progress. Sufficient time shall elapse between successive coats to permit proper drying. This period shall be modified as necessary to suite adverse weather conditions. Paint shall be considered dry for recoating when the paint feels firm, does not deform or feel tacky under moderate pressure of the thumb, and the application of another coat of paint does not cause lifting or loss of adhesion of the undercoat or manufacturer specifications. Each coat shall be inspected and approved before proceeding with further coats. If a coat has not been inspected, the surface shall be recoated at the contractor's expense.
- C. Storage, Mixing, and Thinning. At the time of application, paint shall show no signs deterioration. Emulsion paints shall be protected from exposure to cold weather by storing in shelter so as to prevent freezing. Paint shall be thoroughly stirred, strained, and kept at a uniform consistency during application. Paints of different manufactures shall not be mixed together. Where necessary to suit conditions of surface, temperature, weathers, and method of application, packaged paint may be thinned immediately prior to

application in accordance with the manufacturer's instructions, but not in excess of one (1) pint of suitable thinner per gallon. The use of thinner shall not relieve the contractor from obtaining complete coverage without holidays.

2.07 PAINT APPLICATION: (Cont.)

- D. Atmospheric Conditions. Paints other than water-thinned coatings shall be applied only to surfaces that are completely free of surface moisture as determined by sight or touch. In no case will paint be applied to surfaces upon which there is visible frost, ice, or dew. While painting is being accomplished, the temperature of the surface being painted and of the atmosphere in contact there with shall be at or above 50° Fahrenheit (50F) for water-thinned coatings, and 45° Fahrenheit (45F) for all other coatings. During periods of inclement weather, painting may be continued by enclosing the surfaces with temporary shelters and applying heat, provided the temperature requirements prescribed above are maintained. Unvented combustion type heaters will not be permitted. Painting will not be done when the temperature exceeds 90°.
- E. Time between Surface Preparation and Painting. Surfaces that have been cleaned, pretreated, and/or otherwise prepared for painting shall be given a coat of the specified first coat material as soon as practical after such preparation has been completed, but in any event, prior to any deterioration of the prepared surfaces.
- F. Method of Paint Application.
- | | | |
|---|-------------------|-------------------------------|
| 1 | Stucco | Spray and back roll each coat |
| 2 | Metal Doors | Brush and roll |
| 3 | Corrugated Metals | Spray |
| 4 | Painted Metals | Brush, Roll and Spray |
| 5 | Unpainted Metals | Brush, Roll and Spray |

6	Exterior Wood	Brush, Roll and Spray
7	Baseball Backstops	Spray and back roll each coat
8	A/C Units (<i>Misc. Roof Metals</i>)	Brush, Roll and Spray
9	Unpainted Block	Spray
10	Parking Stalls, Curbs	Brush, Roll and Spray
11	Aluminum	Keep clean
12	Metal Canopies	Spray
13	Coping	Brush and Roll
14	Door and Window Frames	Brush only
15	Metal Container	Spray

2.08 MISCELLANEOUS:

The installation of removed items shall be completed immediately following the finishing of each surface and shall be reinstalled by work people skilled in the trade involved. All numbers, signs, and miscellaneous hardware will be reinstalled as soon as the paint surface is completely dry.

2.09 MAINTENANCE MATERIAL:

Upon completion of work, one gallon of each new color and paint type used shall be turned over to the District inspector.

2.10 GUARANTEE:

A. All work shall be guaranteed against defective or improper materials, equipment, workmanship, and installation for a period of one (1) year from the date of final acceptance. Said guarantee shall be in writing and transmitted to the District's Purchasing Office.

2.10 GUARANTEE: (Cont.)

- C. Any defects noted during the guarantee period shall be replaced within 14 days of written notice of defects. All costs including labor and materials, resulting from correction of defect shall be borne by the Contractor