

CLOVIS UNIFIED SCHOOL DISTRICT

EIMEAR O'BRIEN, ED. D., DISTRICT SUPERINTENDENT

PLANS FOR THE CONSTRUCTION OF 2022 PARKING LOT AND PLAYCOURT REHABILITATION IMPROVEMENTS AT COMMUNITY DAY SCHOOL

IDENTIFICATION STAMP
DIV. OF THE STATE ARCHITECT
APP: 02-119790 INC:
REVIEWED FOR
SS FLS ACS
DATE: 04/06/2022

FOR DSA USE ONLY
APP # 02-119790

GENERAL SITE NOTES:

THE REQUIREMENTS AND INFORMATION SET OUT BELOW ARE PROVIDED FOR THE CONTRACTOR'S CONVENIENCE AND DO NOT ENCOMPASS ALL PROJECT REQUIREMENTS DESCRIBED BY THE PROJECT PLANS AND SPECIFICATIONS AND/OR APPLICABLE LAWS, REGULATIONS AND/OR BUILDING CODES.

- CONSTRUCTION OF ALL PROJECT SITE IMPROVEMENTS SUBJECT TO ADA ACCESS COMPLIANCE, INCLUDING ACCESSIBLE PATH OF TRAVEL, CURB RETURNS, PARKING STALL(S) AND UNLOADING AREAS, BARRIER FREE AMENITIES AND/OR OTHER APPLICABLE SITE IMPROVEMENTS SHALL CONFORM TO THE AMERICANS WITH DISABILITIES ACT, CALIFORNIA TITLE 24, AND THE CALIFORNIA BUILDING CODE, CURRENT EDITION(S).
- CONTRACTOR SHALL FIELD VERIFY ALL GRADES AND SLOPES PRIOR TO THE PLACEMENT OF CONCRETE AND/OR PAVEMENT FOR CONFORMANCE WITH ADA ACCESS COMPLIANCE REQUIREMENTS. EXAMPLES OF MINIMUM AND MAXIMUM LIMITS RELATED TO ADA ACCESS COMPLIANCE INCLUDE, BUT ARE NOT LIMITED TO:
 - ACCESSIBLE PATH OF TRAVEL CROSS-SLOPE SHALL NOT EXCEED 2%
 - ACCESSIBLE PATH OF TRAVEL LONGITUDINAL SLOPES SHALL NOT EXCEED 5%
 - RAMP LONGITUDINAL SLOPES SHALL NOT EXCEED 8.33%
 - WALKS SHALL NOT HAVE LESS THAN 48 INCHES IN UNOBSTRUCTED WIDTH
 - ACCESSIBLE PARKING SPACES AND ACCESS AISLES SHALL NOT EXCEED 2% SLOPE IN ANY DIRECTION
 - LANDINGS AT THE TOP AND BOTTOM OF ACCESSIBLE RAMPS SHALL NOT EXCEED 2% SLOPE IN ANY DIRECTION
 - GUTTERS AND ROAD SURFACES DIRECTLY ADJACENT TO AND WITHIN 2 FEET OF A CURB RAMP SHALL HAVE A COUNTER SLOPE NOT TO EXCEED 5%
- CONTRACTOR MUST IMMEDIATELY NOTIFY THE ENGINEER OF RECORD, IDENTIFIED BY THE PROFESSIONAL ENGINEERING SEAL AND SIGNATURE ON THESE PLANS, OF ANY SITE CONDITION(S) AND/OR DESIGN INFORMATION THAT PREVENTS THE CONTRACTOR FROM COMPLYING WITH THE LAWS, REGULATIONS AND/OR BUILDING CODES GOVERNING ADA ACCESS COMPLIANCE.
- DRAINAGE SHALL NOT BE ALLOWED ONTO ADJACENT PROPERTY.
- ALL FILL MATERIAL USED SHALL BE PLACED IN COMPLIANCE WITH THE PROJECT SPECIFICATIONS. A SOILS COMPACTION REPORT SHALL BE SUBMITTED TO THE ENGINEER OF RECORD AS REQUIRED BY THE PROJECT SPECIFICATIONS.
- THE CONTRACTOR SHALL IMPLEMENT DUST CONTROL MEASURES AS REQUIRED BY THE PROJECT SPECIFICATIONS, AND BY GOVERNING PUBLIC AGENCIES.
- THE CONTRACTOR SHALL LOCATE ALL EXISTING UTILITIES PRIOR TO START OF ANY WORK.
- CONTRACTOR SHALL NOTIFY THE SCHOOL DISTRICT TO TURN OFF IRRIGATION A MINIMUM OF 2 DAYS PRIOR TO STARTING WORK. CONTRACTOR SHALL COORDINATE WITH THE SCHOOL DISTRICT THROUGHOUT THE COURSE OF THE PROJECT FOR WATERING AND NON-WATERING TIMES. CONTRACTOR SHALL NOTIFY THE DISTRICT AS SOON AS WORK IS COMPLETED TO THE POINT WHERE IRRIGATION SYSTEMS MAY BE TURNED BACK ON.
- ENSURE THAT ALL EXISTING STRIPING IS NOT VISIBLE AFTER APPLYING SEAL COAT AND PRIOR TO RESTRIPING AND REPAINTING. OTHERWISE, ADDITIONAL SEAL COAT APPLICATION MAY BE REQUIRED.
- PRIOR TO ACCEPTANCE OF NEW PAVING AND APPLICATION OF SEAL COAT AND/OR STRIPING, THE CONTRACTOR SHALL COMPLETE A WATER TEST OF THE NEW PAVEMENT WITH THE ENGINEER OF RECORD PRESENT TO VERIFY THAT NO LOW SPOTS OR "BIRD BATHS" ARE PRESENT, PER THE PROJECT SPECIFICATIONS.
- LAYOUT ALL PAVEMENT MARKINGS TO MATCH EXISTING UNLESS NOTED OTHERWISE ON PLANS.
- PAINT ALL CURBS AND WHEELSTOPS TO MATCH EXISTING WITHIN PROJECT LIMITS, UNLESS SHOWN OTHERWISE ON THE PLANS.
- ALL CONCRETE SHALL HAVE WEAKENED PLANE JOINTS AT 10 FEET OR LESS ON CENTER AND ONE HALF INCH PREMOLDED EXPANSION JOINTS AT 30 FEET OR LESS MINIMUM. MATCH EXISTING SCORE PATTERN DIMENSIONS ON ALL CONCRETE WALKS AND PAVEMENT.
- NO CONCRETE MAY BE Poured UNTIL ALL FORMS AND REINFORCEMENTS HAVE BEEN REVIEWED AND APPROVED BY THE PROJECT INSPECTOR.
- REPLACE ALL DAMAGED TURF AND IRRIGATION FACILITIES RESULTING FROM THE WORK REQUIRED.
- ADJUST ALL UTILITY LIDS TO FINISHED GRADE WITHIN CONSTRUCTION AREA PER DETAIL [E/CDX-1] UNLESS NOTED OTHERWISE. REMOVE AND REPLACE ALL BROKEN OR DAMAGED LIDS AND BOXES. ALL LIDS WITHIN TRAFFIC AREAS SHALL BE TRAFFIC RATED.
- ANY EXISTING UTILITIES AND/OR IMPROVEMENTS WHICH ARE TO REMAIN, THAT BECOME DAMAGED DURING CONSTRUCTION SHALL BE COMPLETELY RESTORED TO THE SATISFACTION OF THE OWNER AND AGENCY HAVING AUTHORITY, AT THE CONTRACTOR'S SOLE EXPENSE.
- ANY EXISTING UTILITIES AND/OR IMPROVEMENTS THAT BECOME DAMAGED DURING CONSTRUCTION SHALL BE COMPLETELY RESTORED TO THE SATISFACTION OF THE OWNER AND AGENCY HAVING AUTHORITY, AT THE CONTRACTOR'S SOLE EXPENSE.
- CONTRACTOR TO MATCH EXISTING PAVEMENT GRADE AT ALL NEW PAVEMENT LOCATIONS UNLESS NOTED OTHERWISE ON THE PLANS.
- ASPHALT CONCRETE REMOVAL AND REPLACEMENT LIMITS SHOWN ARE APPROXIMATE AND ARE BASED ON PAVEMENT CONDITIONS OBSERVED DURING A PRE-DESIGN SITE REVIEW. ADJUST LOCATIONS AND LIMITS AS REQUIRED BY ACTUAL FIELD CONDITIONS OR AS DIRECTED BY THE ENGINEER.
- INSTALL DOWELED CONNECTION AT JOINT OF NEW CONCRETE TO EXISTING CONCRETE PER DETAIL [F/CDX-1]
- TREAT ALL JOINTS BETWEEN EXISTING ASPHALT AND CONCRETE SURFACES PER DETAIL [G/CDX-2]

GENERAL NOTES:

- ALL WORK SHALL BE DONE IN ACCORDANCE WITH THESE CONSTRUCTION DRAWINGS, THE CONTRACT SPECIFICATIONS AND, WHERE APPLICABLE, THE CITY STANDARDS AND THE STATE OF CALIFORNIA STANDARD SPECIFICATIONS.
- THE CONTRACTOR SHALL COORDINATE ALL CONSTRUCTION ACTIVITIES WITH THE SCHOOL DISTRICTS USE OF THE FACILITIES AND OTHER CONTRACTORS WHO MAY BE DOING CONSTRUCTION WITHIN THE PROJECT SITE.
- THE CONTRACTOR SHALL CONTACT DISTRICT OFFICIALS FOR DETERMINATION OF DEPTH AND LOCATION OF UNDERGROUND UTILITIES PRIOR TO EXCAVATION IN THE PROJECT SITE.
- BEFORE COMMENCING WORK, THE CONTRACTOR SHALL NOTIFY ALL UTILITY AUTHORITIES OR UTILITY COMPANIES HAVING POSSIBLE INTEREST IN THE WORK OF THE CONTRACTOR'S INTENTION TO EXCAVATE PROXIMATE TO EXISTING FACILITIES AND THE CONTRACTOR SHALL VERIFY THE LOCATION OF ANY UTILITIES IN THE WORK AREA, NOTIFY U.S.A. AT 1(800) 642-2444, TWO (2) DAYS PRIOR TO EXCAVATION.
- ALL CONSTRUCTION SHALL CONFORM TO THE REQUIREMENTS OF THE MOST CURRENT CALIFORNIA BUILDING CODE (CBC).
- CHANGES TO THE APPROVED DRAWINGS AND SPECIFICATIONS SHALL BE MADE BY ADDENDA OR CONSTRUCTION CHANGE DOCUMENT (CCD) APPROVED BY DSA, AS REQUIRED BY SECTION 4-338, PART 1, TITLE 24, CCR.
- A "DSA CERTIFIED" CLASS 3 PROJECT INSPECTOR EMPLOYED BY THE DISTRICT (OWNER) AND APPROVED BY DSA SHALL PROVIDE CONTINUOUS INSPECTION OF THE WORK. THE DUTIES OF THE INSPECTOR ARE DEFINED IN SECTION 4-342, PART 1, TITLE 24, CCR.
- A DSA-ACCEPTED TESTING LABORATORY DIRECTLY EMPLOYED BY THE DISTRICT (OWNER) SHALL CONDUCT ALL THE REQUIRED TESTS AND INSPECTIONS FOR THE PROJECT.
- THE INTENT OF THESE DRAWINGS AND SPECIFICATIONS IS THAT THE WORK OF THE ALTERATION, REHABILITATION OR RECONSTRUCTION SHALL BE IN ACCORDANCE WITH TITLE 24, CCR. SHOULD ANY EXISTING CONDITIONS SUCH AS DETERIORATION OR NON-COMPLYING CONSTRUCTION BE DISCOVERED WHICH IS NOT COVERED BY THE CONTRACT DOCUMENTS WHEREIN THE FINISHED WORK WILL NOT COMPLY WITH TITLE 24, CCR, A CONSTRUCTION CHANGE DOCUMENT (CCD), OR A SEPARATE SET OF PLANS AND SPECIFICATIONS, DETAILING AND SPECIFYING THE REQUIRED WORK SHALL BE SUBMITTED TO AND APPROVED BY DSA BEFORE PROCEEDING WITH THE WORK (SECTION 4-317(C), PART 1, TITLE 24, CCR).
- GRADING PLANS, DRAINAGE IMPROVEMENTS, ROAD AND EMERGENCY ACCESS REQUIREMENTS AND ENVIRONMENTAL HEALTH CONSIDERATIONS SHALL COMPLY WITH ALL LOCAL ORDINANCES.

GENERAL DEMOLITION NOTES:

- THE "LIMIT OF DEMOLITION" SHOWN IS APPROXIMATE AND IS GENERALLY CONSIDERED TO BE THE MINIMUM REMOVAL REQUIREMENTS. CONTRACTOR MUST COORDINATE AS NOTED IN THE LEGEND.
- CONTRACTOR SHALL LEGALLY DISPOSE OF ALL DEMOLISHED MATERIALS OFF SITE.
- CONTRACTOR SHALL PROTECT ALL EXISTING UTILITY IMPROVEMENTS NOT SPECIFICALLY DESIGNATED FOR REMOVAL.
- CONTRACTOR TO PROTECT AND PRESERVE IN PLACE ANY FOUND SURVEY MONUMENTS. ANY MONUMENTS DISTURBED SHALL BE RESET BY A CALIFORNIA LICENSED SURVEYOR AND THE APPROPRIATE PAPERWORK FILED WITH THE CITY OR COUNTY, AT CONTRACTOR'S EXPENSE.
- ALL HAZARDOUS MATERIALS ENCOUNTERED DURING SITE DEMOLITION SHALL BE REMEDIATED AND DISPOSED OF PER STATE AND EPA REQUIREMENTS.
- REMOVE EXISTING IMPROVEMENTS AS NECESSARY TO CONSTRUCT NEW IMPROVEMENTS SHOWN ON THESE PLANS.
 - FOR CONCRETE REMOVAL, REMOVE TO THE NEXT NEAREST TOOLED JOINT OR EXPANSION JOINT OF IMPROVEMENTS DESIGNATED TO REMAIN.
 - FOR ASPHALTIC PAVEMENT REMOVAL, SAWCUT TO A STRAIGHT, CLEAN EDGE AT LOCATIONS INDICATED ON THE PLANS.
- REMOVE ALL WHEELSTOPS PRIOR TO SEAL COAT APPLICATION.

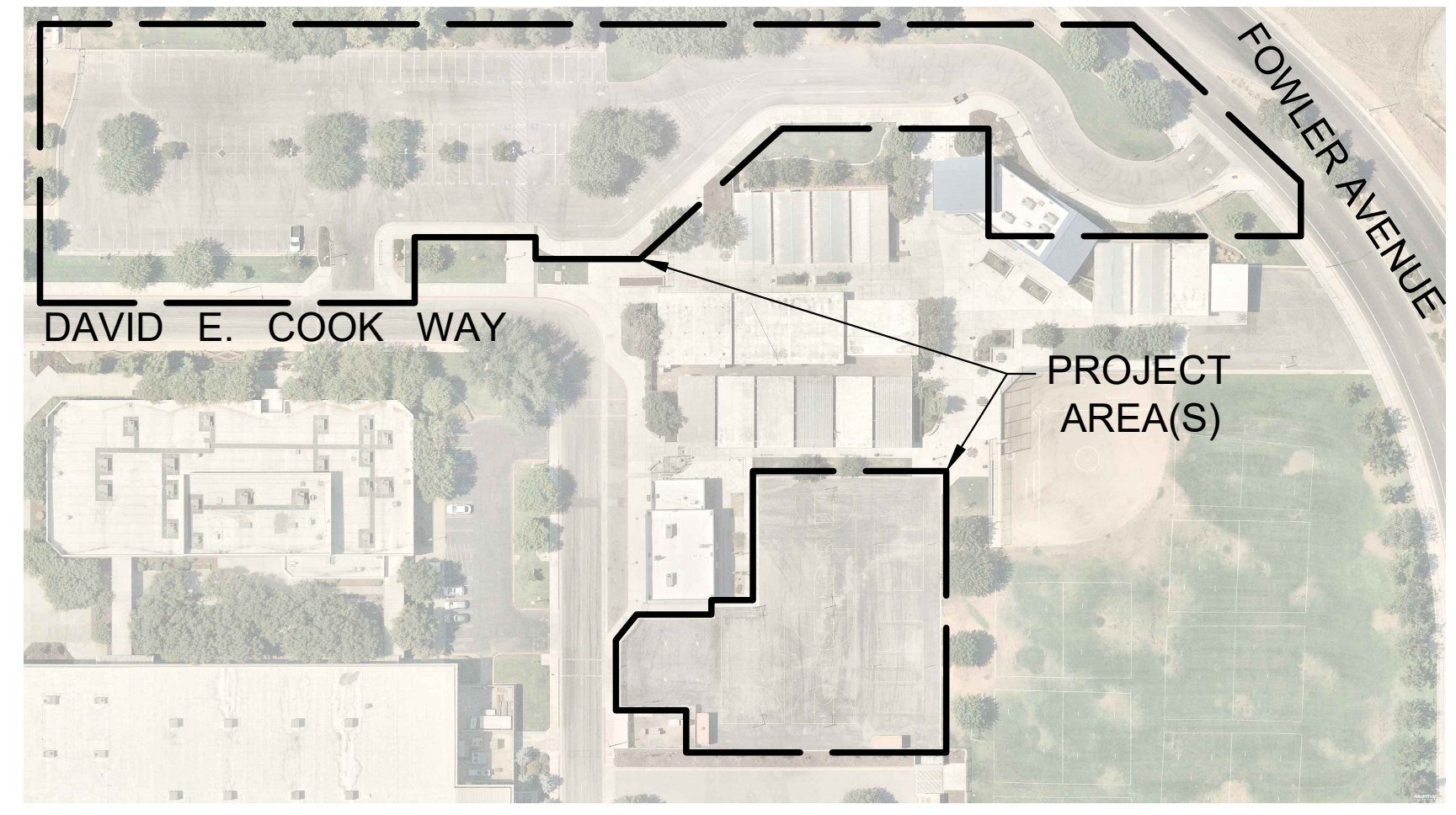

SITE MAP

NOT TO SCALE

SITE ADDRESS

1715 DAVID E COOK WAY,
CLOVIS, CA 93611

PROJECT CONTACTS:

OWNER: CLOVIS UNIFIED SCHOOL DISTRICT
1450 HERNDON AVE
CLOVIS, CA 93611
PHONE: (559) 327-9000

CIVIL ENGINEER: BLAIR, CHURCH & FLYNN
CONSULTING ENGINEERS
455 CLOVIS AVE., SUITE 200
CLOVIS, CA 93612
PHONE: (559) 326-1400

SCOPE OF WORK:

- PARTIAL ASPHALT CONCRETE REMOVAL AND REPLACEMENT, CRACKFILL, SEALCOAT, AND RE-STRIPING EXISTING PARKING LOT AND PLAYCOURT.
- ACCESSIBILITY UPGRADES INCLUDING A NEW FLARED CURB RAMP

APPLICABLE CODES:

2019 CALIFORNIA ADMIN. CODE, TITLE 24, PART 1, CCR
2019 CALIFORNIA BUILDING CODE, TITLE 24, PART 2, CCR

TABLE OF CONTENTS	
SHEET NUMBER	SHEET TITLE
CD-00	COVER SHEET
CD-01	ACCESS COMPLIANCE PLAN
CD-20	DEMOLITION PLAN
CD-21	DEMOLITION PLAN
CD-30	SITE PLAN
CD-31	SITE PLAN
CDX-1	DETAILS
CDX-2	DETAILS
TOTAL SHEET COUNT: 8	

CONTRACTOR AGREES THAT IN ACCORDANCE WITH GENERALLY ACCEPTED CONSTRUCTION PRACTICES CONTRACTOR ASSUMES SOLE AND COMPLETE RESPONSIBILITY FOR JOB SITE CONDITIONS DURING THE PERFORMANCE OF WORK, INCLUDING SAFETY OF ALL PERSONS AND PROPERTY, ON A CONTINUOUS BASIS NOT LIMITED TO NORMAL WORKING HOURS. CONTRACTOR FURTHER AGREES TO DEFEND, INDEMNIFY AND HOLD HARMLESS BLAIR, CHURCH & FLYNN CONSULTING ENGINEERS FROM ANY AND ALL LIABILITY, REAL OR ALLEGED, IN CONNECTION WITH THE PERFORMANCE OF WORK ON THIS PROJECT, EXCEPTING LIABILITY ARISING FROM THE SOLE NEGLIGENCE OF BLAIR, CHURCH & FLYNN CONSULTING ENGINEERS.

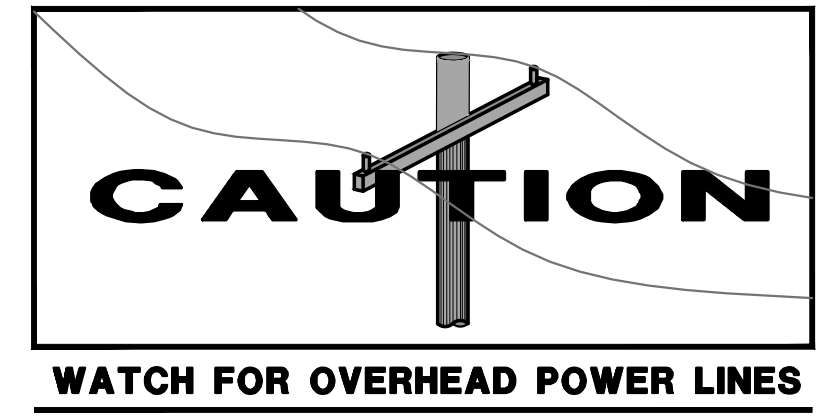

Blair, Church & Flynn
CONSULTING ENGINEERS

Blair, Church & Flynn
Consulting Engineers
455 Clovis Avenue,
Suite 200
Clovis, California 93612
Tel (559) 326-1400
Fax (559) 326-1500

PROFESSIONAL ENGINEER
EIMEAR O'BRIEN
No. 57218
CIVIL
STATE OF CALIFORNIA

CONSULTANT	REF. & REV.	CLOVIS UNIFIED SCHOOL DISTRICT	CONST. DOCUMENTS
Blair, Church & Flynn Consulting Engineers 455 Clovis Avenue, Suite 200 Clovis, California 93612 Tel (559) 326-1400 Fax (559) 326-1500		2022 PAVEMENT REHABILITATION VARIOUS SITES COMMUNITY DAY SCHOOL COVER SHEET	DR. BY: AH CH. BY: JF DATE: 01/21/2022 SCALE AS NOTED CD-00

Blair, Church & Flynn Consulting Engineers, Inc. 02/21/2022, CD_Cover_Sheet.dwg, JF/ahf, 1/25/22

SITE LEGEND:

- LIMITS OF WORK
- ACCESSIBLE PATH OF TRAVEL
- EXISTING ACCESSIBLE PATH OF TRAVEL
- EXISTING ACCESSIBLE UNISEX RESTROOM PER DSA APP # 02-113303
- ACCESSIBLE BOYS RESTROOM PER DSA APP # 02-113303
- ACCESSIBLE GIRL'S RESTROOM PER DSA APP # 02-113303
- EXISTING DRINKING FOUNTAIN PER DSA APP # 02-113303
- ENTRY TOW AWAY SIGN PER THIS APPLICATION
- ACCESSIBLE PARKING STALLS PER THIS APPLICATION
- ACCESSIBLE FLARED CURB RAMP PER THIS APPLICATION
- EXISTING ACCESSIBLE RAMP AND HANDRAIL PER DSA APP # 02-113303
- EXISTING ACCESSIBLE PARKING SIGNAGE PER DSA APP # 02-113303
- EXISTING ACCESSIBLE RESTROOMS

NOTES:

1. DESIGN PROFESSIONAL IN GENERAL RESPONSIBLE CHARGE STATEMENT: THE PATH-OF-TRAVEL (P.O.T.) IDENTIFIED IN THESE CONSTRUCTION DOCUMENTS IS COMPLIANT WITH THE CURRENT APPLICABLE CALIFORNIA BUILDING CODE ACCESSIBILITY PROVISIONS FOR PATH OF TRAVEL REQUIREMENTS FOR ALTERATIONS, ADDITIONS AND STRUCTURAL REPAIRS. AS PART OF THE DESIGN OF THIS PROJECT, THE P.O.T. WAS EXAMINED AND ANY ELEMENTS, COMPONENTS OR PORTIONS OF THE P.O.T. THAT WERE DETERMINED TO BE NON-COMPLIANT 1) HAVE BEEN IDENTIFIED AND 2) THE CORRECTIVE WORK NECESSARY TO BRING THEM INTO COMPLIANCE HAS BEEN INCLUDED WITHIN THE SCOPE OF THIS PROJECT'S WORK THROUGH DETAILS, DRAWINGS, AND SPECIFICATIONS INCORPORATED INTO THESE CONSTRUCTION DOCUMENTS. ANY NON-COMPLIANT ELEMENTS, COMPONENTS OR PORTIONS OF THE P.O.T. THAT WILL NOT BE CORRECTED BY THIS PROJECT BASED ON VALUATION THRESHOLD LIMITATIONS OR A FINDING OF UNREASONABLE HARDSHIP ARE SO INDICATED IN THESE CONSTRUCTION DOCUMENTS.

 DURING CONSTRUCTION, IF P.O.T. ITEMS WITHIN THE SCOPE OF THE PROJECT REPRESENTED AS CODE COMPLIANT ARE FOUND TO BE NON-COMPLYING BEYOND REASONABLE CONSTRUCTION TOLERANCES, THEY SHALL BE BROUGHT INTO COMPLIANCE WITH THE CBC AS A PART OF THIS PROJECT BY MEANS OF A CONSTRUCTION CHANGE DOCUMENT.
2. THE ENGINEER HAS SURVEYED/INSPECTED THE PATH OF TRAVEL (P.O.T.) AS INDICATED ON THE PLANS AND HAS FOUND IT TO BE, OR HAS INDICATED ON THE PLANS REMEDIAL WORK WHICH WOULD CAUSE IT TO BE, A BARRIER FREE ACCESSIBLE ROUTE:
 1. AT LEAST 48" IN WIDTH; OR AS APPROVED BY CODE, WITHOUT ABRUPT LEVEL CHANGES EXCEEDING 1/2" IF BEVELED AT 1:2 MAXIMUM SLOPE, OR VERTICAL LEVEL CHANGES EXCEEDING 1/4".
 2. WITH A FIRM, STABLE, AND SLIP RESISTANT WALKING SURFACE, WITH A RUNNING SLOPE OF 1:20 OR LESS, UNLESS OTHERWISE INDICATED, AND A CROSS SLOPE OF 1:48 OR LESS;
 3. IS FREE OF OVERHEAD OBSTRUCTIONS WITHIN 80" ABOVE THE WALKING SURFACE
 4. IS FREE OF OBJECTS WHICH PROTRUDE MORE THAN 4" BETWEEN THE HEIGHTS OF 27" AND 80" ABOVE THE WALKING SURFACE.
3. PASSING SPACES (11B-403.5.3) OF 80"x60" MIN. ARE LOCATED NOT MORE THAN 200' APART. WALKS WITH CONTINUOUS GRADIENTS HAVE 60" IN LENGTH OF LEVEL AREAS (11B-403.7) NOT MORE THAN 400' APART. THERE IS NO DROP-OFF OVER 4" AT THE EDGE OF WALK OR LANDING UNLESS IDENTIFIED BY A GUARD, A HANDRAIL, OR WARNING CURB AT LEAST 6" IN HEIGHT ABOVE THE WALK (11B-303.5).

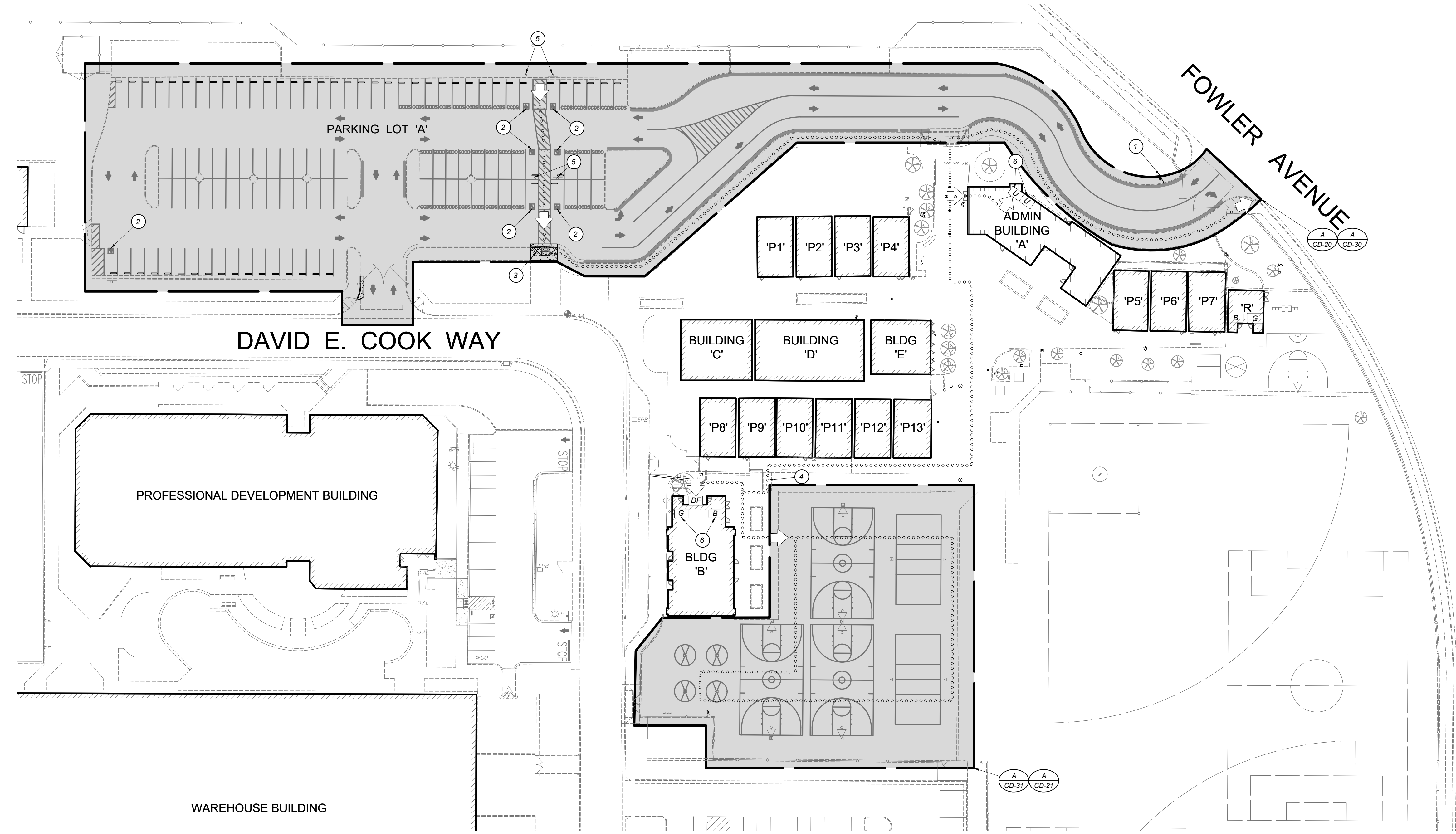

BUILDING LEGEND:

ID	BUILDING USE	DSA APP #
A	ADMINISTRATION BUILDING	02-113303
B	CLASSROOM/ LAB	02-113303
C	LIBRARY	02-109655
D	MULTIPURPOSE	02-109655
R	RESTROOM	02-113303
P1	PORTABLE	02-109655
P2	PORTABLE	02-109655
P3	PORTABLE	02-109655
P4	PORTABLE	02-109655
P5	PORTABLE	02-109655
P6	PORTABLE	02-109655
P7	PORTABLE	02-109655
P8	PORTABLE	02-109655
P9	PORTABLE	02-109655
P10	PORTABLE	02-109655
P11	PORTABLE	02-109655
P12	PORTABLE	02-109655
P13	PORTABLE	02-109655

PARKING CALCULATIONS

LOT#	DSA APP #	TOTAL STALLS PROVIDED	ACCESSIBLE STALLS PROVIDED	ACCESSIBLE STALLS REQUIRED PER CBC 11-B208.2
A	02-109655	109	6 TOTAL, 3 VAN	5 TOTAL, 1 VAN

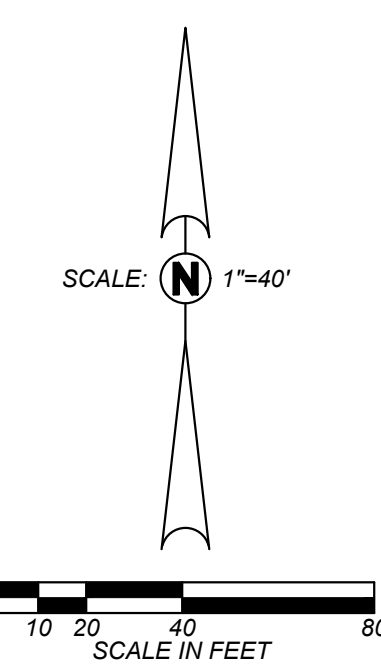

Blair, Church & Flynn
 CONSULTING ENGINEERS
 451 Clovis Avenue, Suite 200
 Clovis, California 93612
 Tel (559) 326-1400
 Fax (559) 326-1500

CONSULTANT	REF. & REV.	CLOVIS UNIFIED SCHOOL DISTRICT	CONST. DOCUMENTS
Blair, Church & Flynn Consulting Engineers 451 Clovis Avenue, Suite 200 Clovis, California 93612 Tel (559) 326-1400 Fax (559) 326-1500			
			CD-01

IDENTIFICATION STAMP
 DIV. OF THE STATE ARCHITECT
 APP: 02-119790 INC:
 REVIEWED FOR
 SS FLS ACS
 DATE: 04/06/2022

FOR DSA USE ONLY
 APP # 02-119790

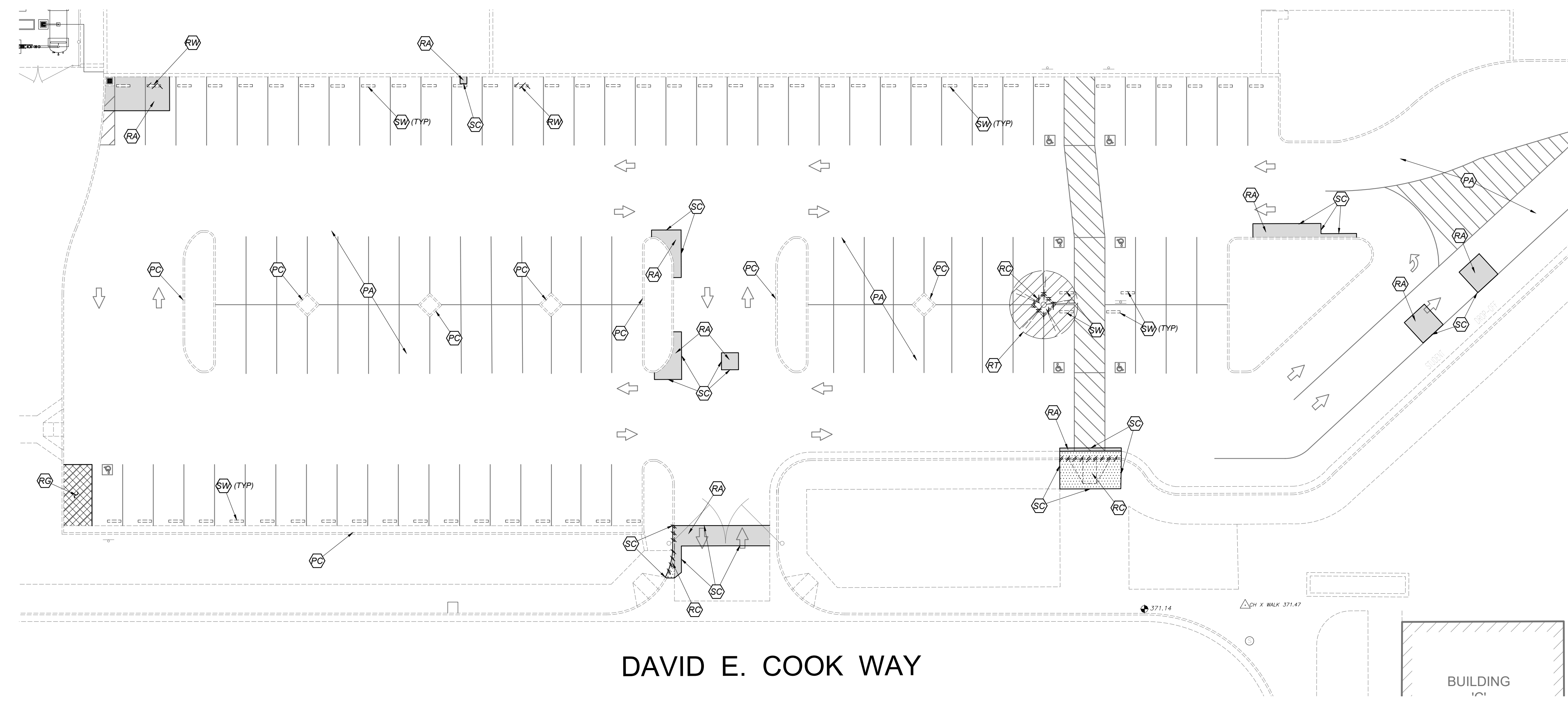

- DEMOLITION LEGEND:**
- APPROXIMATE LIMIT OF DEMOLITION. THE REMOVAL OF IMPROVEMENTS MUST BE COORDINATED WITH ALL PLAN SHEETS. CONTRACTOR MUST ALSO COORDINATE REMOVAL OF IMPROVEMENTS WITH UTILITY AGENCIES. PROTECT ALL IMPROVEMENTS NOT DESIGNATED FOR REMOVAL. SEE DEMOLITION NOTES ON COVER SHEET.
 - LIMITS OF ASPHALTIC-CONCRETE IMPROVEMENT REMOVAL
 - LIMITS OF CONCRETE IMPROVEMENT REMOVAL
 - LIMITS OF GRIND ASPHALT TO REMOVE EXISTING PAINT
 - PROTECT EXISTING ASPHALTIC-CONCRETE PAVING TO REMAIN
 - PROTECT EXISTING CONCRETE IMPROVEMENTS TO REMAIN
 - PROTECT EXISTING SPORTS EQUIPMENT TO REMAIN
 - REMOVE AND LAWFULLY DISPOSE OF ASPHALT CONCRETE PAVEMENT STRUCTURAL SECTION
 - REMOVE EXISTING CONCRETE
 - GRIND ASPHALT TO REMOVE EXISTING PAINT PER DETAIL [L/CDX-1]
 - REMOVE TREE TO A MINIMUM DEPTH OF 3' OR TO THE BOTTOM OF THE ROOTBALL, WHICHEVER IS DEEPER
 - REMOVE AND DISPOSE OF EXISTING WHEELSTOP
 - SAWCUT
 - REMOVE EXISTING WHEELSTOPS PRIOR TO SEAL COAT APPLICATION. SALVAGE FOR REINSTALLATION.
 - REMOVE TREE

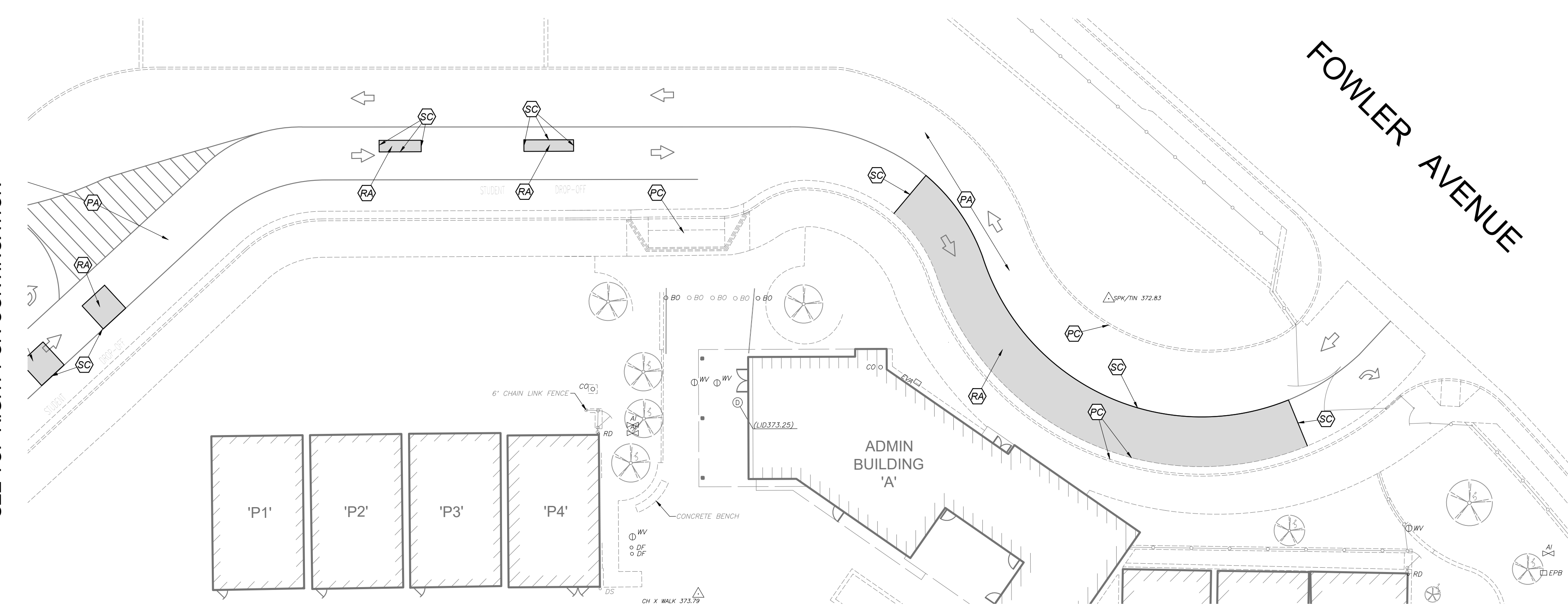

SEE TOP RIGHT FOR CONTINUATION



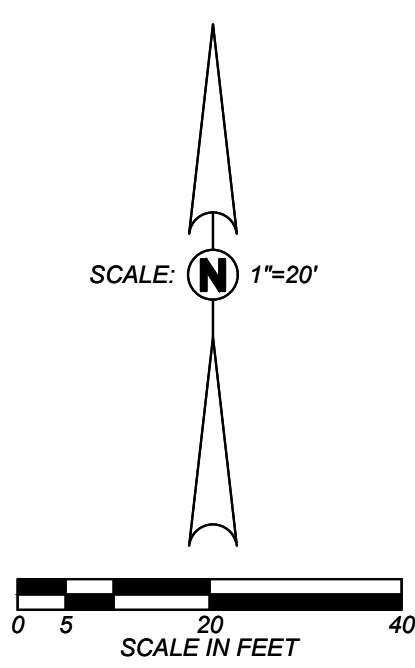





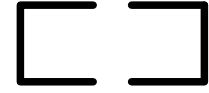

SEE BOTTOM LEFT FOR CONTINUATION

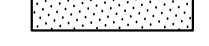

A PARKING LOT 'A' ENLARGED DEMOLITION PLAN
 CD-20

Blair, Church & Flynn
 CONSULTING ENGINEERS
 455 Clovis Avenue, Suite 200
 Clovis, California 93612
 Tel (559) 326-1400
 Fax (559) 326-1500

CONSULTANT	REF. & REV.	CLOVIS UNIFIED SCHOOL DISTRICT 2022 PAVEMENT REHABILITATION VARIOUS SITES COMMUNITY DAY SCHOOL DEMOLITION PLAN	CONST. DOCUMENTS CD-20
Blair, Church & Flynn Consulting Engineers 455 Clovis Avenue, Suite 200 Clovis, California 93612 Tel (559) 326-1400 Fax (559) 326-1500			

- DEMOLITION LEGEND:**
-  APPROXIMATE LIMIT OF DEMOLITION. THE REMOVAL OF IMPROVEMENTS MUST BE COORDINATED WITH ALL PLAN SHEETS. CONTRACTOR MUST ALSO COORDINATE REMOVAL OF IMPROVEMENTS WITH UTILITY AGENCIES. PROTECT ALL IMPROVEMENTS NOT DESIGNATED FOR REMOVAL. SEE DEMOLITION NOTES ON COVER PAGE.
 -  LIMITS OF ASPHALTIC-CONCRETE IMPROVEMENT REMOVAL
 -  LIMITS OF CONCRETE IMPROVEMENT REMOVAL
 -  PROTECT EXISTING ASPHALTIC-CONCRETE PAVING TO REMAIN
 -  PROTECT EXISTING CONCRETE IMPROVEMENTS TO REMAIN
 -  PROTECT EXISTING SPORTS EQUIPMENT TO REMAIN
 -  PROTECT FENCE TO REMAIN
 -  REMOVE AND LAWFULLY DISPOSE OF ASPHALT CONCRETE PAVEMENT STRUCTURAL SECTION
 -  STORAGE TO BE RELOCATED BY OWNER PRIOR TO START OF CONSTRUCTION
 -  SAWCUT

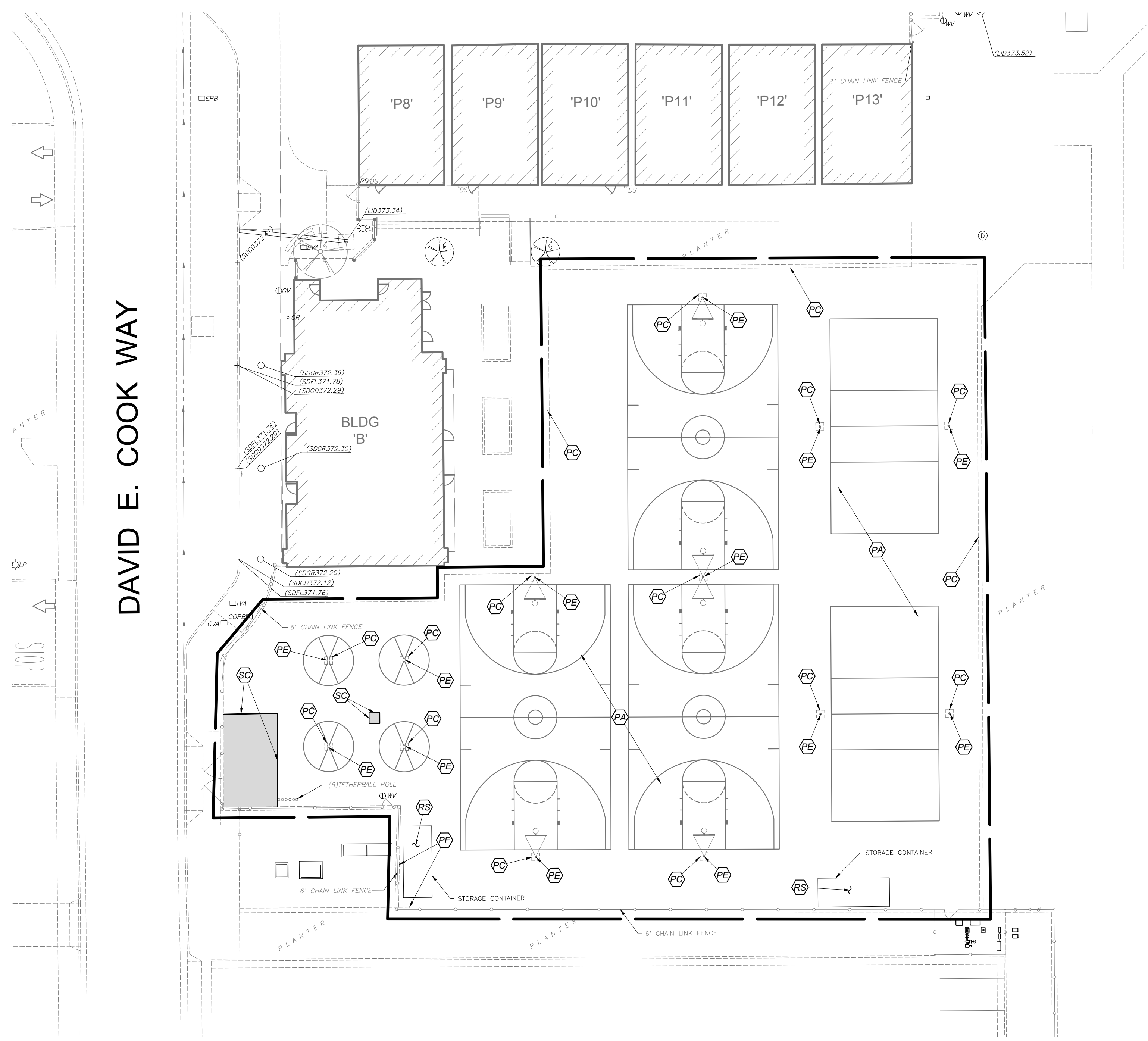

DAVID E. COOK WAY

A
 CD-21 PLAYCOURT ENLARGED DEMOLITION PLAN

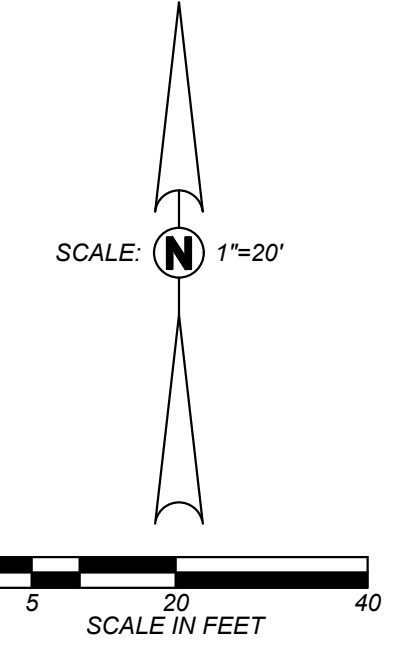

Blair, Church & Flynn
 CONSULTING ENGINEERS



CONSULTANT
 Blair, Church & Flynn
 Consulting Engineers
 485 Clovis Avenue,
 Suite 200
 Clovis, California 93612
 Tel (559) 326-1400
 Fax (559) 326-1500

REF. & REV.

CLOVIS UNIFIED SCHOOL DISTRICT	
2022 PAVEMENT REHABILITATION VARIOUS SITES COMMUNITY DAY SCHOOL DEMOLITION PLAN	
CONST. DOCUMENTS	CD-21
DR. BY: AH	SCALE AS NOTED
CH. BY: JF	
DATE: 01/21/2022	

C:\Users\jflinn\OneDrive\Documents\Projects\2022\CD-21\CD-21.dwg, 1/21/2022, 8:58 AM
 Plot by Automation: Apr 04, 2022, 8:58 AM

IDENTIFICATION STAMP
 DIV. OF THE STATE ARCHITECT
 APP: 02-119790 INC:
 REVIEWED FOR
 SS FLS ACS
 DATE: 04/06/2022

FOR DSA USE ONLY
 APP # 02-119790

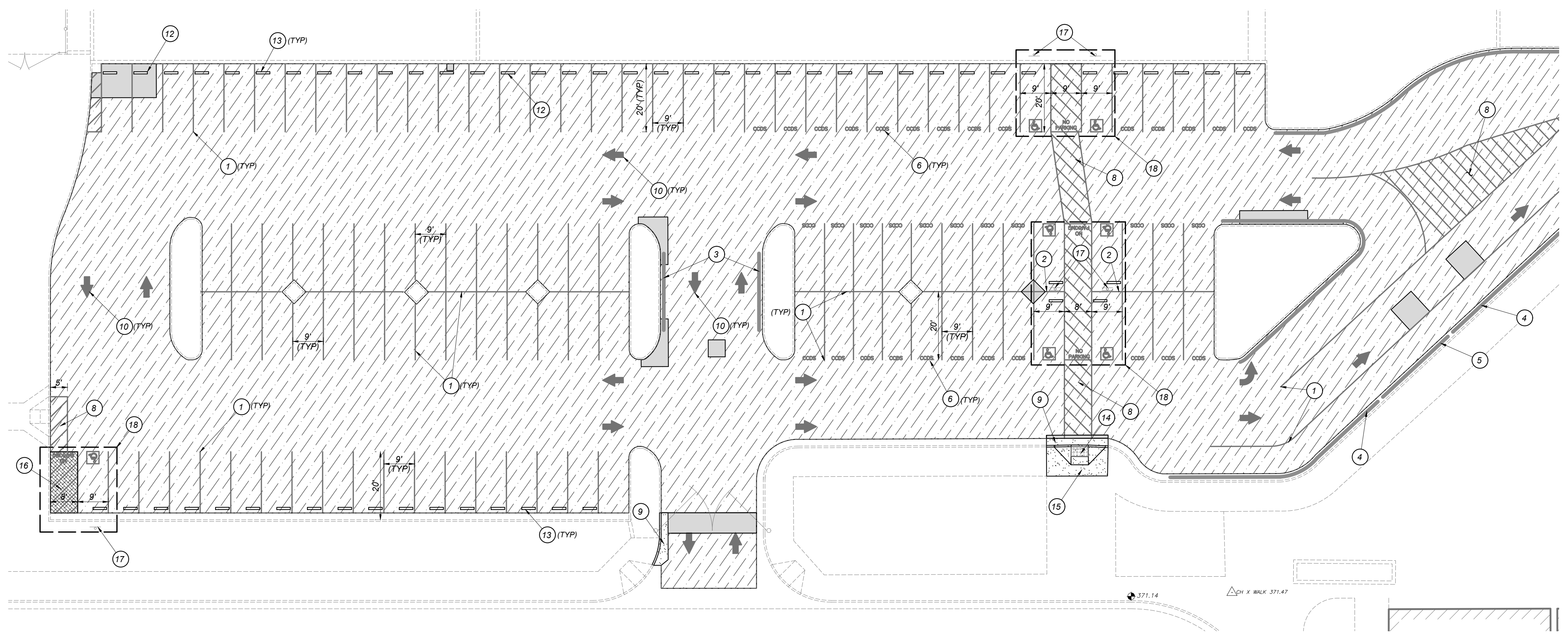

SEE BOTTOM LEFT FOR CONTINUATION

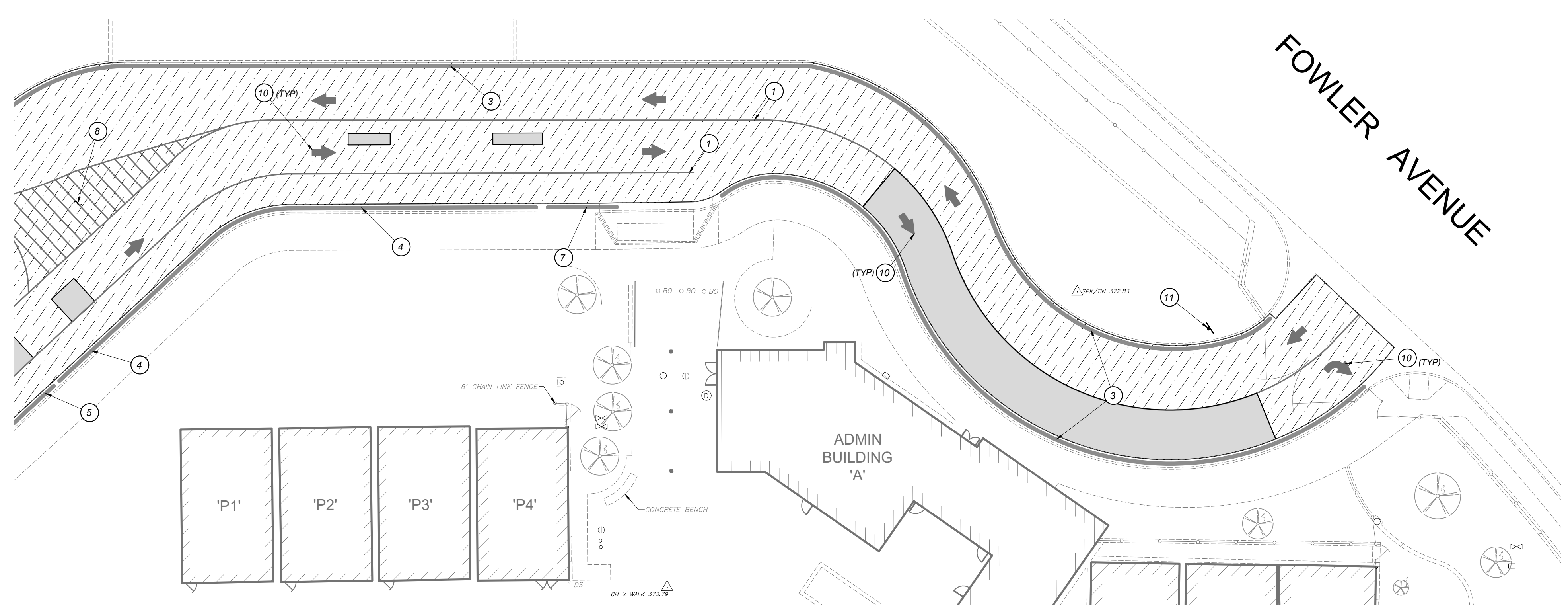

SEE TOP RIGHT FOR CONTINUATION

CONSTRUCTION LEGEND:

- [A-1 CDX-1] [DETAIL DESIGNATION / SHEET LOCATION]
- LIMITS OF CONCRETE IMPROVEMENTS
- LIMITS OF ASPHALTIC CONCRETE PAVEMENT STRUCTURAL SECTION REMOVAL AND REPLACEMENT PER PER DETAIL [A/CDX-1]
- CRACKFILL PER DETAIL [C/CDX-1] AND APPLY A SAND SLURRY PER SPECIFICATIONS.
- LIMITS OF ASPHALT CONCRETE GRIND AND PATCH
- LIMITS OF DETECTABLE WARNINGS SURFACING
- LIMITS OF PAINTED CURB
- 1 PAINT 4" WIDE WHITE STRIPE
- 2 PAINT 4" WIDE BLUE STRIPE
- 3 PAINT TOP AND FACE OF CURB RED WITH 4" HIGH LETTERING, "NO PARKING - FIRE LANE", AT 30' ON CENTER.
- 4 PAINT TOP AND FACE OF CURB WHITE
- 5 PAINT TOP AND FACE OF CURB RED WITH 4" HIGH LETTERING "FOOD SERVICE" TO MATCH EXISTING
- 6 PAINT TOP AND FACE OF CURB RED WITH 4" HIGH LETTERING "CCDS" TO MATCH EXISTING
- 7 PAINT TOP AND FACE OF CURB RED WITH 4" HIGH LETTERING "POLICE" TO MATCH EXISTING
- 8 PAINT ACCESS AREA WITH 4" WIDE WHITE BORDER. PAINT INSIDE ACCESS AREA WITH 4" WIDE WHITE DIAGONAL LINES AT 36" O.C.
- 9 CONCRETE CURB AND GUTTER PER DETAIL [M/CDX-1]
- 10 PAINT DIRECTIONAL ARROW PER DETAIL [G/CDX-1]
- 11 NEW ENTRY SIGN MOUNTED TO EXISTING POST PER DETAIL [K/CDX-1]
- 12 NEW WHEELSTOP PER DETAIL [I/CDX-1]
- 13 RE-INSTALL SALVAGED WHEELSTOPS AFTER SEALCOAT HAS BEEN APPLIED PER DETAIL [I/CDX-1]
- 14 CONCRETE RAMP PER DETAIL [B/CDX-2]
- 15 CONCRETE WALK PER DETAIL [B/CDX-1]
- 16 PATCH WITH HOT MIX ASPHALT PER DETAIL [U/CDX-1]
- 17 EXISTING ACCESSIBLE PARKING SIGNAGE THAT MEETS THE MINIMUM REQUIREMENTS OF DETAIL [J/CDX-1]. NO WORK REQUIRED AS PART OF THIS PROJECT.
- 18 ACCESSIBLE PARKING STALL AND ACCESS AISLE. SEE DETAIL [A/CDX-2] FOR ALL ACCESSIBILITY REQUIREMENTS
- 19 PAINT TETHERBALL COURT PER DETAIL [F/CDX-2]
- 20 PAINT BASKETBALL COURT PER DETAIL [D/CDX-2]
- 21 PAINT VOLLEYBALL COURT PER DETAIL [E/CDX-2]

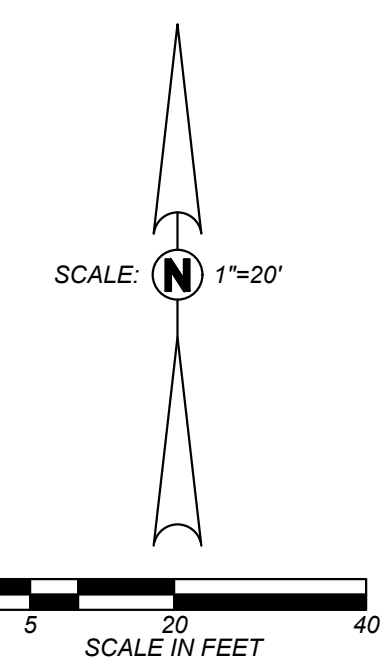

A PARKING LOT 'A' ENLARGED SITE PLAN
 CD-30

Blair, Church & Flynn
 CONSULTING ENGINEERS
 452 Clovis Avenue, Suite 200
 Clovis, California 93612
 Tel (559) 326-1400
 Fax (559) 326-1500

CONSULTANT	REF. & REV.	CLOVIS UNIFIED SCHOOL DISTRICT	
Blair, Church & Flynn Consulting Engineers 452 Clovis Avenue, Suite 200 Clovis, California 93612 Tel (559) 326-1400 Fax (559) 326-1500		2022 PAVEMENT REHABILITATION VARIOUS SITES COMMUNITY DAY SCHOOL SITE PLAN	
		CONST. DOCUMENTS	CD-30
		DR. BY: AH CH. BY: JF DATE: 01/21/2022 SCALE AS NOTED	

C:\Users\jflinn\OneDrive\Documents\Projects\2022\CD-30\CD-30.dwg, 04/06/2022, 10:07 AM, 10:07 AM

IDENTIFICATION STAMP
 DIV. OF THE STATE ARCHITECT
 APP: 02-119790 INC:
 REVIEWED FOR
 SS FLS ACS
 DATE: 04/06/2022

FOR DSA USE ONLY
 APP # 02-119790

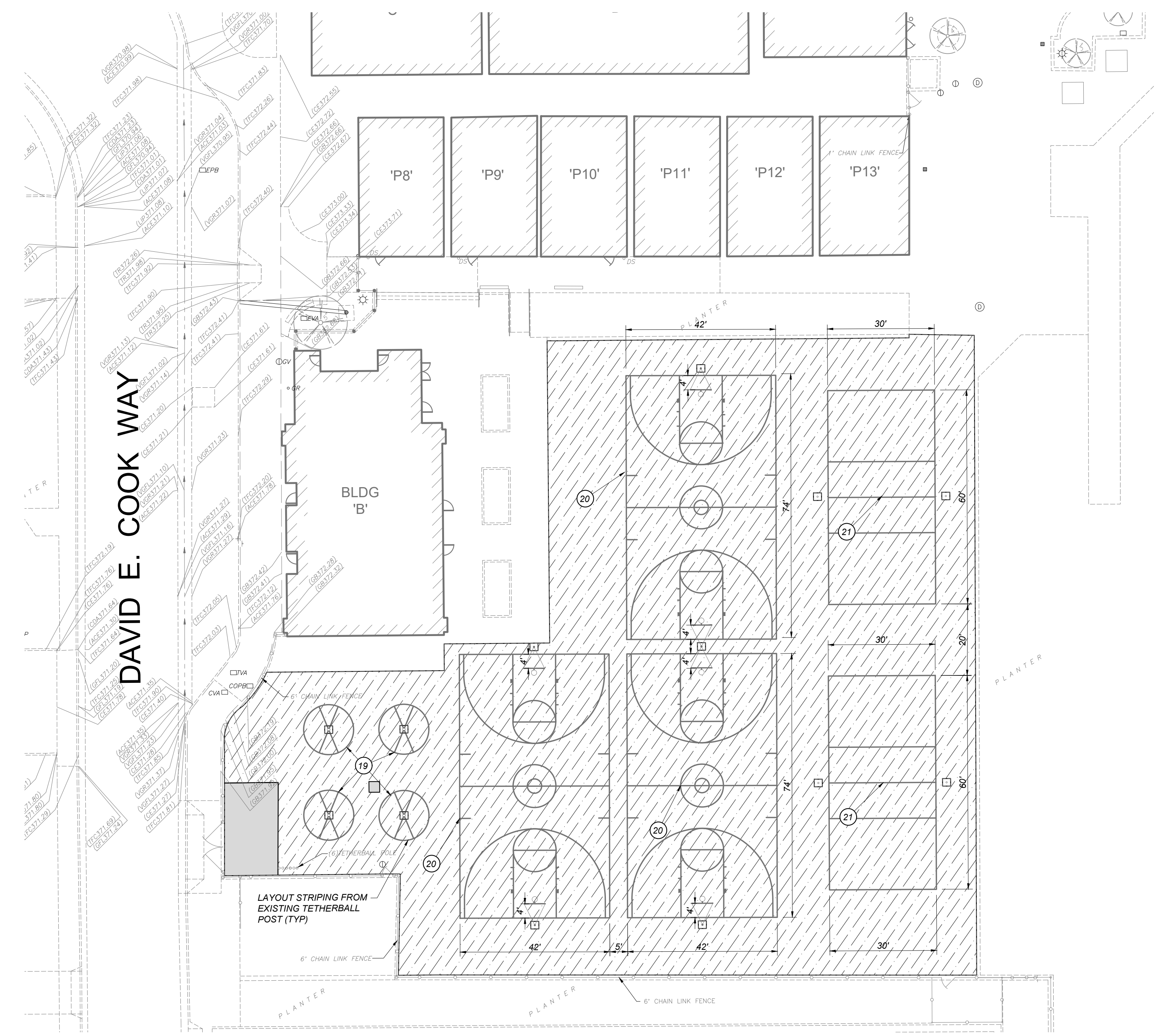

CONSTRUCTION LEGEND:

- [A/CDX-1] [DETAIL DESIGNATION / SHEET LOCATION]
- LIMITS OF CONCRETE IMPROVEMENTS
- LIMITS OF ASPHALTIC CONCRETE PAVEMENT
STRUCTURAL SECTION REMOVAL AND
REPLACEMENT PER PER DETAIL [A/CDX-1]
- CRACKFILL PER DETAIL [C/CDX-1] AND APPLY A SAND
SLURRY PER SPECIFICATIONS.
- LIMITS OF ASPHALT CONCRETE GRIND AND PATCH
- LIMITS OF DETECTABLE WARNINGS SURFACING
- LIMITS OF PAINTED CURB
- PAINT 4" WIDE WHITE STRIPE
- PAINT 4" WIDE BLUE STRIPE
- PAINT TOP AND FACE OF CURB RED WITH 4" HIGH
LETTERING, "NO PARKING - FIRE LANE", AT 30" ON
CENTER.
- PAINT TOP AND FACE OF CURB WHITE
- PAINT TOP AND FACE OF CURB RED WITH 4" HIGH
LETTERING "FOOD SERVICE" TO MATCH EXISTING
- PAINT TOP AND FACE OF CURB RED WITH 4" HIGH
LETTERING "POLICE" TO MATCH EXISTING
- PAINT TOP AND FACE OF CURB RED WITH 4" HIGH
LETTERING "POLICE" TO MATCH EXISTING
- PAINT TOP AND FACE OF CURB RED WITH 4" HIGH
LETTERING "POLICE" TO MATCH EXISTING
- CONCRETE CURB AND GUTTER PER DETAIL
[M/CDX-1]
- PAINT DIRECTIONAL ARROW PER DETAIL [G/CDX-1]
- NEW ENTRY SIGN MOUNTED TO EXISTING POST PER
DETAIL [K/CDX-1]
- NEW WHEELSTOP PER DETAIL [I/CDX-1]
- RE-INSTALL SALVAGED WHEELSTOPS AFTER
SEALCOAT HAS BEEN APPLIED PER DETAIL [I/CDX-1]
- CONCRETE RAMP PER DETAIL [B/CDX-2]
- CONCRETE WALK PER DETAIL [B/CDX-1]
- PATCH WITH HOT MIX ASPHALT PER DETAIL
[J/CDX-1]
- EXISTING ACCESSIBLE PARKING SIGNAGE THAT
MEETS THE MINIMUM REQUIREMENTS OF DETAIL
[L/CDX-1]. NO WORK REQUIRED AS PART OF THIS
PROJECT.
- ACCESSIBLE PARKING STALL AND ACCESS AISLE.
SEE DETAIL [A/CDX-2] FOR ALL ACCESSIBILITY
REQUIREMENTS
- PAINT TETHERBALL COURT PER DETAIL [F/CDX-2]
- PAINT BASKETBALL COURT PER DETAIL [D/CDX-2]
- PAINT VOLLEYBALL COURT PER DETAIL [E/CDX-2]

A PLAYCOURT ENLARGED SITE PLAN
CD-31

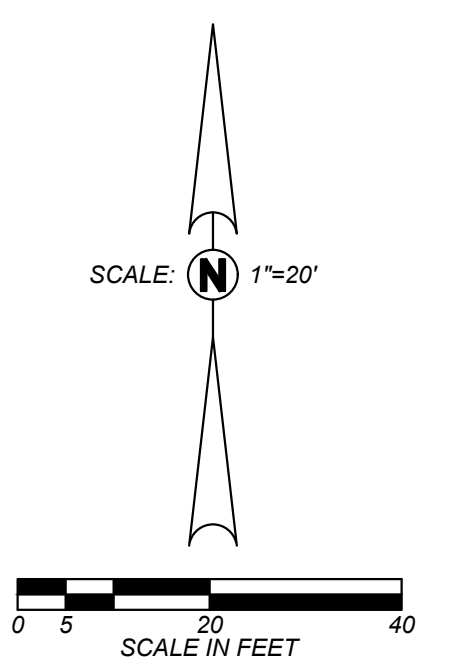

 Blair, Church & Flynn CONSULTING ENGINEERS	 REGISTERED PROFESSIONAL ENGINEER STATE OF CALIFORNIA CIVIL	CONSULTANT	REF. & REV.	CLOVIS UNIFIED SCHOOL DISTRICT 2022 PAVEMENT REHABILITATION VARIOUS SITES COMMUNITY DAY SCHOOL SITE PLAN	CONST. DOCUMENTS DR. BY: AH CH. BY: JF DATE: 01/21/2022 SCALE AS NOTED
		Blair, Church & Flynn Consulting Engineers 485 Clovis Avenue, Suite 200 Clovis, California 93612 Tel (559) 326-1400 Fax (559) 326-1500	2022 PAVEMENT REHABILITATION VARIOUS SITES COMMUNITY DAY SCHOOL SITE PLAN	CD-31	

NOTE:
 CONTRACTOR MAY SUBSTITUTE THE SECTION SHOWN
 IN DETAIL (D/CDX-1) FOR SMALL AREAS OF PAVEMENT
 REPLACEMENT

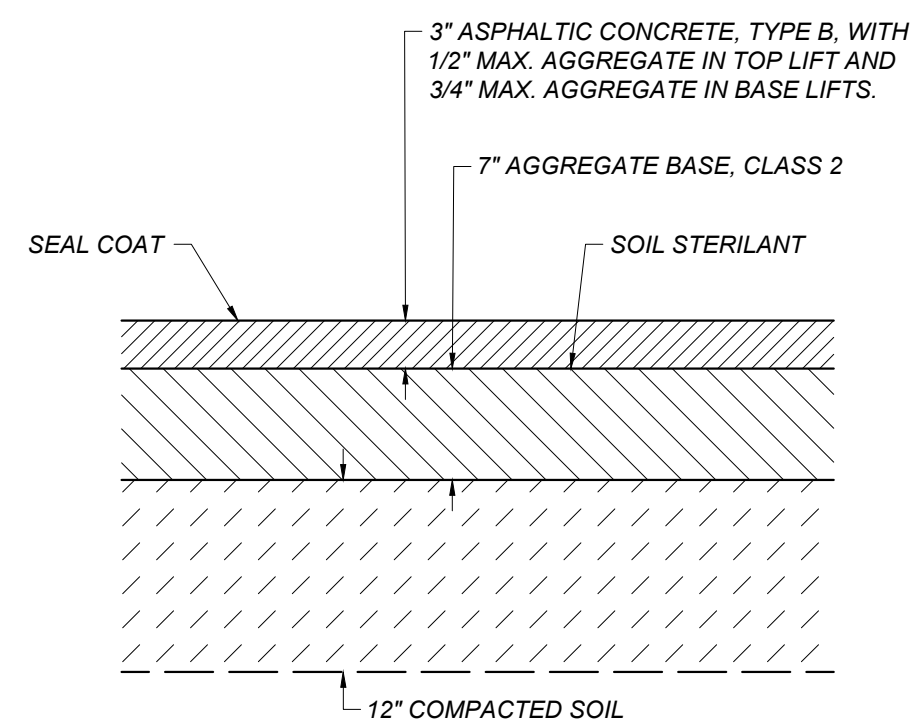

A ASPHALT CONCRETE PAVEMENT SECTION
 CDX-1 NOT TO SCALE

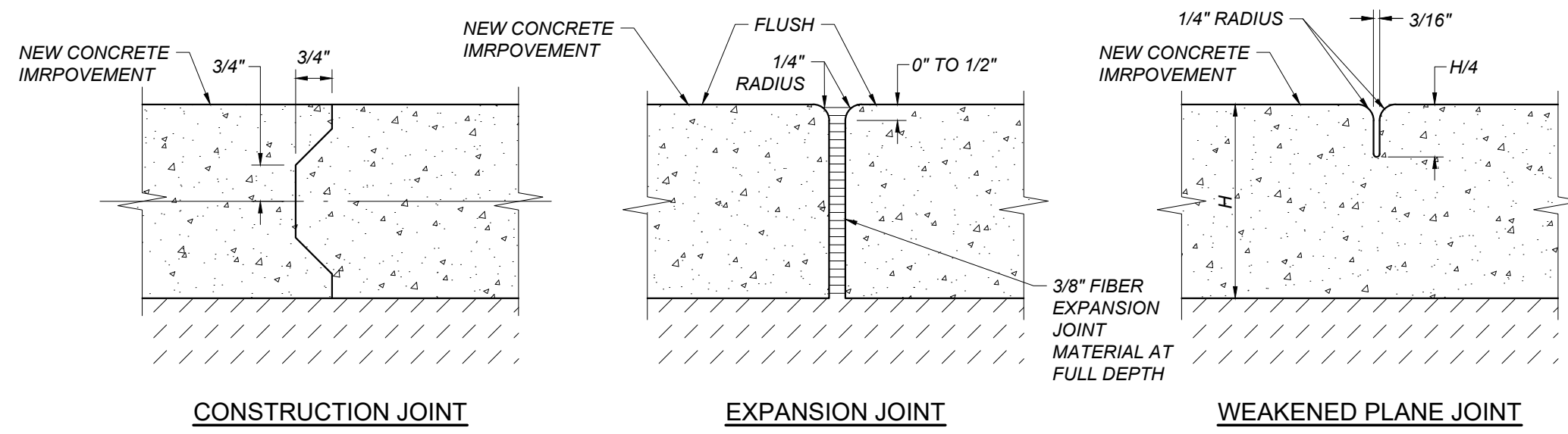

B CONCRETE SIDEWALK
 CDX-1 NOT TO SCALE

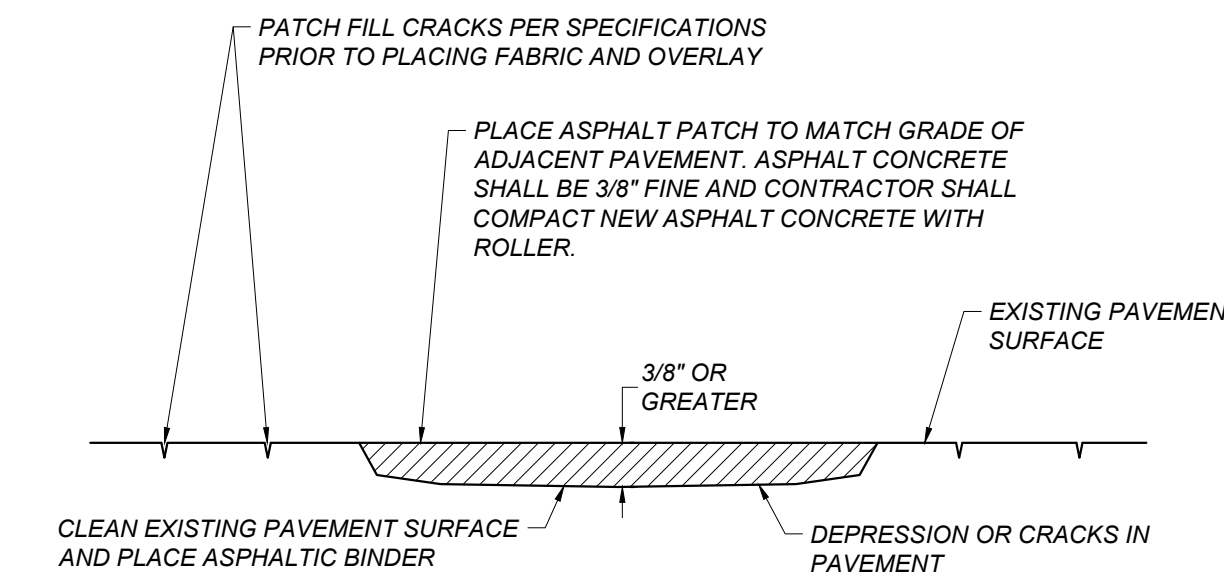
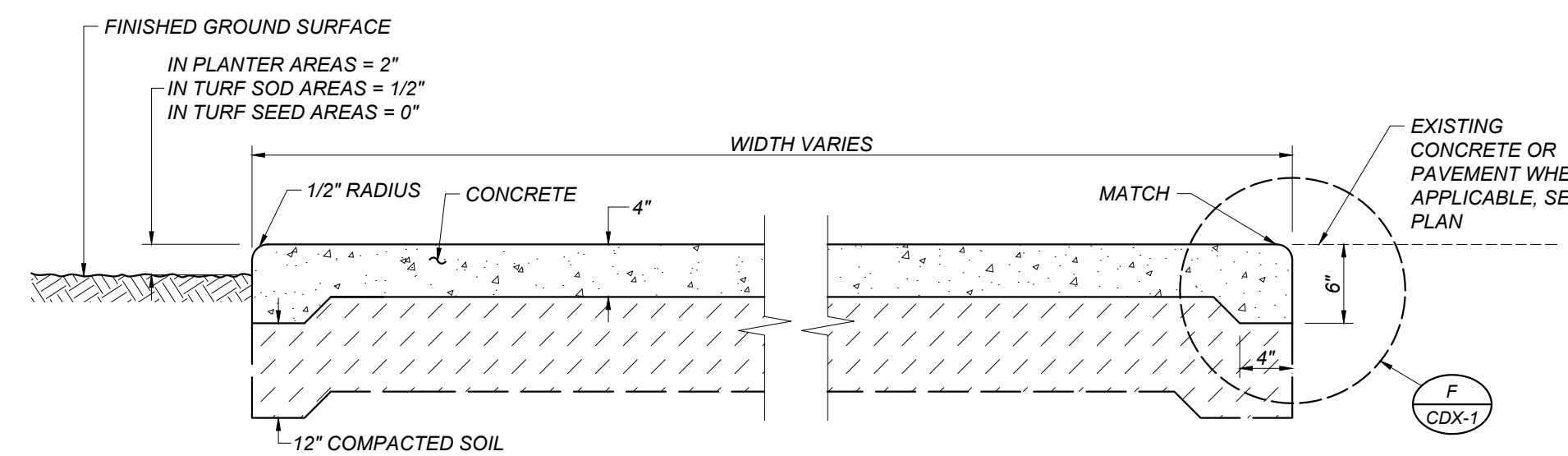

C CRACK PATCHING DETAIL
 CDX-1 NOT TO SCALE

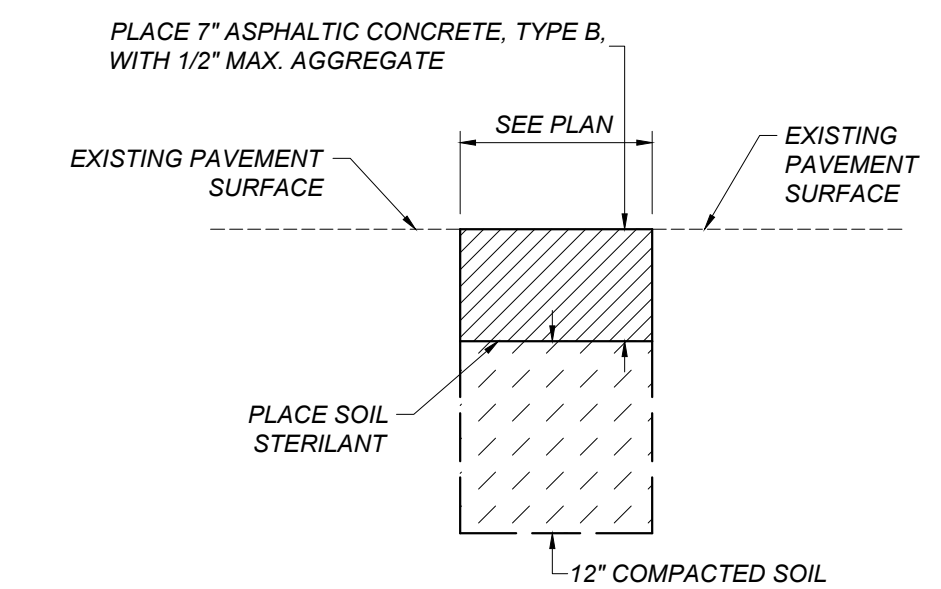

D ASPHALT CONCRETE PLUG
 CDX-1 NOT TO SCALE

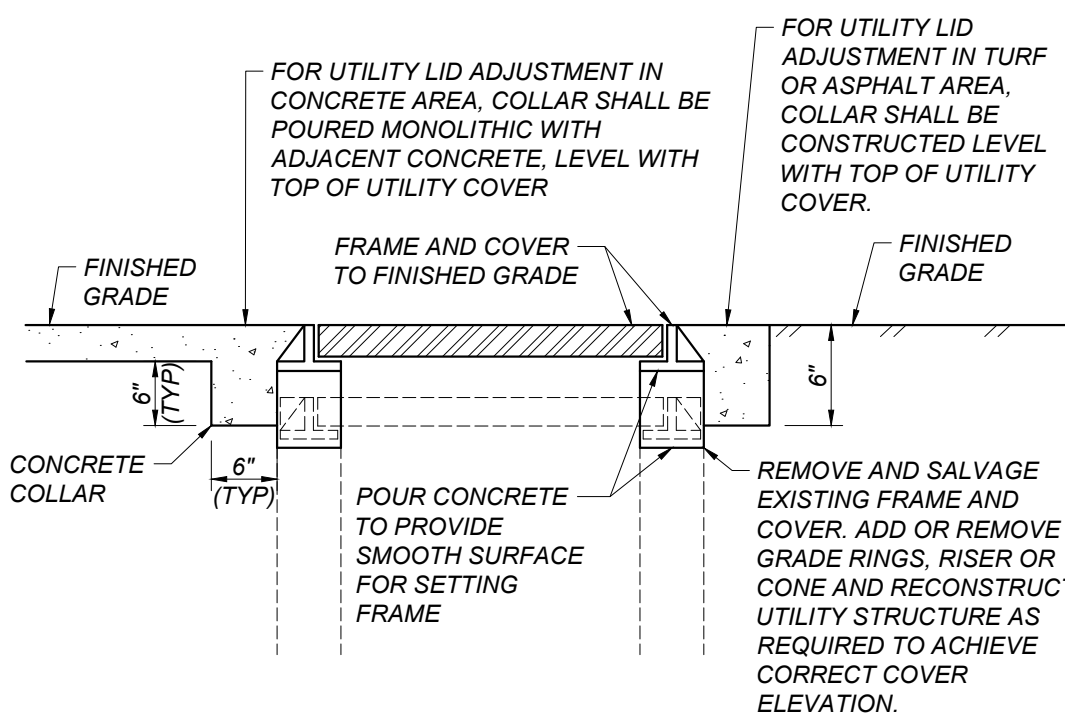

E ADJUST UTILITY LID
 CDX-1 NOT TO SCALE

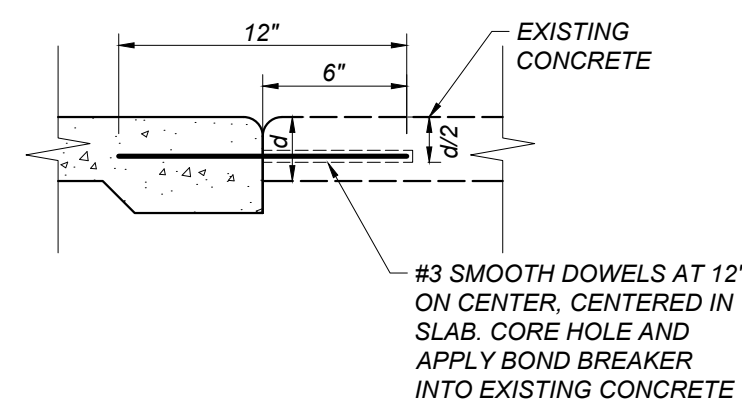

F DOWEL BAR DETAIL
 CDX-1 NOT TO SCALE

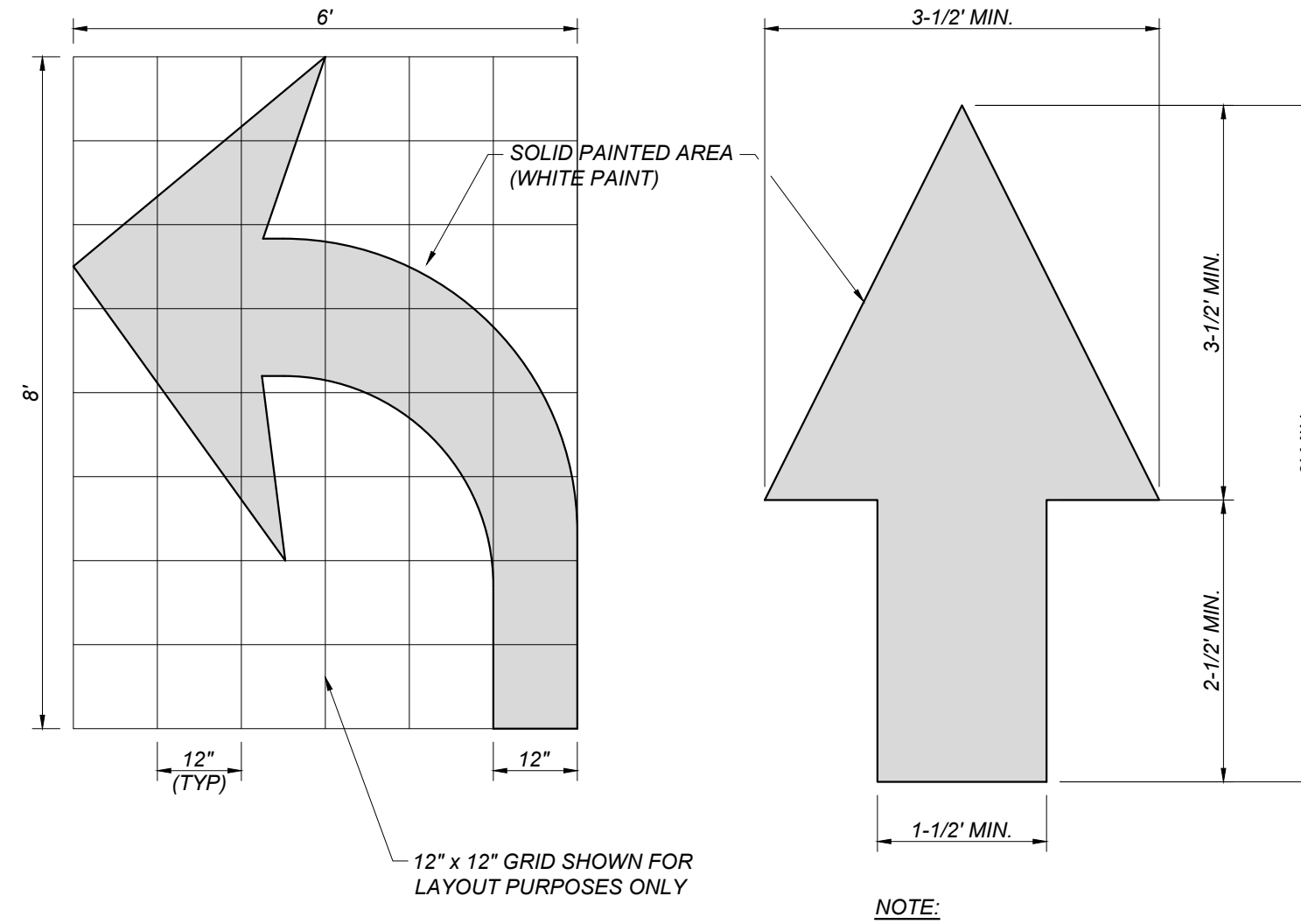

G DIRECTIONAL ARROWS
 CDX-1 NOT TO SCALE

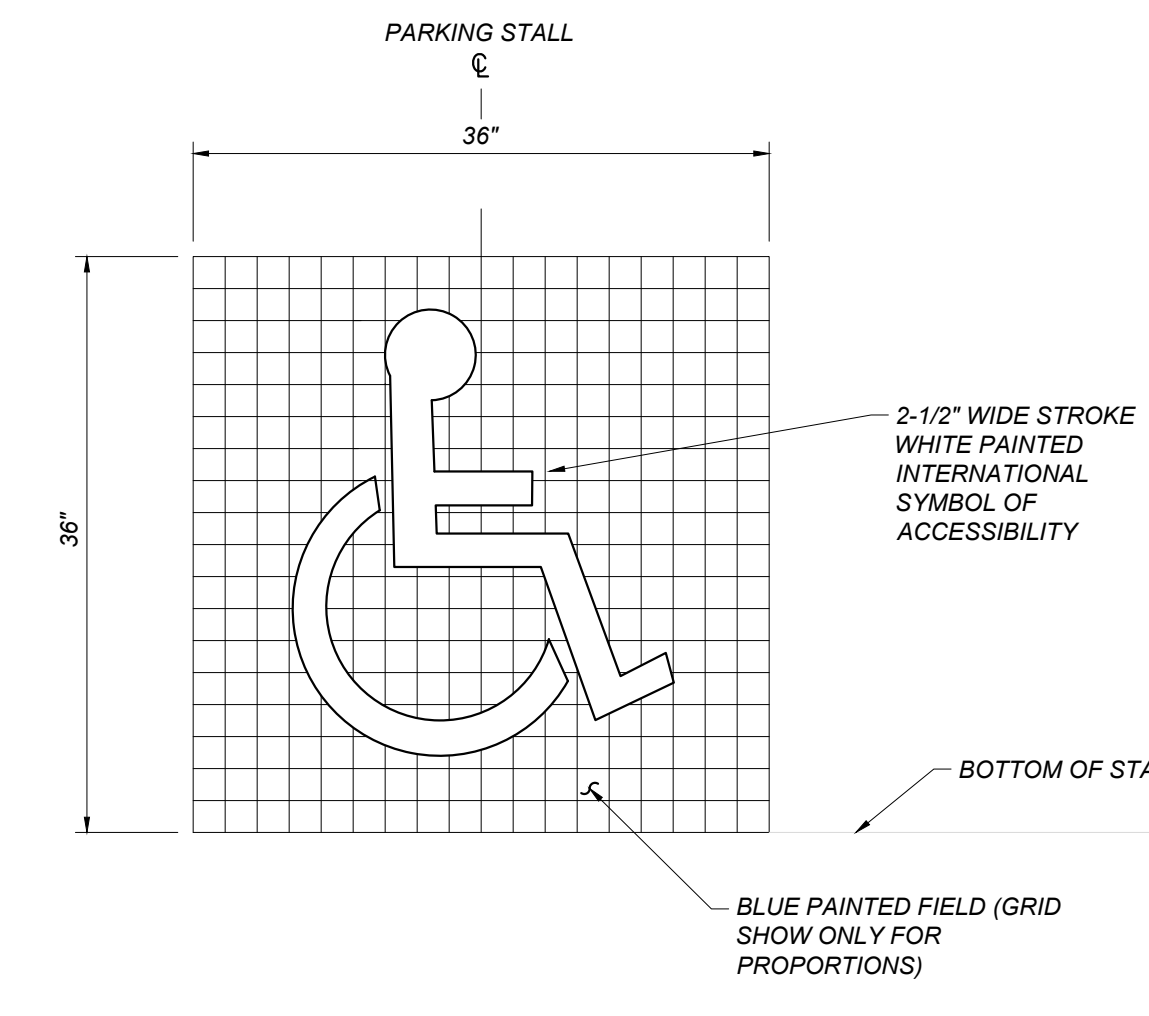

H ACCESSIBLE SYMBOL
 CDX-1 NOT TO SCALE

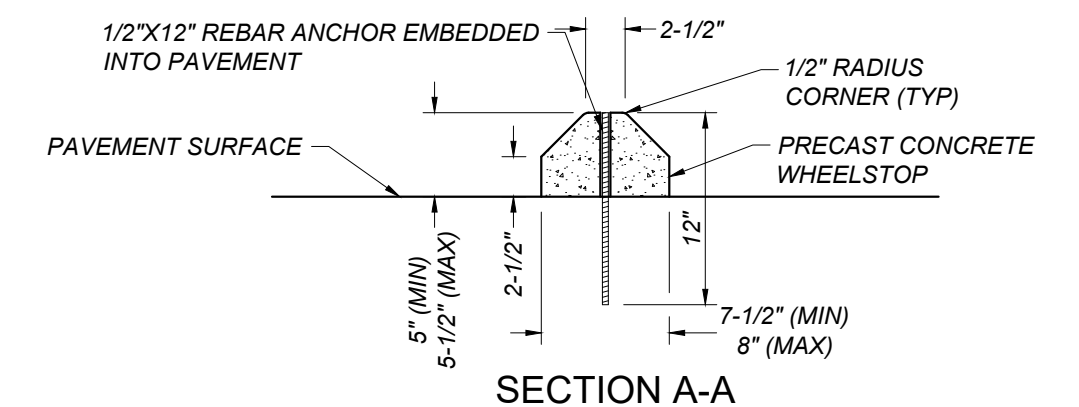
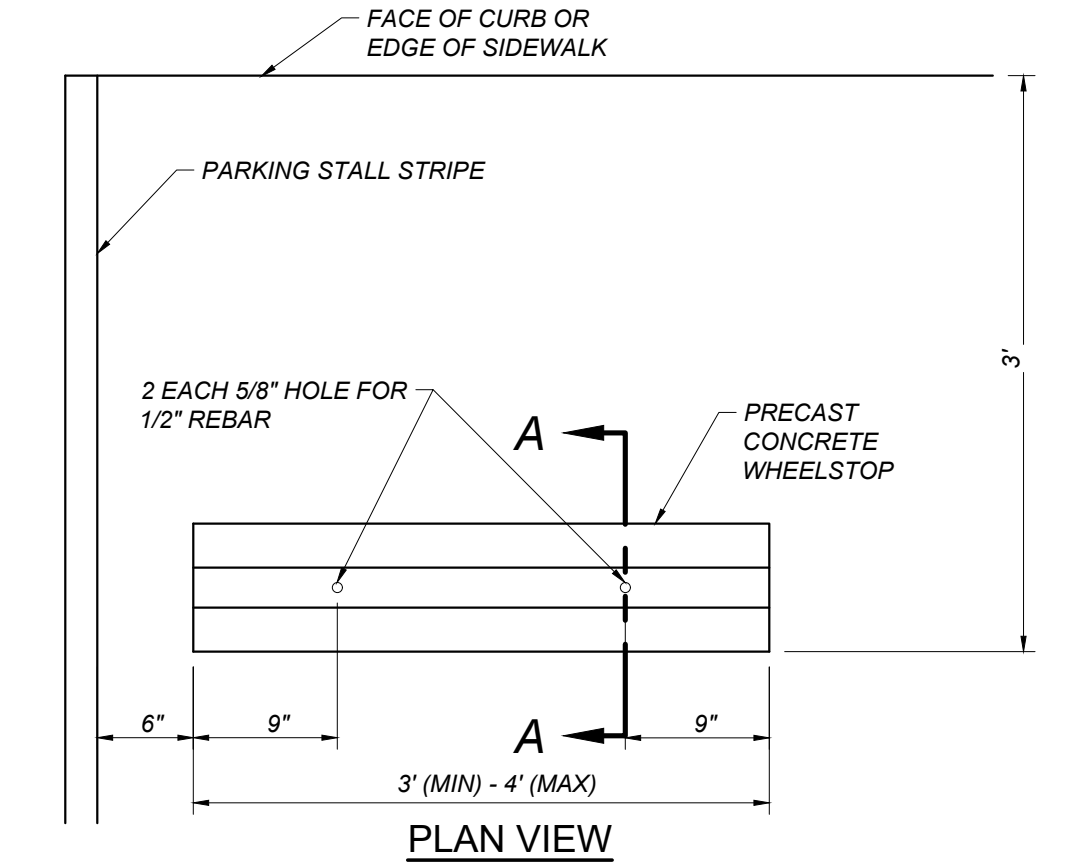

I DETAIL OF TYPICAL WHEELSTOP
 CDX-1 NOT TO SCALE

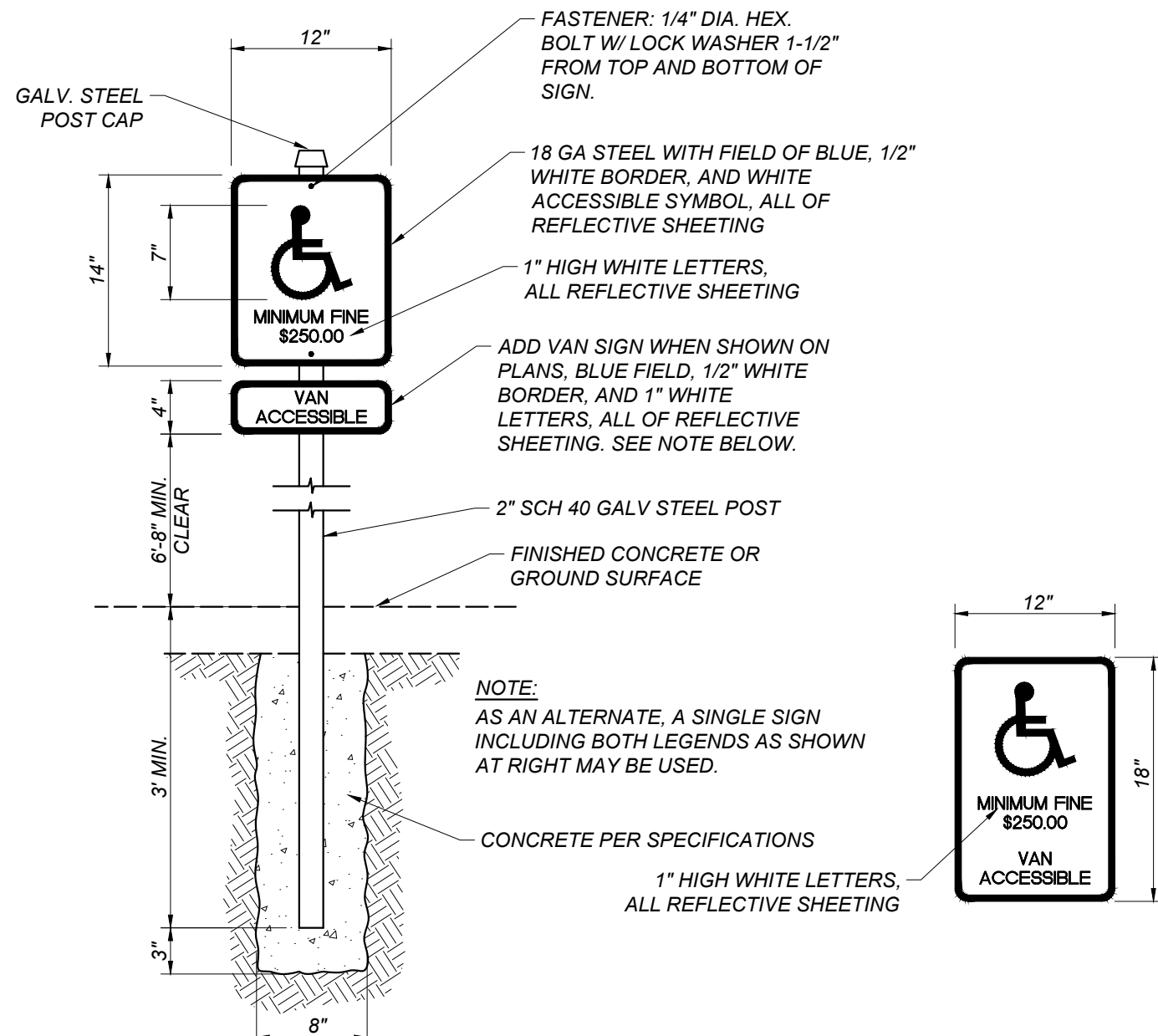

J ACCESSIBLE PARKING STALL SIGNAGE
 CDX-1 NOT TO SCALE

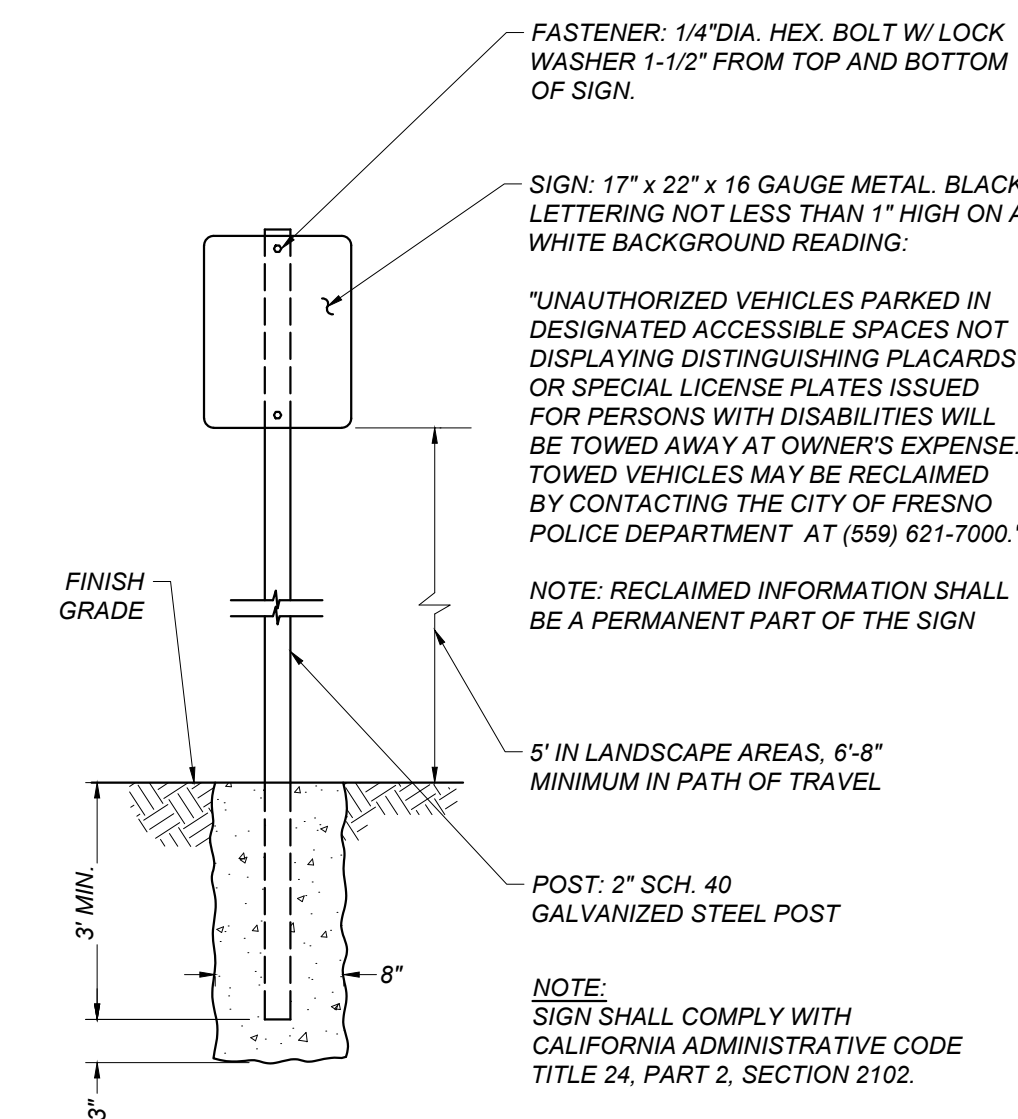

K ENTRY SIGN
 CDX-1 NOT TO SCALE

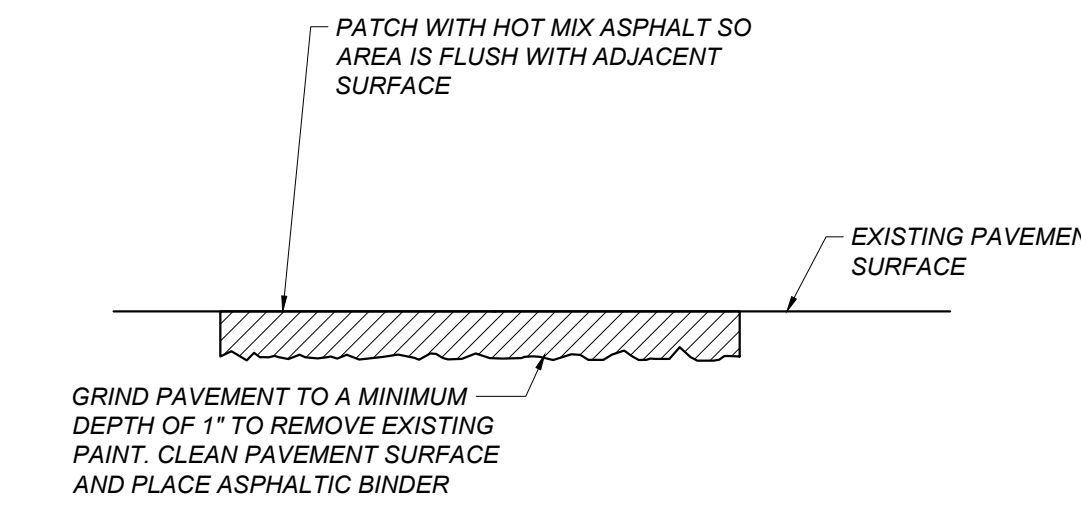

L ASPHALT GRIND AND PATCH
 CDX-1 NOT TO SCALE

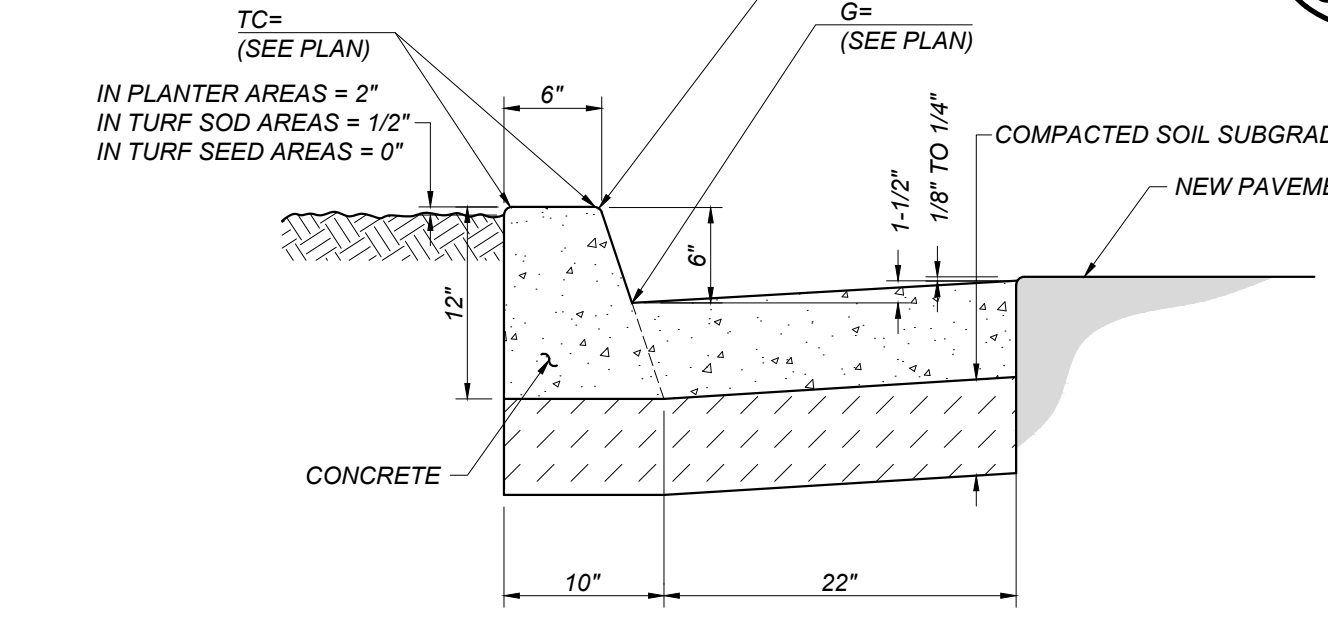

M CONCRETE CURB AND GUTTER
 CDX-1 NOT TO SCALE

GENERAL NOTES FOR PLAYCOURT STRIPING:

1. ALL COURT LINES ARE TO BE 2" IN WIDTH.
2. BASKETBALL COURTS SHALL BE STRIPED YELLOW, VOLLEYBALL COURTS SHALL BE STRIPED RED, AND ALL OTHER PLAYCOURTS SHALL BE STRIPED WHITE.
3. ALL GAME COURT DIMENSIONS ARE TO THE INSIDE OF COURT LINES, WITH THE EXCEPTION OF THE CENTERLINES.
4. CONTRACTOR IS RESPONSIBLE FOR GAME COURT LAYOUTS.
5. LAYOUT BASKETBALL AND VOLLEYBALL COURTS BASED ON EXISTING GOAL AND NET POSTS. LAYOUT FOURSQUARE AND TETHERBALL GAME COURT STRIPING AS SHOWN ON PLAN.
6. CONTRACTOR TO CONFIRM THE HEIGHT FROM THE TOP OF ALL BASKETBALL RIMS TO THE SURFACE OF THE NEW FINISHED PAVEMENT IS 9 FEET ± 1 INCH. CONTRACTOR TO ADJUST BASKETBALL HOOPS AND BACKBOARDS AS NECESSARY TO ACHIEVE THIS HEIGHT.

NOTES:

1. THE DETECTABLE WARNING SURFACE SHALL BE YELLOW AND APPROXIMATE FS 33538 OF SAE AMS-STD-595A.
2. WHERE DETECTABLE WARNING SURFACE DOES NOT PROVIDE A 70% CONTRAST WITH ADJACENT WALKING SURFACES, A 1-INCH WIDE MINIMUM VISUALLY CONTRASTING SURFACE SHALL SEPARATE THE DETECTABLE WARNING FROM THE ADJACENT SURFACE.
3. THE DOMES SHALL BE MANUFACTURED BY ARMOR TILE INC. OR APPROVED EQUAL.
4. ONLY APPROVED DSA/AC DETECTABLE WARNING PRODUCTS AND DIRECTIONAL SURFACES SHALL BE INSTALLED AS PROVIDED IN THE CALIFORNIA CODE OF REGULATIONS (CCR), TITLE 24, PART 1, CHAPTER 5, ARTICLES 2, 3 AND 4.

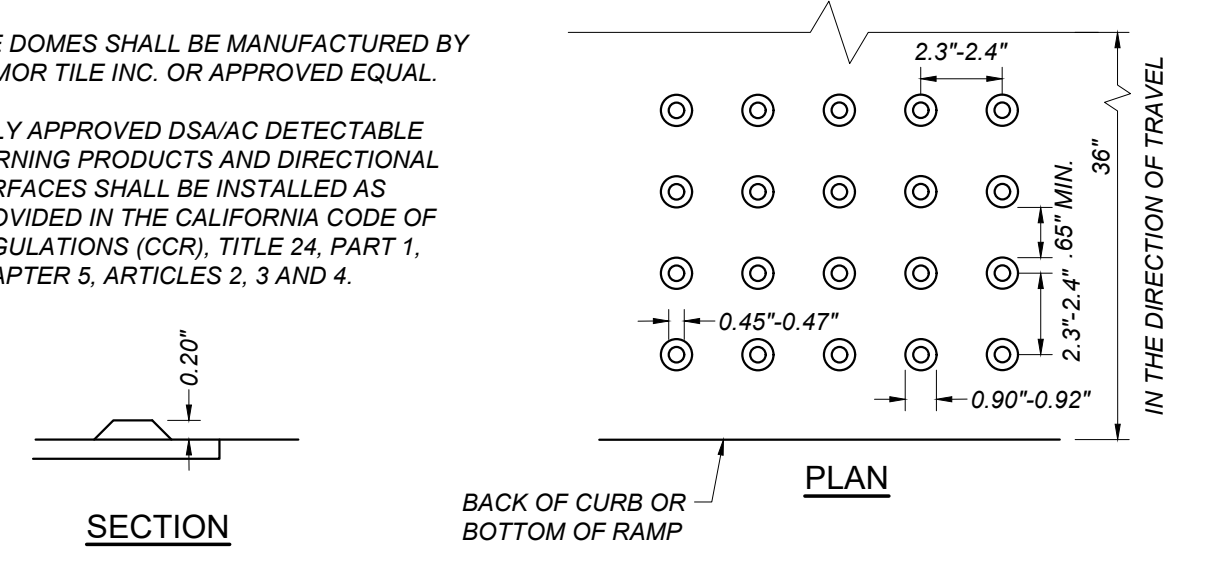

C DETECTABLE WARNINGS
 CDX-2 NOT TO SCALE

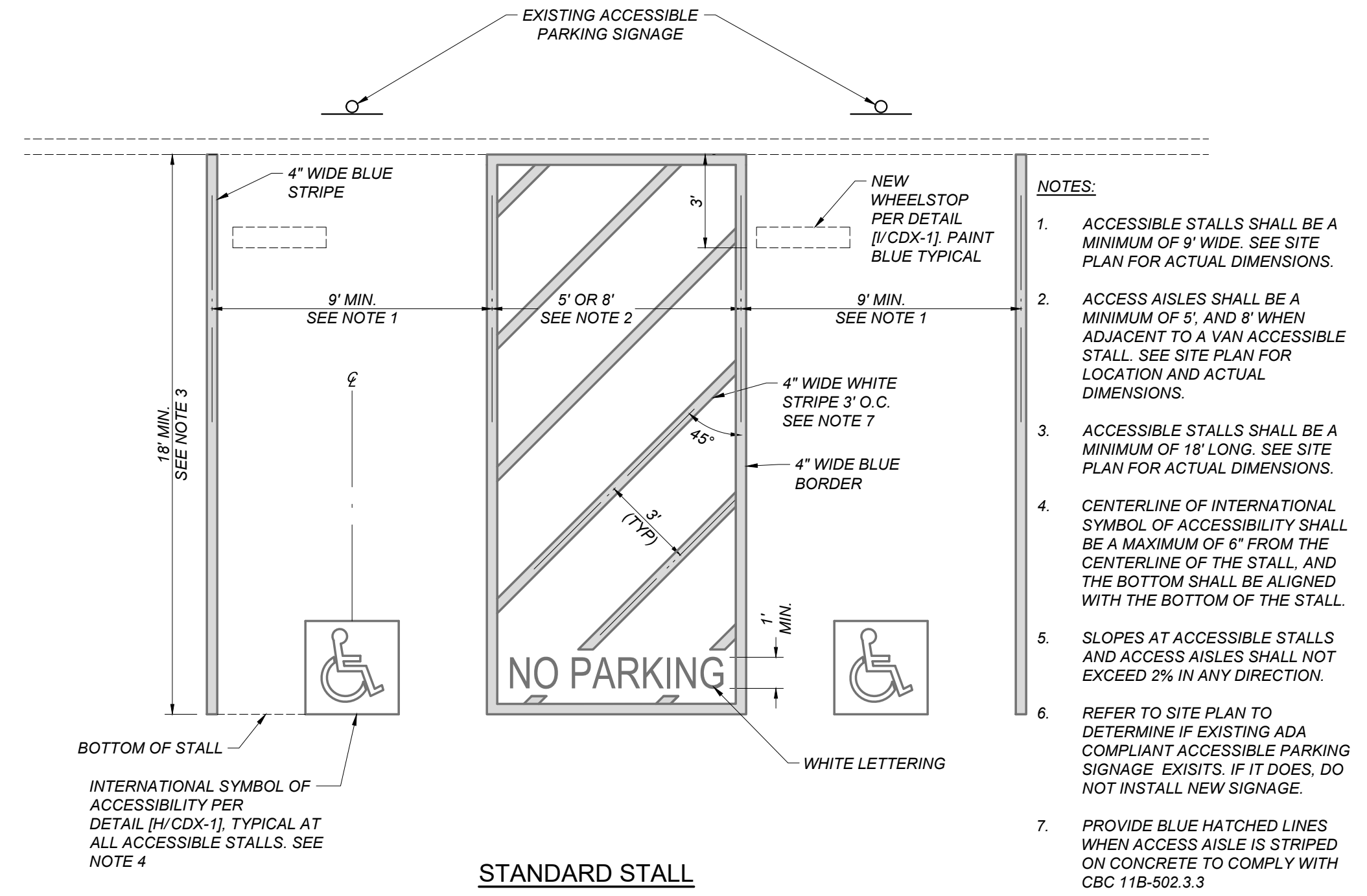

- NOTES:**
1. ACCESSIBLE STALLS SHALL BE A MINIMUM OF 9' WIDE. SEE SITE PLAN FOR ACTUAL DIMENSIONS.
 2. ACCESS AISLES SHALL BE A MINIMUM OF 5', AND 8' WHEN ADJACENT TO A VAN ACCESSIBLE STALL. SEE SITE PLAN FOR LOCATION AND ACTUAL DIMENSIONS.
 3. ACCESSIBLE STALLS SHALL BE A MINIMUM OF 18' LONG. SEE SITE PLAN FOR ACTUAL DIMENSIONS.
 4. CENTERLINE OF INTERNATIONAL SYMBOL OF ACCESSIBILITY SHALL BE A MAXIMUM OF 6" FROM THE CENTERLINE OF THE STALL, AND THE BOTTOM SHALL BE ALIGNED WITH THE BOTTOM OF THE STALL.
 5. SLOPES AT ACCESSIBLE STALLS AND ACCESS AISLES SHALL NOT EXCEED 2% IN ANY DIRECTION.
 6. REFER TO SITE PLAN TO DETERMINE IF EXISTING ADA COMPLIANT ACCESSIBLE PARKING SIGNAGE EXISTS. IF IT DOES, DO NOT INSTALL NEW SIGNAGE.
 7. PROVIDE BLUE HATCHED LINES WHEN ACCESS AISLE IS STRIPED ON CONCRETE TO COMPLY WITH CBC 11B-502.3.3

A TYPICAL ACCESSIBLE PARKING STALL DETAIL
 CDX-2 NOT TO SCALE

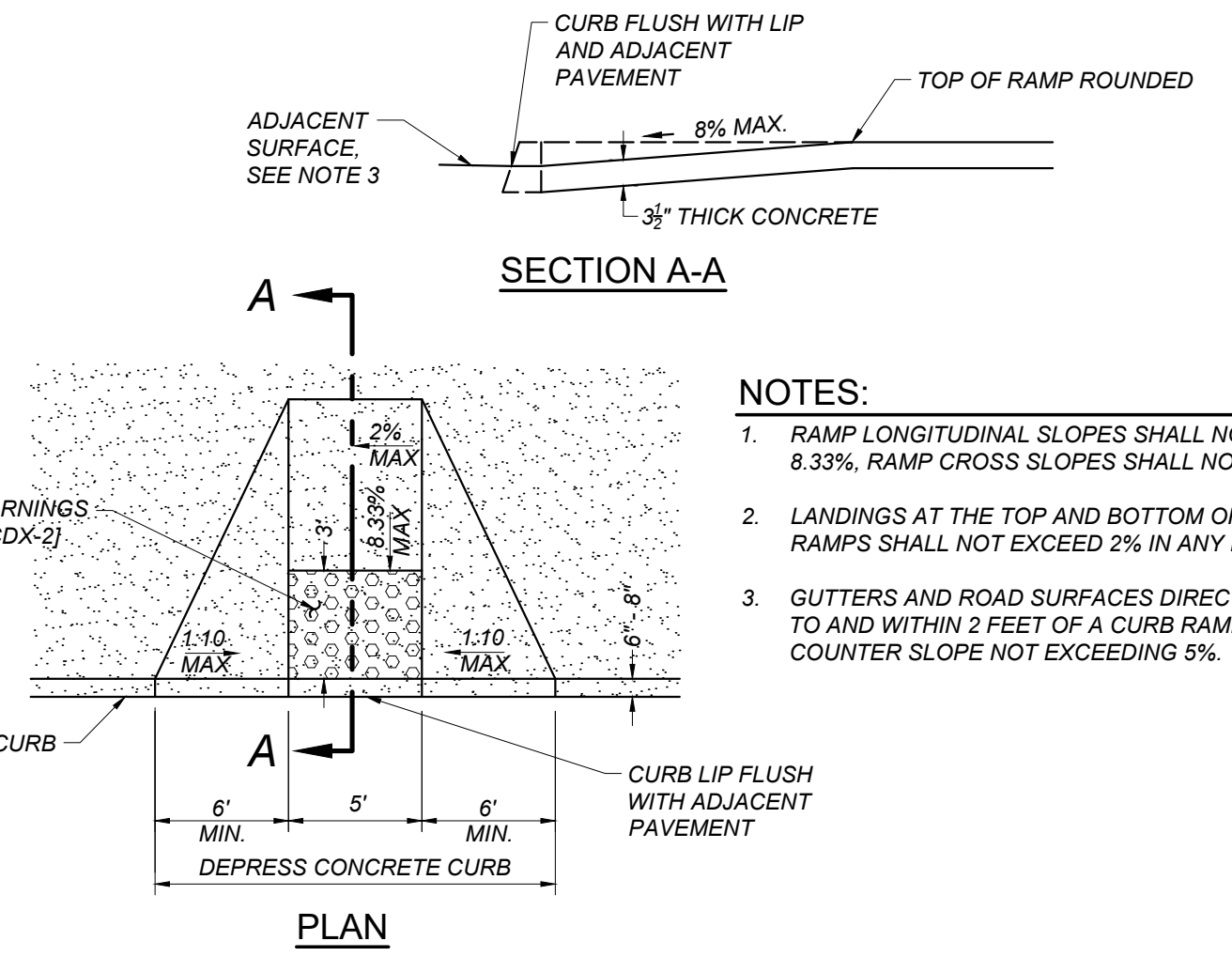

- NOTES:**
1. RAMP LONGITUDINAL SLOPES SHALL NOT EXCEED 8.33%. RAMP CROSS SLOPES SHALL NOT EXCEED 2%.
 2. LANDINGS AT THE TOP AND BOTTOM OF ACCESSIBLE RAMPS SHALL NOT EXCEED 2% IN ANY DIRECTION.
 3. GUTTERS AND ROAD SURFACES DIRECTLY ADJACENT TO AND WITHIN 2 FEET OF A CURB RAMP MAY HAVE A COUNTER SLOPE NOT EXCEEDING 5%.

B FLARED CURB RAMP
 CDX-2 NOT TO SCALE

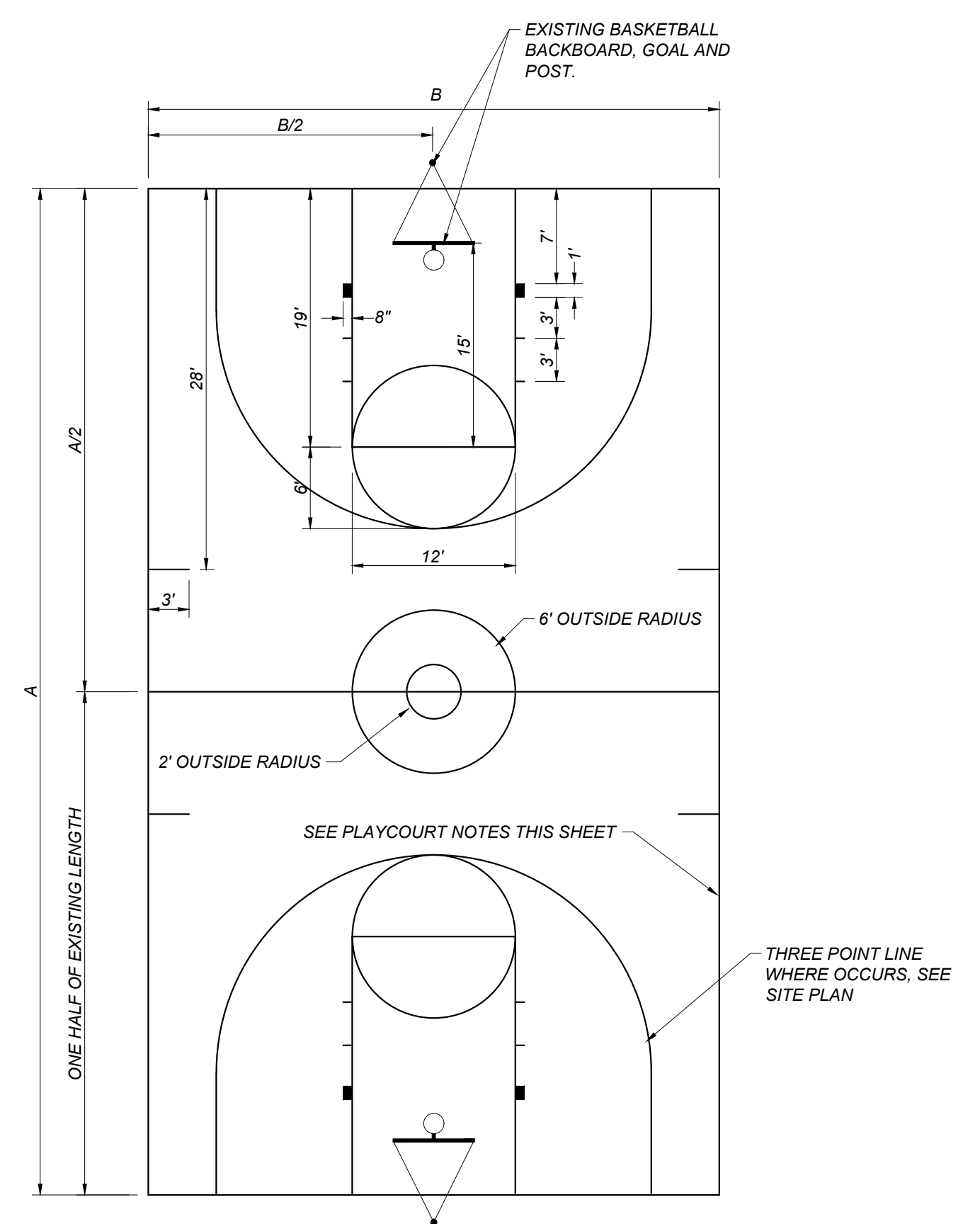

D BASKETBALL COURT
 CDX-2 NOT TO SCALE

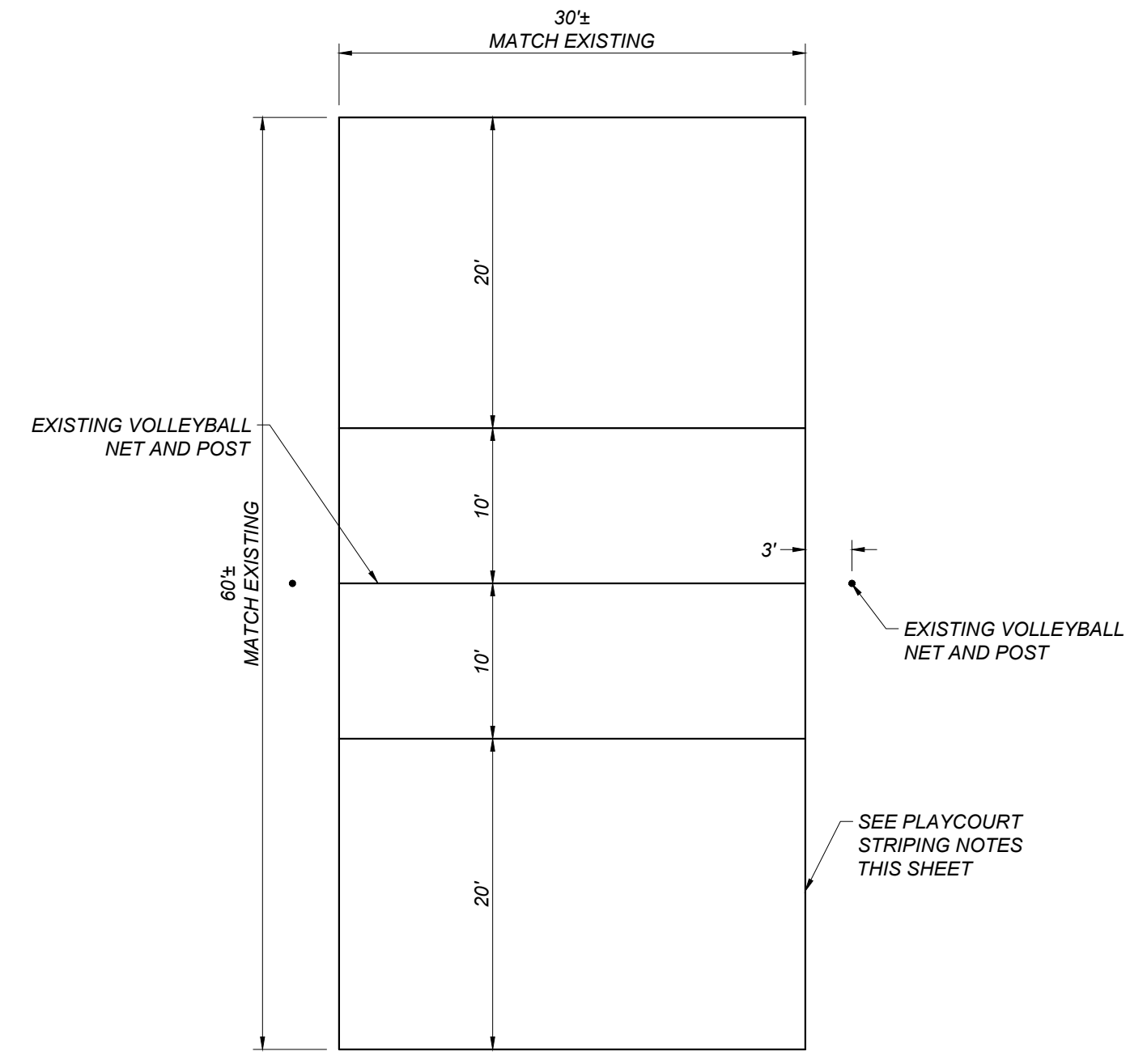

E VOLLEYBALL COURT
 CDX-2 NOT TO SCALE

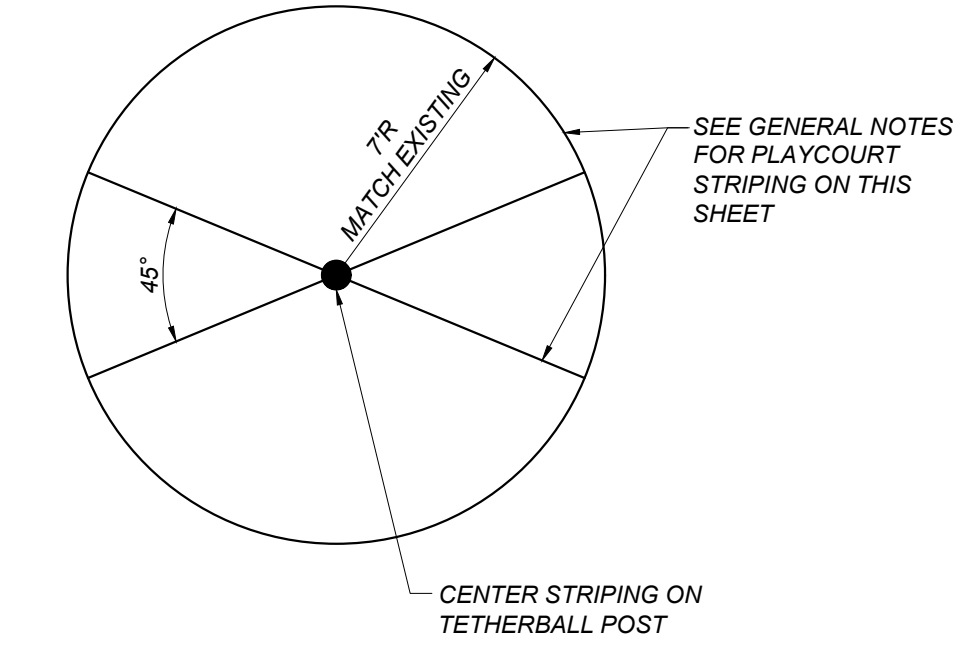

F TETHERBALL COURT
 CDX-2 NOT TO SCALE

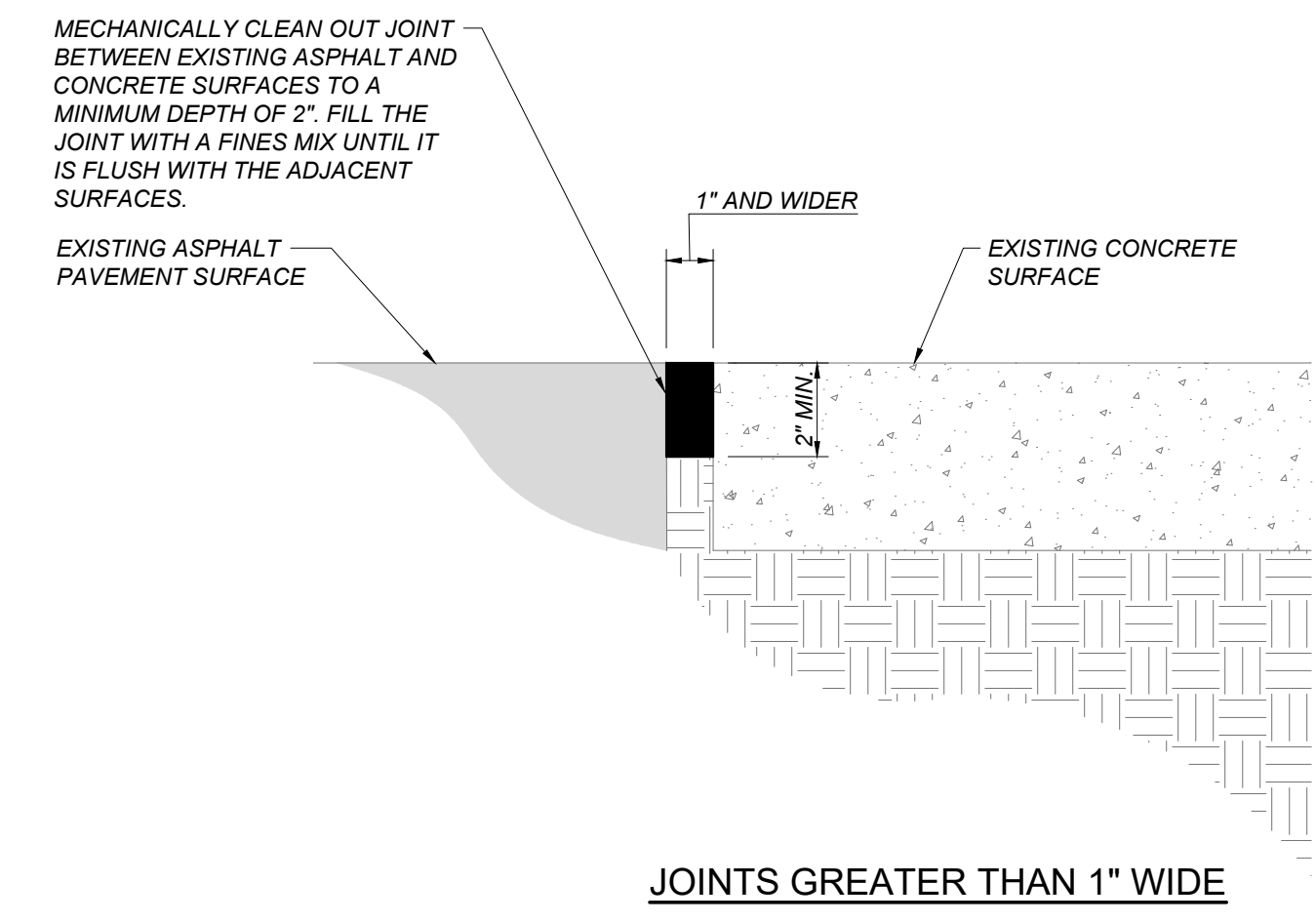

G ASPHALT EDGE CONDITION TREATMENT
 CDX-2 NOT TO SCALE

