

CLOVIS UNIFIED SCHOOL DISTRICT

EIMEAR O'BRIEN, ED. D., DISTRICT SUPERINTENDENT

PLANS FOR THE CONSTRUCTION OF 2022 PARKING LOTS REHABILITATION IMPROVEMENTS AT PROFESSIONAL DEVELOPMENT BUILDING

IDENTIFICATION STAMP
DIV. OF THE STATE ARCHITECT
APP: 02-119793 INC:
REVIEWED FOR
SS FLS ACS
DATE: 04/04/2022

FOR DSA USE ONLY
APP # 02-119793

GENERAL SITE NOTES:

THE REQUIREMENTS AND INFORMATION SET OUT BELOW ARE PROVIDED FOR THE CONTRACTOR'S CONVENIENCE AND DO NOT ENCOMPASS ALL PROJECT REQUIREMENTS DESCRIBED BY THE PROJECT PLANS AND SPECIFICATIONS AND/OR APPLICABLE LAWS, REGULATIONS AND/OR BUILDING CODES.

- CONSTRUCTION OF ALL PROJECT SITE IMPROVEMENTS SUBJECT TO ADA ACCESS COMPLIANCE, INCLUDING ACCESSIBLE PATH OF TRAVEL, CURB RETURNS, PARKING STALL(S) AND UNLOADING AREAS, BARRIER FREE AMENITIES AND/OR OTHER APPLICABLE SITE IMPROVEMENTS SHALL CONFORM TO THE AMERICANS WITH DISABILITIES ACT, CALIFORNIA TITLE 24, AND THE CALIFORNIA BUILDING CODE, CURRENT EDITION(S).
- CONTRACTOR SHALL FIELD VERIFY ALL GRADES AND SLOPES PRIOR TO THE PLACEMENT OF CONCRETE AND/OR PAVEMENT FOR CONFORMANCE WITH ADA ACCESS COMPLIANCE REQUIREMENTS. EXAMPLES OF MINIMUM AND MAXIMUM LIMITS RELATED TO ADA ACCESS COMPLIANCE INCLUDE, BUT ARE NOT LIMITED TO:
 - ACCESSIBLE PATH OF TRAVEL CROSS-SLOPE SHALL NOT EXCEED 2%
 - ACCESSIBLE PATH OF TRAVEL LONGITUDINAL SLOPES SHALL NOT EXCEED 5%
 - RAMP LONGITUDINAL SLOPES SHALL NOT EXCEED 8.33%
 - WALKS SHALL NOT HAVE LESS THAN 48 INCHES IN UNOBSTRUCTED WIDTH
 - ACCESSIBLE PARKING SPACES AND ACCESS AISLES SHALL NOT EXCEED 2% SLOPE IN ANY DIRECTION
 - LANDINGS AT THE TOP AND BOTTOM OF ACCESSIBLE RAMPS SHALL NOT EXCEED 2% SLOPE IN ANY DIRECTION
 - GUTTERS AND ROAD SURFACES DIRECTLY ADJACENT TO AND WITHIN 2 FEET OF A CURB RAMP SHALL HAVE A COUNTER SLOPE NOT TO EXCEED 5%
- CONTRACTOR MUST IMMEDIATELY NOTIFY THE ENGINEER OF RECORD, IDENTIFIED BY THE PROFESSIONAL ENGINEERING SEAL AND SIGNATURE ON THESE PLANS, OF ANY SITE CONDITION(S) AND/OR DESIGN INFORMATION THAT PREVENTS THE CONTRACTOR FROM COMPLYING WITH THE LAWS, REGULATIONS AND/OR BUILDING CODES GOVERNING ADA ACCESS COMPLIANCE.
- DRAINAGE SHALL NOT BE ALLOWED ONTO ADJACENT PROPERTY.
- ALL FILL MATERIAL USED SHALL BE PLACED IN COMPLIANCE WITH THE PROJECT SPECIFICATIONS. A SOILS COMPACTION REPORT SHALL BE SUBMITTED TO THE ENGINEER OF RECORD AS REQUIRED BY THE PROJECT SPECIFICATIONS.
- THE CONTRACTOR SHALL IMPLEMENT DUST CONTROL MEASURES AS REQUIRED BY THE PROJECT SPECIFICATIONS, AND BY GOVERNING PUBLIC AGENCIES.
- THE CONTRACTOR SHALL LOCATE ALL EXISTING UTILITIES PRIOR TO START OF ANY WORK.
- CONTRACTOR SHALL NOTIFY THE SCHOOL DISTRICT TO TURN OFF IRRIGATION A MINIMUM OF 2 DAYS PRIOR TO STARTING WORK. CONTRACTOR SHALL COORDINATE WITH THE SCHOOL DISTRICT THROUGHOUT THE COURSE OF THE PROJECT FOR WATERING AND NON-WATERING TIMES. CONTRACTOR SHALL NOTIFY THE DISTRICT AS SOON AS WORK IS COMPLETED TO THE POINT WHERE IRRIGATION SYSTEMS MAY BE TURNED BACK ON.
- ENSURE THAT ALL EXISTING STRIPING IS NOT VISIBLE AFTER APPLYING SEAL COAT AND PRIOR TO RESTRIPING AND REPAINTING. OTHERWISE, ADDITIONAL SEAL COAT APPLICATION MAY BE REQUIRED.
- PRIOR TO ACCEPTANCE OF NEW PAVING AND APPLICATION OF SEAL COAT AND/OR STRIPING, THE CONTRACTOR SHALL COMPLETE A WATER TEST OF THE NEW PAVEMENT WITH THE ENGINEER OF RECORD PRESENT TO VERIFY THAT NO LOW SPOTS OR "BIRD BATHS" ARE PRESENT, PER THE PROJECT SPECIFICATIONS.
- LAYOUT ALL PAVEMENT MARKINGS TO MATCH EXISTING UNLESS NOTED OTHERWISE ON PLANS.
- PAINT ALL CURBS AND WHEELSTOPS TO MATCH EXISTING WITHIN PROJECT LIMITS, UNLESS SHOWN OTHERWISE ON THE PLANS.
- ALL CONCRETE SHALL HAVE WEAKENED PLANE JOINTS AT 10 FEET OR LESS ON CENTER AND ONE HALF INCH PREMOLDED EXPANSION JOINTS AT 30 FEET OR LESS MINIMUM. MATCH EXISTING SCORE PATTERN DIMENSIONS ON ALL CONCRETE WALKS AND PAVEMENT.
- NO CONCRETE MAY BE POURED UNTIL ALL FORMS AND REINFORCEMENTS HAVE BEEN REVIEWED AND APPROVED BY THE PROJECT INSPECTOR.
- REPLACE ALL DAMAGED TURF AND IRRIGATION FACILITIES RESULTING FROM THE WORK REQUIRED.
- ADJUST ALL UTILITY LIDS TO FINISHED GRADE WITHIN CONSTRUCTION AREA PER DETAIL [F/PDX-1] UNLESS NOTED OTHERWISE. REMOVE AND REPLACE ALL BROKEN OR DAMAGED LIDS AND BOXES. ALL LIDS WITHIN TRAFFIC AREAS SHALL BE TRAFFIC RATED.
- ANY EXISTING UTILITIES AND/OR IMPROVEMENTS WHICH ARE TO REMAIN, THAT BECOME DAMAGED DURING CONSTRUCTION SHALL BE COMPLETELY RESTORED TO THE SATISFACTION OF THE OWNER AND AGENCY HAVING AUTHORITY, AT THE CONTRACTOR'S SOLE EXPENSE.
- ANY EXISTING UTILITIES AND/OR IMPROVEMENTS THAT BECOME DAMAGED DURING CONSTRUCTION SHALL BE COMPLETELY RESTORED TO THE SATISFACTION OF THE OWNER AND AGENCY HAVING AUTHORITY, AT THE CONTRACTOR'S SOLE EXPENSE.
- CONTRACTOR TO MATCH EXISTING PAVEMENT GRADE AT ALL NEW PAVEMENT LOCATIONS UNLESS NOTED OTHERWISE ON THE PLANS.
- ASPHALT CONCRETE REMOVAL AND REPLACEMENT LIMITS SHOWN ARE APPROXIMATE AND ARE BASED ON PAVEMENT CONDITIONS OBSERVED DURING A PRE-DESIGN SITE REVIEW. ADJUST LOCATIONS AND LIMITS AS REQUIRED BY ACTUAL FIELD CONDITIONS OR AS DIRECTED BY THE ENGINEER.
- INSTALL DOWELED CONNECTION AT JOINT OF NEW CONCRETE TO EXISTING CONCRETE PER DETAIL [G/PDX-1]
- TREAT ALL JOINTS BETWEEN EXISTING ASPHALT AND PAVEMENT SURFACES PER DETAIL [K/PDX-1]

GENERAL NOTES:

- ALL WORK SHALL BE DONE IN ACCORDANCE WITH THESE CONSTRUCTION DRAWINGS, THE CONTRACT SPECIFICATIONS AND, WHERE APPLICABLE, THE CITY STANDARDS AND THE STATE OF CALIFORNIA STANDARD SPECIFICATIONS.
- THE CONTRACTOR SHALL COORDINATE ALL CONSTRUCTION ACTIVITIES WITH THE SCHOOL DISTRICT'S USE OF THE FACILITIES AND OTHER CONTRACTORS WHO MAY BE DOING CONSTRUCTION WITHIN THE PROJECT SITE.
- THE CONTRACTOR SHALL CONTACT DISTRICT OFFICIALS FOR DETERMINATION OF DEPTH AND LOCATION OF UNDERGROUND UTILITIES PRIOR TO EXCAVATION IN THE PROJECT SITE.
- BEFORE COMMENCING WORK, THE CONTRACTOR SHALL NOTIFY ALL UTILITY AUTHORITIES OR UTILITY COMPANIES HAVING POSSIBLE INTEREST IN THE WORK OF THE CONTRACTOR'S INTENTION TO EXCAVATE PROXIMATE TO EXISTING FACILITIES AND THE CONTRACTOR SHALL VERIFY THE LOCATION OF ANY UTILITIES IN THE WORK AREA, NOTIFY U.S.A. AT 1(800) 642-2444, TWO (2) DAYS PRIOR TO EXCAVATION.
- ALL CONSTRUCTION SHALL CONFORM TO THE REQUIREMENTS OF THE MOST CURRENT CALIFORNIA BUILDING CODE (CBC).
- CHANGES TO THE APPROVED DRAWINGS AND SPECIFICATIONS SHALL BE MADE BY ADDENDA OR CONSTRUCTION CHANGE DOCUMENT (CCD) APPROVED BY DSA, AS REQUIRED BY SECTION 4-338, PART 1, TITLE 24, CCR.
- A "DSA CERTIFIED" CLASS 3 PROJECT INSPECTOR EMPLOYED BY THE DISTRICT (OWNER) AND APPROVED BY DSA SHALL PROVIDE CONTINUOUS INSPECTION OF THE WORK. THE DUTIES OF THE INSPECTOR ARE DEFINED IN SECTION 4-342, PART 1, TITLE 24, CCR.
- A DSA-ACCEPTED TESTING LABORATORY DIRECTLY EMPLOYED BY THE DISTRICT (OWNER) SHALL CONDUCT ALL THE REQUIRED TESTS AND INSPECTIONS FOR THE PROJECT.
- THE INTENT OF THESE DRAWINGS AND SPECIFICATIONS IS THAT THE WORK OF THE ALTERATION, REHABILITATION OR RECONSTRUCTION SHALL BE IN ACCORDANCE WITH TITLE 24, CCR. SHOULD ANY EXISTING CONDITIONS SUCH AS DETERIORATION OR NON-COMPLYING CONSTRUCTION BE DISCOVERED WHICH IS NOT COVERED BY THE CONTRACT DOCUMENTS WHEREIN THE FINISHED WORK WILL NOT COMPLY WITH TITLE 24, CCR, A CONSTRUCTION CHANGE DOCUMENT (CCD), OR A SEPARATE SET OF PLANS AND SPECIFICATIONS, DETAILING AND SPECIFYING THE REQUIRED WORK SHALL BE SUBMITTED TO AND APPROVED BY DSA BEFORE PROCEEDING WITH THE WORK (SECTION 4-317(C), PART 1, TITLE 24, CCR).
- GRADING PLANS, DRAINAGE IMPROVEMENTS, ROAD AND EMERGENCY ACCESS REQUIREMENTS AND ENVIRONMENTAL HEALTH CONSIDERATIONS SHALL COMPLY WITH ALL LOCAL ORDINANCES.

GENERAL DEMOLITION NOTES:

- THE "LIMIT OF DEMOLITION" SHOWN IS APPROXIMATE AND IS GENERALLY CONSIDERED TO BE THE MINIMUM REMOVAL REQUIREMENTS. CONTRACTOR MUST COORDINATE AS NOTED IN THE LEGEND.
- CONTRACTOR SHALL LEGALLY DISPOSE OF ALL DEMOLISHED MATERIALS OFF SITE.
- CONTRACTOR SHALL PROTECT ALL EXISTING UTILITY IMPROVEMENTS NOT SPECIFICALLY DESIGNATED FOR REMOVAL.
- THE ON-SITE UNDERGROUND UTILITIES SHOWN ON THIS SHEET ARE AT APPROXIMATE LOCATIONS. THE EXTENT, LOCATIONS AND SIZES ARE UNKNOWN. THE CONTRACTOR SHALL POT-HOLE TO LOCATE AND VERIFY THE UNDERGROUND UTILITY LINES PRIOR TO REMOVAL.
- CONTRACTOR TO PROTECT AND PRESERVE IN PLACE ANY FOUND SURVEY MONUMENTS. ANY MONUMENTS DISTURBED SHALL BE RESET BY A CALIFORNIA LICENSED SURVEYOR AND THE APPROPRIATE PAPERWORK FILED WITH THE CITY OR COUNTY, AT CONTRACTOR'S EXPENSE.
- ALL HAZARDOUS MATERIALS ENCOUNTERED DURING SITE DEMOLITION SHALL BE REMEDIATED AND DISPOSED OF PER STATE AND EPA REQUIREMENTS.
- REMOVE EXISTING IMPROVEMENTS AS NECESSARY TO CONSTRUCT NEW IMPROVEMENTS SHOWN ON THESE PLANS.
 - FOR CONCRETE REMOVAL, REMOVE TO THE NEXT NEAREST TOOLED JOINT OR EXPANSION JOINT OF IMPROVEMENTS DESIGNATED TO REMAIN.
 - FOR ASPHALTIC PAVEMENT REMOVAL, SAWCUT TO A STRAIGHT, CLEAN EDGE AT LOCATIONS INDICATED ON THE PLANS.
- REMOVE ALL WHEELSTOPS PRIOR TO SEAL COAT APPLICATION

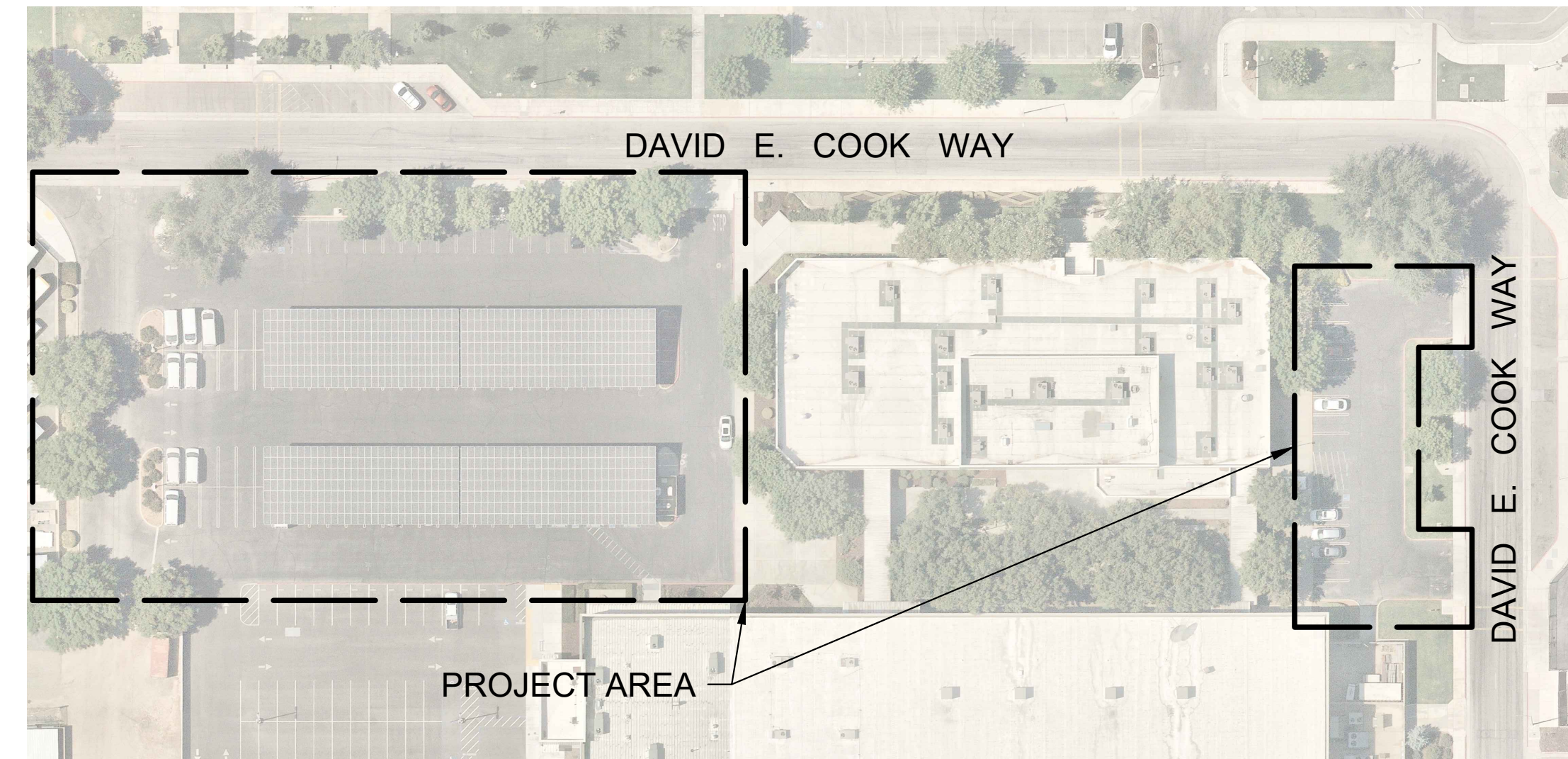

SITE MAP

NOT TO SCALE

SITE ADDRESS

1680 DAVID E. COOK WAY
CLOVIS, CA 93611

PROJECT CONTACTS:

OWNER: CLOVIS UNIFIED SCHOOL DISTRICT
1450 HERNDON AVE
CLOVIS, CA 93611
PHONE: (559) 327-9000

CIVIL ENGINEER: BLAIR, CHURCH & FLYNN
CONSULTING ENGINEERS
451 CLOVIS AVE., SUITE 200
CLOVIS, CA 93612
PHONE: (559) 326-1400

SCOPE OF WORK:

- PARTIAL ASPHALT REPLACEMENT, SEAL COAT, AND STRIPE EXISTING PARKING LOT 'A'; ACCESSIBILITY UPGRADES INCLUDING NEW ACCESSIBLE PARKING SIGNAGE.
- FULL ASPHALT REPLACEMENT AND STRIPE EXISTING PARKING LOT 'B'; ACCESSIBILITY UPGRADES INCLUDING NEW ACCESSIBLE PARKING STALLS, SIGNAGE, AND PARRALLEL CURB RAMP.

APPLICABLE CODES:

2019 CALIFORNIA ADMIN. CODE, TITLE 24, PART 1, CCR
2019 CALIFORNIA BUILDING CODE, TITLE 24, PART 2, CCR

TABLE OF CONTENTS	
SHEET NUMBER	SHEET TITLE
PD-00	COVER SHEET
PD-01	ACCESS COMPLIANCE PLAN
PD-10	TOPOGRAPHIC SURVEY LEGEND
PD-11	TOPOGRAPHIC SURVEY
PD-20	DEMOLITION PLAN
PD-30	SITE PLAN
PD-31	SITE AND GRADING PLAN
PDX-1	DETAILS
PDX-2	DETAILS
TOTAL SHEET COUNT: 9	

CONTRACTOR AGREES THAT IN ACCORDANCE WITH GENERALLY ACCEPTED CONSTRUCTION PRACTICES CONTRACTOR ASSUMES SOLE AND COMPLETE RESPONSIBILITY FOR JOB SITE CONDITIONS DURING THE PERFORMANCE OF WORK, INCLUDING SAFETY OF ALL PERSONS AND PROPERTY, ON A CONTINUOUS BASIS NOT LIMITED TO NORMAL WORKING HOURS. CONTRACTOR FURTHER AGREES TO DEFEND, INDEMNIFY AND HOLD HARMLESS BLAIR, CHURCH & FLYNN CONSULTING ENGINEERS FROM ANY AND ALL LIABILITY, REAL OR ALLEGED, IN CONNECTION WITH THE PERFORMANCE OF WORK ON THIS PROJECT, EXCEPTING LIABILITY ARISING FROM THE SOLE NEGLIGENCE OF BLAIR, CHURCH & FLYNN CONSULTING ENGINEERS.



Know what's below.
Call before you dig.

Blair,
Church
& Flynn
CONSULTING ENGINEERS

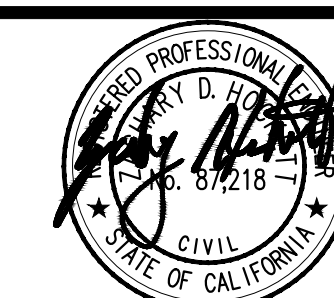

CONSULTANT
Blair, Church & Flynn
Consulting Engineers
451 Clovis Avenue,
Suite 200
Clovis, California 93612
Tel (559) 326-1400
Fax (559) 326-1500

REF. & REV.

CLOVIS UNIFIED SCHOOL DISTRICT

2022 PAVEMENT REHABILITATION
VARIOUS SITES
PROFESSIONAL DEVELOPMENT
COVER SHEET

CONST. DOCUMENTS
DR. BY: AH
CH. BY: JF
DATE: 01/21/2022
SCALE AS NOTED
PD-00

IDENTIFICATION STAMP
 DIV. OF THE STATE ARCHITECT
 APP: 02-119793 INC:
 REVIEWED FOR
 SS FLS ACS
 DATE: 04/04/2022

FOR DSA USE ONLY
 APP # 02-119793

- SITE LEGEND:**
- ① LIMITS OF WORK
 - ② ACCESSIBLE STALLS PER THIS APPLICATION
 - ③ ACCESSIBLE PARKING SIGNAGE PER THIS APPLICATION
 - ④ ENTRY TOW AWAY SIGN PER THIS APPLICATION
 - ⑤ EXISTING ACCESSIBLE PARKING SIGNAGE THAT MEETS THE MINIMUM REQUIREMENTS OF DETAIL [C/PDX-2]
 - ⑥ ACCESSIBLE PARALLEL CURB RAMP PER THIS APPLICATION
 - ⑦ EXISTING ACCESSIBLE FLARED CURB RAMP THAT MEETS THE MINIMUM REQUIREMENTS OF [A/PD-01]

- NOTES:**
- DESIGN PROFESSIONAL IN GENERAL RESPONSIBLE CHARGE STATEMENT: THE PATH-OF-TRAVEL (P.O.T.) IDENTIFIED IN THESE CONSTRUCTION DOCUMENTS IS COMPLIANT WITH THE CURRENT APPLICABLE CALIFORNIA BUILDING CODE ACCESSIBILITY PROVISIONS FOR PATH OF TRAVEL REQUIREMENTS FOR ALTERATIONS, ADDITIONS AND STRUCTURAL REPAIRS. AS PART OF THE DESIGN OF THIS PROJECT, THE P.O.T. WAS EXAMINED AND ANY ELEMENTS, COMPONENTS OR PORTIONS OF THE P.O.T. THAT WERE DETERMINED TO BE NON-COMPLIANT 1) HAVE BEEN IDENTIFIED AND 2) THE CORRECTIVE WORK NECESSARY TO BRING THEM INTO COMPLIANCE HAS BEEN INCLUDED WITHIN THE SCOPE OF THIS PROJECT'S WORK THROUGH DETAILS, DRAWINGS, AND SPECIFICATIONS INCORPORATED INTO THESE CONSTRUCTION DOCUMENTS. ANY NON-COMPLIANT ELEMENTS, COMPONENTS OR PORTIONS OF THE P.O.T. THAT WILL NOT BE CORRECTED BY THIS PROJECT BASED ON VALUATION THRESHOLD LIMITATIONS OR A FINDING OF UNREASONABLE HARDSHIP ARE SO INDICATED IN THESE CONSTRUCTION DOCUMENTS.
 DURING CONSTRUCTION, IF P.O.T. ITEMS WITHIN THE SCOPE OF THE PROJECT REPRESENTED AS CODE COMPLIANT ARE FOUND TO BE NON-COMPLYING BEYOND REASONABLE CONSTRUCTION TOLERANCES, THEY SHALL BE BROUGHT INTO COMPLIANCE WITH THE CBC AS A PART OF THIS PROJECT BY MEANS OF A CONSTRUCTION CHANGE DOCUMENT.
 - THE ENGINEER HAS SURVEYED/INSPECTED THE PATH OF TRAVEL (P.O.T.) AS INDICATED ON THE PLANS AND HAS FOUND IT TO BE, OR HAS INDICATED ON THE PLANS REMEDIAL WORK WHICH WOULD CAUSE IT TO BE, A BARRIER FREE ACCESSIBLE ROUTE:
 - AT LEAST 48" IN WIDTH, OR AS APPROVED BY CODE, WITHOUT ABRUPT LEVEL CHANGES EXCEEDING 1/2" IF BEVELED AT 1:2 MAXIMUM SLOPE, OR VERTICAL LEVEL CHANGES EXCEEDING 1/4".
 - WITH A FIRM, STABLE, AND SLIP RESISTANT WALKING SURFACE, WITH A RUNNING SLOPE OF 1:20 OR LESS, UNLESS OTHERWISE INDICATED, AND A CROSS SLOPE OF 1:48 OR LESS.
 - IS FREE OF OVERHEAD OBSTRUCTIONS WITHIN 80" ABOVE THE WALKING SURFACE.
 - IS FREE OF OBJECTS WHICH PROTRUDE MORE THAN 4" BETWEEN THE HEIGHTS OF 27" AND 80" ABOVE THE WALKING SURFACE.

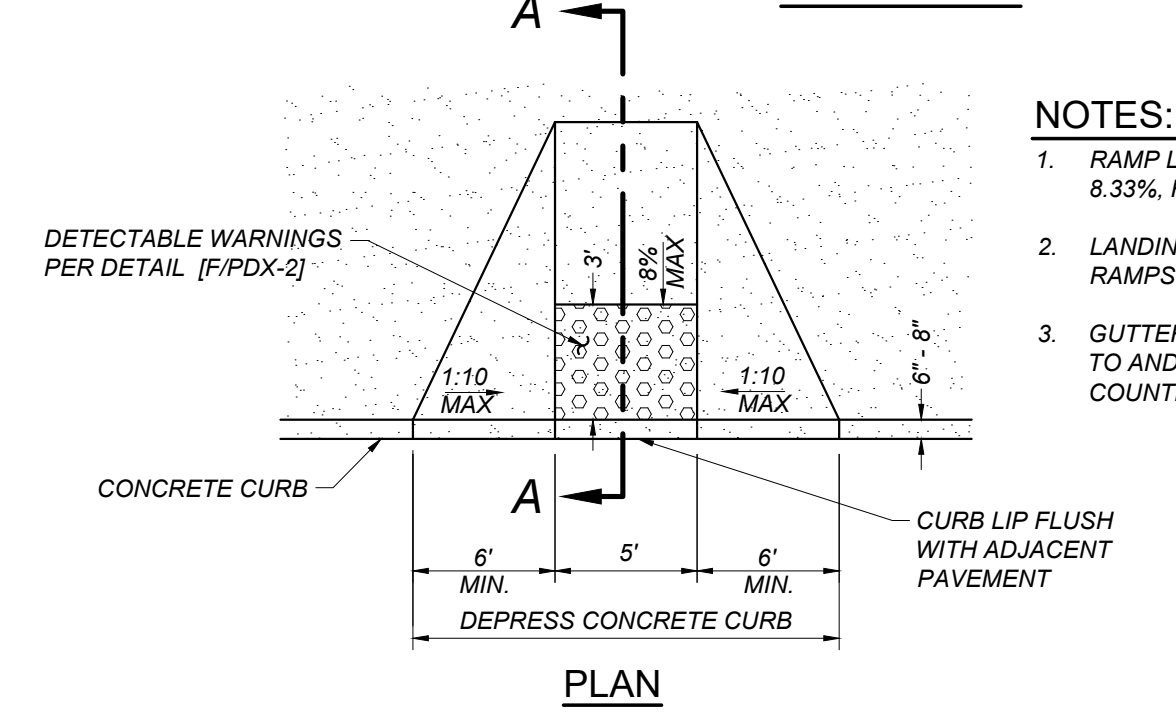
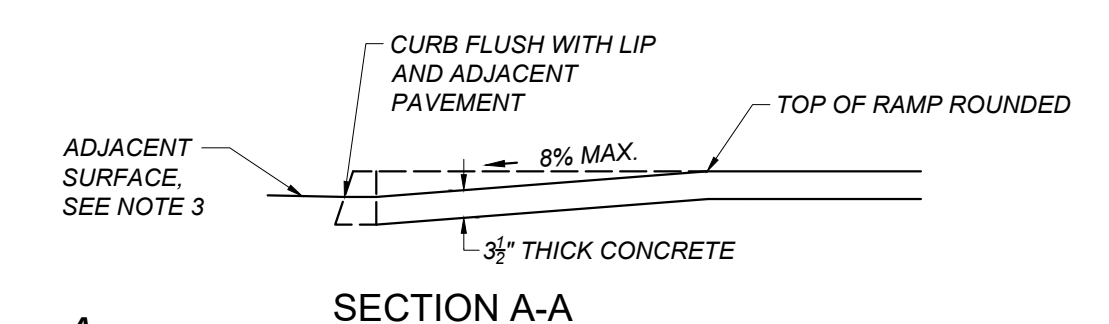
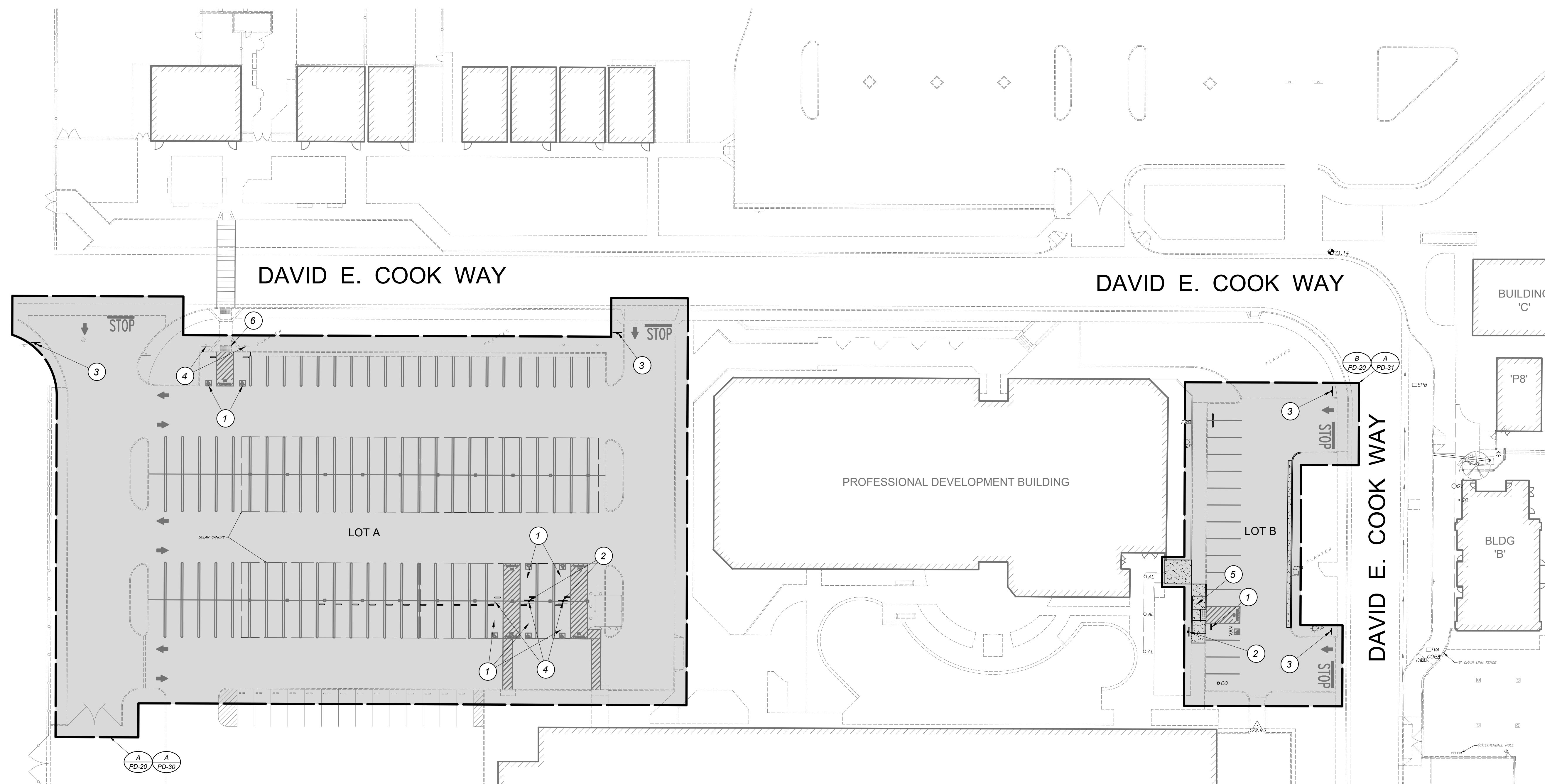

- NOTES:**
- RAMP LONGITUDINAL SLOPES SHALL NOT EXCEED 8.33%. RAMP CROSS SLOPES SHALL NOT EXCEED 2%.
 - LANDINGS AT THE TOP AND BOTTOM OF ACCESSIBLE RAMPS SHALL NOT EXCEED 2% IN ANY DIRECTION.
 - GUTTERS AND ROAD SURFACES DIRECTLY ADJACENT TO AND WITHIN 2 FEET OF A CURB RAMP MAY HAVE A COUNTER SLOPE NOT EXCEEDING 5%.

A
PD-01
 FLARED CURB RAMP
 NOT TO SCALE

PARKING CALCULATIONS

LOT#	DSA APP #	STALLS PROVIDED	ACCESSIBLE STALLS PROVIDED	ACCESSIBLE STALLS REQUIRED PER CBC 11-B208.2
A		126	7 TOTAL, 2 VAN	5 TOTAL, 1 VAN
B		15	1 TOTAL, 1 VAN	1 TOTAL, 1 VAN

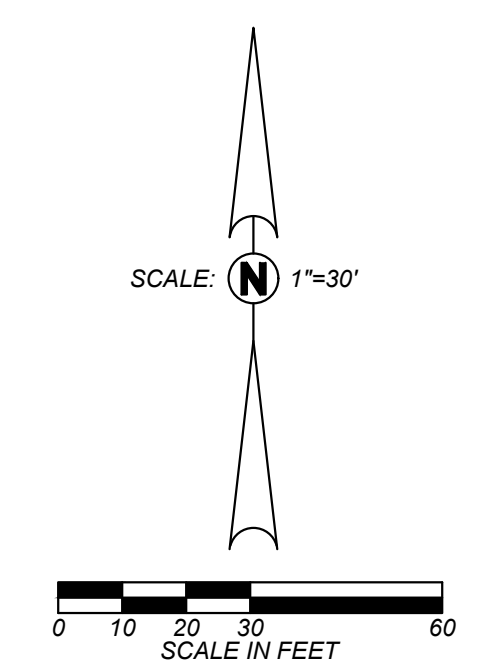

Blair,
Church &
Flynn
CONSULTING ENGINEERS

CONSULTANT

Blair, Church & Flynn
Consulting Engineers
451 Clovis Avenue,
Suite 200
Clovis, California 93612
Tel (559) 326-1400
Fax (559) 326-1500

REF. & REV.

CLOVIS UNIFIED SCHOOL DISTRICT

2022 PAVEMENT REHABILITATION
 VARIOUS SITES
 PROFESSIONAL DEVELOPMENT
 ACCESS COMPLIANCE PLAN

CONST. DOCUMENTS

DR. BY: AH
 CH. BY: JF
 DATE: 01/21/2022
 SCALE AS NOTED

PD-01

GENERAL TOPOGRAPHIC SURVEY LEGEND:

(NOT ALL SYMBOLS SHOWN APPEAR ON THE PLANS)

AB	ABUTMENT	RIES	RIPARIAN EDGE OF STREAM		ELECTRICAL METER	+4 TEL	TELEPHONE; DIAMETER AS SHOWN	=====	DRAIN TUBE
AC	ASPHALTIC CONCRETE	RIEW	RIPARIAN EDGE OF WETLAND		ELECTRICAL PULLBOX	⊙	TELEPHONE MANHOLE	—HW 2"	HOT WATER LINE; SIZE AS NOTED
ACE	ASPHALTIC CONCRETE EDGE	RIFL	RIPARIAN FLOWLINE		ELECTRICAL VAULT LID	⊙ 7W	TENNIS NET POLE	—HWR 2"	HOT WATER RETURN LINE; SIZE AS NOTED
AD	ASPHALTIC CONCRETE DIKE	RIMC	RIPARIAN MISC.	+ EFS	GAS ELECTRONIC TESTING STATION	⊙ TP	TELEPHONE POLE	—HWS 2"	HOT WATER SUPPLY LINE; SIZE AS NOTED
AWT	ALL-WEATHER TRACK	RIP	RIP-RAP SLOPE PROTECTION	⊙ FOC	FIRE DEPARTMENT CONNECTION	⊙ TPB	TELEPHONE PULLBOX	—HYD	HYDRAULIC LINE
BD	BRIDGE DECK	RR	ROCK	⊙	FIRE HYDRANT		TELEVISION PULLBOX	—ID 18"	IRRIGATION DISTRICT; SIZE AS NOTED
BFC	BOTTOM FACE OF CURB	RW	RETAINING WALL	⊙ FP	FENCE POST		TREE; SPREAD SHOWN GRAPHICALLY AND TRUNK DIAMETER AS SHOWN	—IRR 2"	IRRIGATION MAIN LINE; SIZE AS NOTED
BGST	BOTTOM FACE OF CURB	SB	SPEED BUMP	⊙ FPD	FLAG POLE		PALM TREE; SPREAD SHOWN GRAPHICALLY	—L 1"	IRRIGATION LATERAL LINE; SIZE AS NOTED
BGST	STEPS	SDCO	STORM DRAIN CROSS DRAIN	+ GAS	GAS LINE; DIAMETER AS SHOWN		TELEPHONE SPLICE BOX	—ITS	INTELLIGENT TRAFFIC SYSTEM
BGTR	TOP OF ROOF	SDFL	STORM DRAIN FLOWLINE	⊙ GR	GAS REGULATOR	⊙ TSP	TRAFFIC SIGNAL POLE	—JT	JOINTLY TRENCHED UTILITIES
BGV	BUILDING VENTS	SDGR	STORM DRAIN GRATE		GAS METER		TELEPHONE PULLBOX	—OC	OVERHEAD COMMUNICATIONS LINE
BOD	BOTTOM OF DITCH	SDMG	STORM DRAIN MANHOLE W/ GRATE		GAS VALVE		TELEVISION PULLBOX	—OE	OVERHEAD ELECTRIC LINE
BRK	BARRICADE	SSFL	SEWER FLOWLINE	⊙ GGP	GOAL POST	⊙ UP	UTILITY POLE	—OEC	OVERHEAD ELECTRIC AND COMMUNICATION LINE
BRK	BRICK	SDTH	STORM DRAIN TRENCH	⊙ GP	GUY POLE	+ VB	VACUUM BREAKER	—OET	OVERHEAD ELECTRIC AND TELEPHONE LINE
BW	BARRIER WALL	SSGT	STORM DRAIN GREASE TRAP	+ GSR	GRATE; DIAMETER AS SHOWN	⊙ VP	VOLLEYBALL NET POST	—OEV	OVERHEAD ELECTRIC AND TELEVISION LINE
CB	CATCH BASIN	SSST	SEWER TANK (SEPTIC)	+ GS	GATE STOP	+ W	WENT PIPE; DIAMETER AS SHOWN	—OETV	OVERHEAD ELECTRIC, TELEVISION AND TELEPHONE LINE
CDA	CONCRETE DRIVE APPROACH	SSTH	SEWER TRENCH	+ GSR	GAS RISER	+ W	WELL	—OTS	OVERHEAD TRAFFIC SIGNAL LINE
CE	CONCRETE EDGE	SWK	SIDEWALK	⊙ GV	GAS VALVE	+ W	WATER METER	—OTV	OVERHEAD TELEVISION LINE
CMP	CORRUGATED METAL PIPE	SWL	SWALE	+ GRD	GROUNDING ROD		WELL PUMP	—OU	OVERHEAD TELEVISION LINE
CON	CONCRETE	T	TURF		GUY WIRE		CIRCULAR WOOD POST; DIAMETER AS SHOWN	—P 8"	PETROLEUM LINE; SIZE AS NOTED
COTH	COMMUNICATION TRENCH	TBC	TOP BACK OF CURB	+ HB	HOSE BIBB		SQUARE WOOD POST; SIZE AS SHOWN	—RW 2"	RECYCLED WATER IRRIGATION LINE; SIZE AS NOTED
CR	CROWN OF ROAD	TBW	TOP BACK OF WALK	+ HR	HANDRAIL	+ W	WATER LINE; DIAMETER AS SHOWN	—S&SD 8"	SEWER AND STORM DRAIN LINE; SIZE AS NOTED
CRQ	QUARTER CROWN	TF	TOP OF FOOTING	⊙ GR	IRRIGATION CONTROLLER	⊙ W	WATER VALVE	—SFU 8"	SEWER FORCE MAIN; SIZE AS NOTED
CS	CONCRETE SLAB	TRC	TOP FACE OF CURB		IRRIGATION DISTRICT MANHOLE		ASPHALT PAVEMENT	—ST 2"	STEAM LINE; SIZE AS NOTED
CULV	CULVERT	TRW	TOP FACE OF WALK		IRRIGATION REMOTE CONTROL VALVE		CONCRETE BLOCK WALL	—TFO	TRAFFIC FIBER OPTIC LINE
CW	CONCRETE WALL	TLTH	TELEPHONE TRENCH		IRRIGATION SPLICE BOX		CONCRETE	—TS	TRAFFIC SIGNAL LINE
DD	DOWN DRAIN	TOB	TOP OF BANK	⊙ IB	IN-GROUND HOSE BIBB		DETECTABLE WARNINGS	—TV	TELEVISION LINE
DFL	DITCH FLOWLINE	TOE	TOE OF SLOPE	+ IP	IRON PIPE		DG OR GRAVEL	—UNK	UNKNOWN UTILITY LINE
DHY	DRIVEWAY	TOP	TOP OF SLOPE		JOINT UTILITY POLE		CHAIN LINK FENCE	—X X	WIRE FENCE
EOTH	ELECTRICAL TRENCH	TRDO	TRUNCATED DOMES		LIGHT POLE		CHAIN LINK ROLL GATE	—	PROPERTY LINE
EDR	EDGE OF DIRT ROAD	TVTH	TV TRENCH		MAIL BOX		EDGE OF ASPHALT PAVEMENT	—	CITY LIMIT
EDR	EDGE OF GRAVEL ROAD	TW	TOP OF WALL		MANHOLE		WOOD FENCE	—	EASEMENT 1
EGD	EDGE OF OILED DIRT	UTH	UNIDENTIFIED TRENCH/SCAR LINE		MANUAL IRRIGATION VALVE		DIRECTION OF FLOW	—	EASEMENT 2
EP	EDGE OF PAVEMENT	VGFL	VALLEY GUTTER FLOWLINE	⊙ IR	IRRIGATION REMOTE CONTROL VALVE		UNDERGROUND ELECTRIC	—	RIGHT-OF-WAY LINE
ES	EDGE OF SHOULDER	VGR	VALLEY GUTTER		POST INDICATOR VALVE		GAS LINE; SIZE AS NOTED	—	RIGHT-OF-WAY CENTER LINE
ET	EDGE OF TRAVELED WAY	WALBA	BARRIER WALL	⊙ UV	UTILITY STUB	⊙ T	OVERHEAD TELEPHONE	—	SETBACK LINE
FF	FINISH FLOOR	WALBW	BLOCK WALL	⊙ V	VACUUM BREAKER	⊙ SD 18"	STORM DRAIN LINE; SIZE AS NOTED	—	
FOTH	FIBER OPTIC TRENCH	WALCW	CONCRETE WALL		SIGN	⊙ S 12"	SEWER LINE; SIZE AS NOTED	—	
GB	GRADE BREAK	WALHW	HEAD WALL		STADIUM LIGHT POLE	⊙ T	UNDERGROUND TELEPHONE	—	
GFL	GUTTER FLOWLINE	WALRW	RETAINING WALL		STORM DRAIN MANHOLE	⊙ W 8"	WATER LINE; SIZE AS NOTED	—	
GRA	GRAVEL SPOT SHOT	WALWW	WING WALL		SIGN	⊙ AG 12"	AGRICULTURAL IRRIGATION LINE; SIZE AS NOTED	—	
GRAE	EDGE OF GRAVEL	WCR	WHEELCHAIR RAMP		SIGNAL LIGHT PUSH BUTTON	⊙ A 1"	AIR LINE; SIZE AS NOTED	—	
GSTH	GAS TRENCH	WLPD	WELL PAD		STREET LIGHT	⊙ C	COMMUNICATION LINE	—	
HDR	WOOD HEADER	WTH	WATER TRENCH		PIPE SLEEVE; DIAMETER AS SHOWN	⊙ 350	MAJOR GRADE CONTOUR LINE	—	
HW	HEAD WALL	WW	WING WALL		STREET LIGHT PULLBOX	⊙ 345	MINOR GRADE CONTOUR LINE	—	
KR	K-RAIL	(E38,21)	EXISTING ELEVATION		PIPE SLEEVE; DIAMETER AS SHOWN	⊙ CW 2"	CHILLED WATER LINE; SIZE AS NOTED	—	
LIP	LIP OF GUTTER	⊙ AL	ACCENT LIGHT		SEWER MANHOLE	⊙ CWR 2"	CHILLED WATER RETURN LINE; SIZE AS NOTED	—	
LSDE	DECOMPOSED GRANITE EDGE		ALFALFA VALVE		SERVICE POLE	⊙ CWS 2"	CHILLED WATER SUPPLY LINE; SIZE AS NOTED	—	
LSDG	DECOMPOSED GRANITE		BACKFLOW ASSEMBLY		SIGNAL PULLBOX	—	LIMIT OF DIRT	—	
LSGC	GROUND COVER		BASKETBALL GOAL		SPRINKLER	—	LIMIT OF TURF	—	
LSGF	GOLF COURSE FAIRWAY	+ BOV	BLOW-OFF VALVE		STEEL POST; DIAMETER AS SHOWN	—		—	
LSGG	GOLF COURSE GREEN		BM=BENCHMARK; OR SBM=SITE BENCHMARK		SAND SEPARATOR; SIZE AS NOTED	—		—	
LSGT	GOLF COURSE TEE	⊙ BO	BOLLARD		STAND PIPE; DIAMETER AS NOTED	—		—	
LSA	SAND	⊙ BD	BOLLARD		TREE STUMP; DIAMETER AS SHOWN	—		—	
LSSP	SLOPE PROTECTION	⊙ CD	CLEANOUT		SURVEY MONUMENT WELL	—		—	
LSST	GOLF COURSE SAND TRAP		COMMUNICATION PULLBOX						
NPTH	NON-POTABLE TRENCH		COMMUNICATION VAULT						
PA	PATIO		SURVEY CONTROL MONUMENT						
POTH	PROPANE GAS TRENCH	⊙ DF	DRINKING FOUNTAIN						
POS	POINT ON SLOPE	⊙ DS	DOORSTOP						
RCP	REINFORCED CONCRETE	⊙ DW	DRYWELL						
RIEL	RIPARIAN EDGE OF LAKE	+ EG	ELECTRICAL GROUND						
REP	RIPARIAN EDGE OF POND	+ ELC	ELECTRICAL CONDUIT						

Blair, Church & Flynn
CONSULTING ENGINEERS

CONSULTANT	REF. & REV.	CLOVIS UNIFIED SCHOOL DISTRICT	
Blair, Church & Flynn Consulting Engineers 451 Clovis Avenue, Suite 200 Clovis, California 93612 Tel (559) 326-1400 Fax (559) 326-1500		2022 PAVEMENT REHABILITATION VARIOUS SITES	CONST. DOCUMENTS
		PROFESSIONAL DEVELOPMENT TOPOGRAPHIC SURVEY LEGEND	DR. BY: AH CH. BY: JF DATE: 01/21/2022 SCALE AS NOTED
			PD-10

IDENTIFICATION STAMP
 DIV. OF THE STATE ARCHITECT
 APP: 02-119793 INC:
 REVIEWED FOR
 SS FLS ACS
 DATE: 04/04/2022

FOR DSA USE ONLY

APP # 02-119793

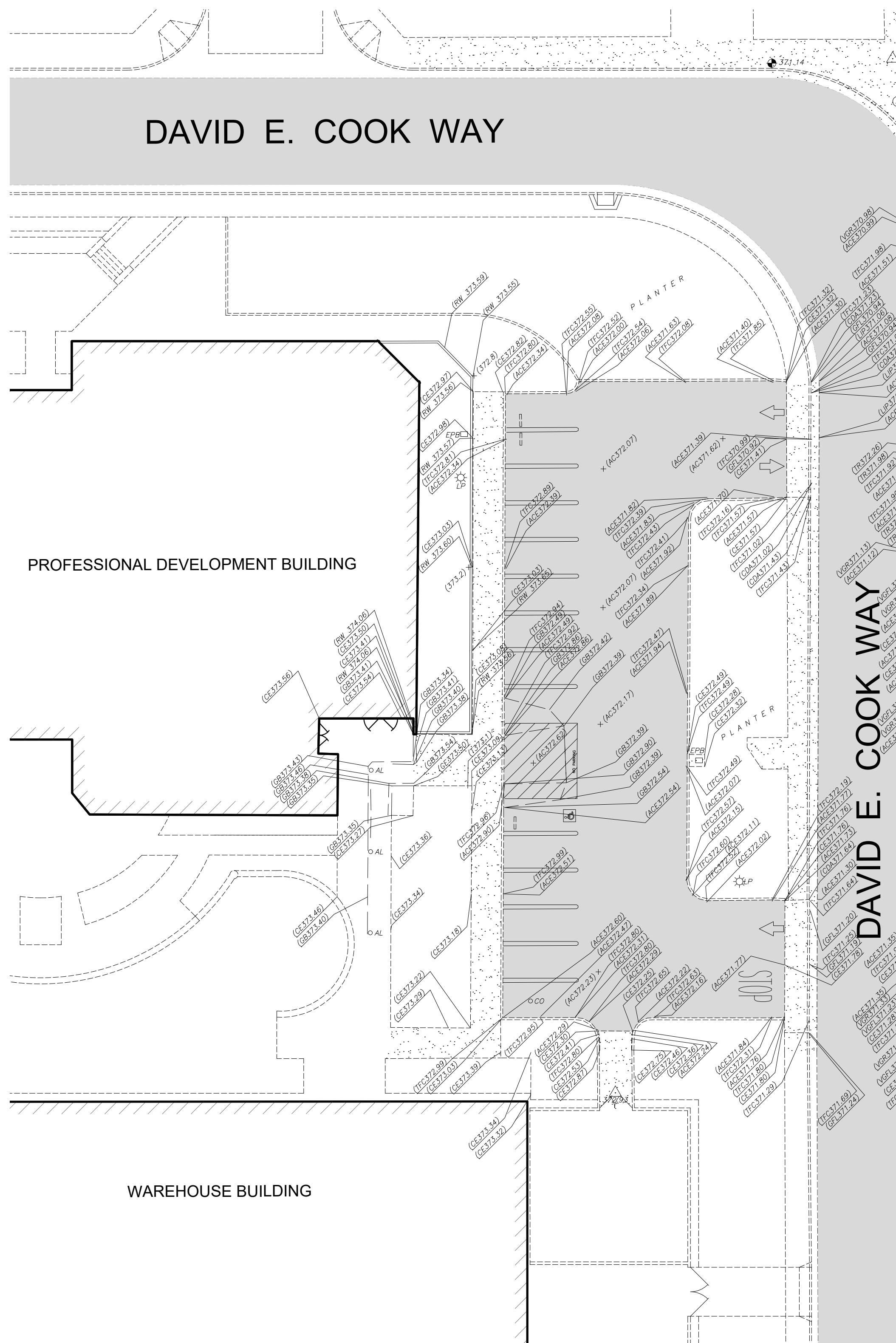

NOTE:

THIS TOPOGRAPHIC SURVEY LOCATES SPECIFIC PHYSICAL FEATURES OF THE SITE AND THEIR ELEVATION AS DETERMINED NECESSARY BY THE PROJECT ENGINEER. IT IS NOT A COMPLETE TOPOGRAPHIC SURVEY OF THE SITE. THE INFORMATION SHOWN REFLECTS THE DATA OBTAINED BY FIELD SURVEY CONDUCTED ON NOVEMBER 5, 2021.

SITE BENCHMARK:

SET CHISELED SQUARE ON THE NORTHEAST CORNER OF CURB DIRECTLY NORTH OF DAVID E. COOK WAY

ELEV = 371.14 U.S.G.S. DATUM

UTILITY NOTE:

UTILITY INFORMATION SHOWN HEREON IS BASED ON RECORD INFORMATION SUPPLIED TO THE ENGINEER BY UTILITY COMPANIES, PUBLIC AGENCIES AND THE PROPERTY OWNER, TOGETHER WITH OBSERVATION OF VISIBLE EVIDENCE BY A FIELD SURVEY. THE ENGINEER CAN MAKE NO GUARANTEE AS TO THE ACCURACY OR COMPLETENESS OF THE UNDERGROUND UTILITY FACILITIES SHOWN. PRIOR TO ANY SITE EXCAVATIONS, THE CONTRACTOR SHALL CONTACT THE OWNER AND UNDERGROUND SERVICE ALERT (USA) AND REQUEST THAT THEY IDENTIFY THE LOCATION OF ALL UNDERGROUND UTILITIES AT THE SITE.

A PARKING LOT 'B' TOPOGRAPHIC SURVEY PLAN
 PD-11

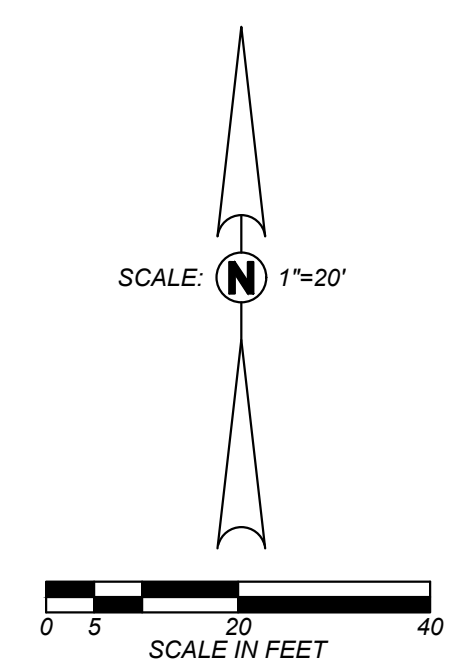

<p>Blair, Church & Flynn Consulting Engineers 455 Clovis Avenue, Suite 500 Clovis, California 93612 Tel (559) 326-1400 Fax (559) 326-1500</p>		CONSULTANT	REF. & REV.	CLOVIS UNIFIED SCHOOL DISTRICT	
		2022 PAVEMENT REHABILITATION VARIOUS SITES		CONST. DOCUMENTS	PD-11
		PROFESSIONAL DEVELOPMENT TOPOGRAPHIC SURVEY		DR. BY: AH	SCALE AS NOTED
				CH. BY: JF	
				DATE: 01/21/2022	

IDENTIFICATION STAMP
 DIV. OF THE STATE ARCHITECT
 APP: 02-119793 INC:
 REVIEWED FOR
 SS FLS ACS
 DATE: 04/04/2022

FOR DSA USE ONLY
 APP # 02-119793

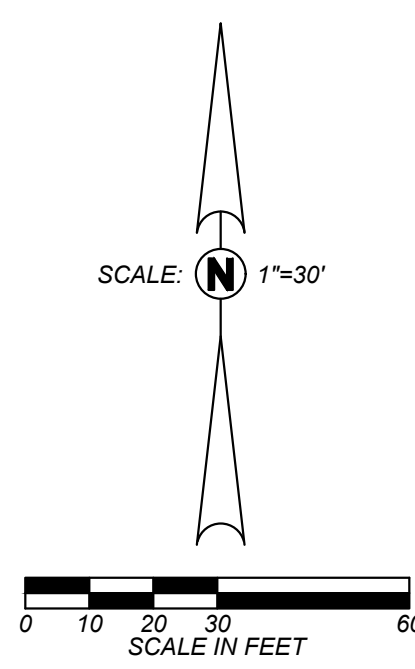
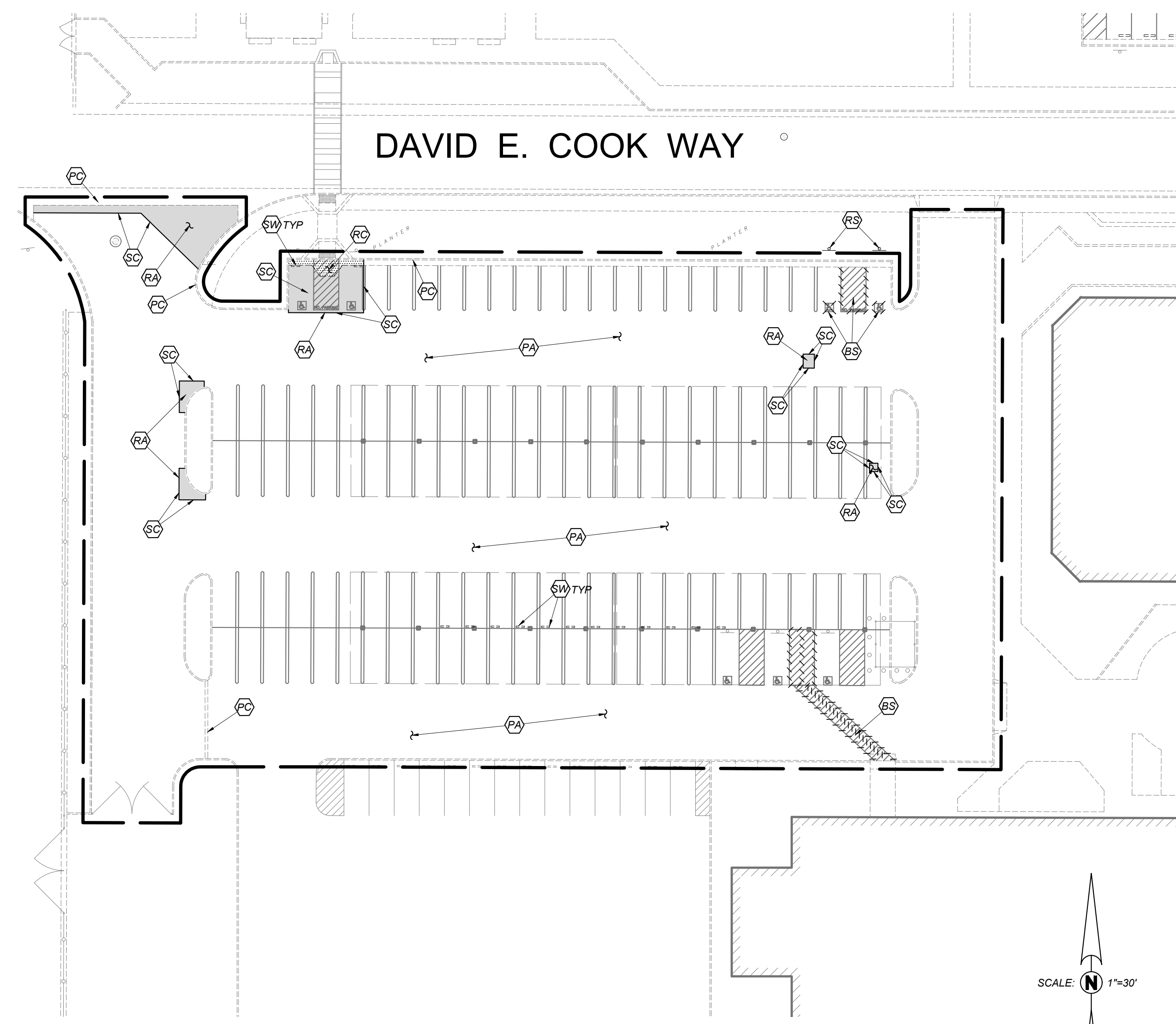

A PARKING LOT 'A' DEMOLITION PLAN
 PD-20

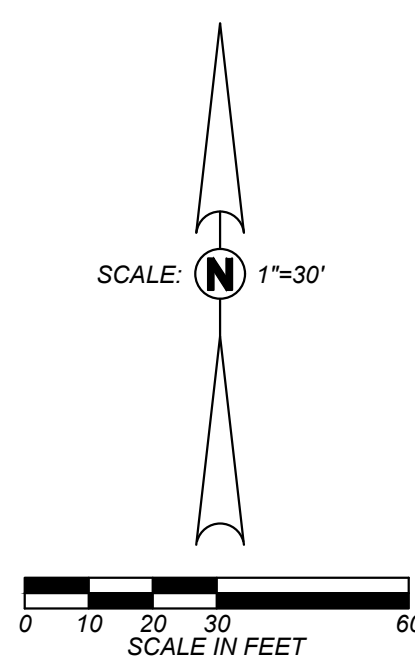
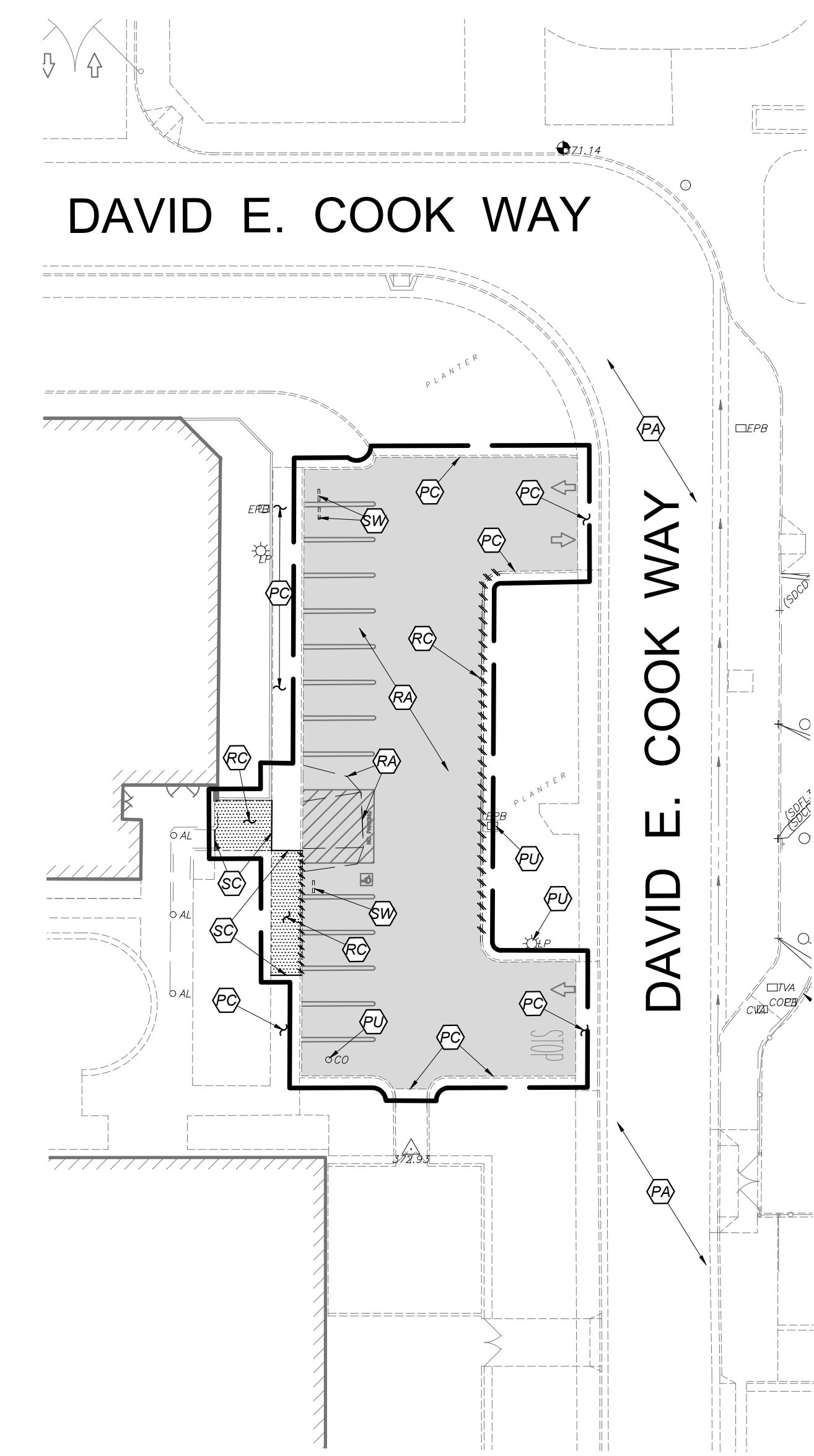

B PARKING LOT 'B' DEMOLITION PLAN
 PD-20

- DEMOLITION LEGEND:**
- APPROXIMATE LIMIT OF DEMOLITION. THE REMOVAL OF IMPROVEMENTS MUST BE COORDINATED WITH ALL PLAN SHEETS. CONTRACTOR MUST ALSO COORDINATE REMOVAL OF IMPROVEMENTS WITH UTILITY AGENCIES. PROTECT ALL IMPROVEMENTS NOT DESIGNATED FOR REMOVAL. SEE NOTE 1
 - LIMITS OF ASPHALTIC-CONCRETE IMPROVEMENT REMOVAL
 - LIMITS OF CONCRETE IMPROVEMENT REMOVAL
 - COMPLETELY COVER EXISTING STRIPING WITH BLACK PAINT PRIOR TO SEALCOAT APPLICATION
 - PROTECT EXISTING ASPHALTIC-CONCRETE PAVING TO REMAIN
 - PROTECT EXISTING CONCRETE IMPROVEMENTS TO REMAIN
 - PROTECT UTILITY TO REMAIN
 - REMOVE ASPHALT CONCRETE STRUCTURAL SECTION
 - REMOVE CONCRETE IMPROVEMENTS
 - REMOVE ACCESSIBLE PARKING SIGNAGE POST AND FOOTING
 - SAWCUT
 - SALVAGE EXISTING WHEELSTOPS FOR REINSTALLATION AFTER SEALCOAT OR NEW PAVEMENT HAS BEEN PLACED
 - LIMIT OF CURB REMOVAL

 CONSULTANT	 REF. & REV.	CLOVIS UNIFIED SCHOOL DISTRICT	
		2022 PAVEMENT REHABILITATION VARIOUS SITES PROFESSIONAL DEVELOPMENT DEMOLITION PLAN	CONST. DOCUMENTS DR. BY: AH CH. BY: JF DATE: 01/21/2022 SCALE AS NOTED
Blair, Church & Flynn Consulting Engineers 455 Clovis Avenue, Suite 500 Clovis, California 93612 Tel (559) 326-1400 Fax (559) 326-1500		PD-20	

Drawing: PD-20 (2022) 03/08/2022 09:00:00 AM
 Project: 2022 PAVEMENT REHABILITATION VARIOUS SITES
 File: PD-20.dwg, 1/24/2022, 9:00:00 AM
 Plot by: armpguzar Mar 28, 2022 - 2:15pm

DAVID E. COOK WAY

IDENTIFICATION STAMP
 DIV. OF THE STATE ARCHITECT
 APP: 02-119793 INC:
 REVIEWED FOR
 SS FLS ACS
 DATE: 04/04/2022

FOR DSA USE ONLY
 APP # 02-119793

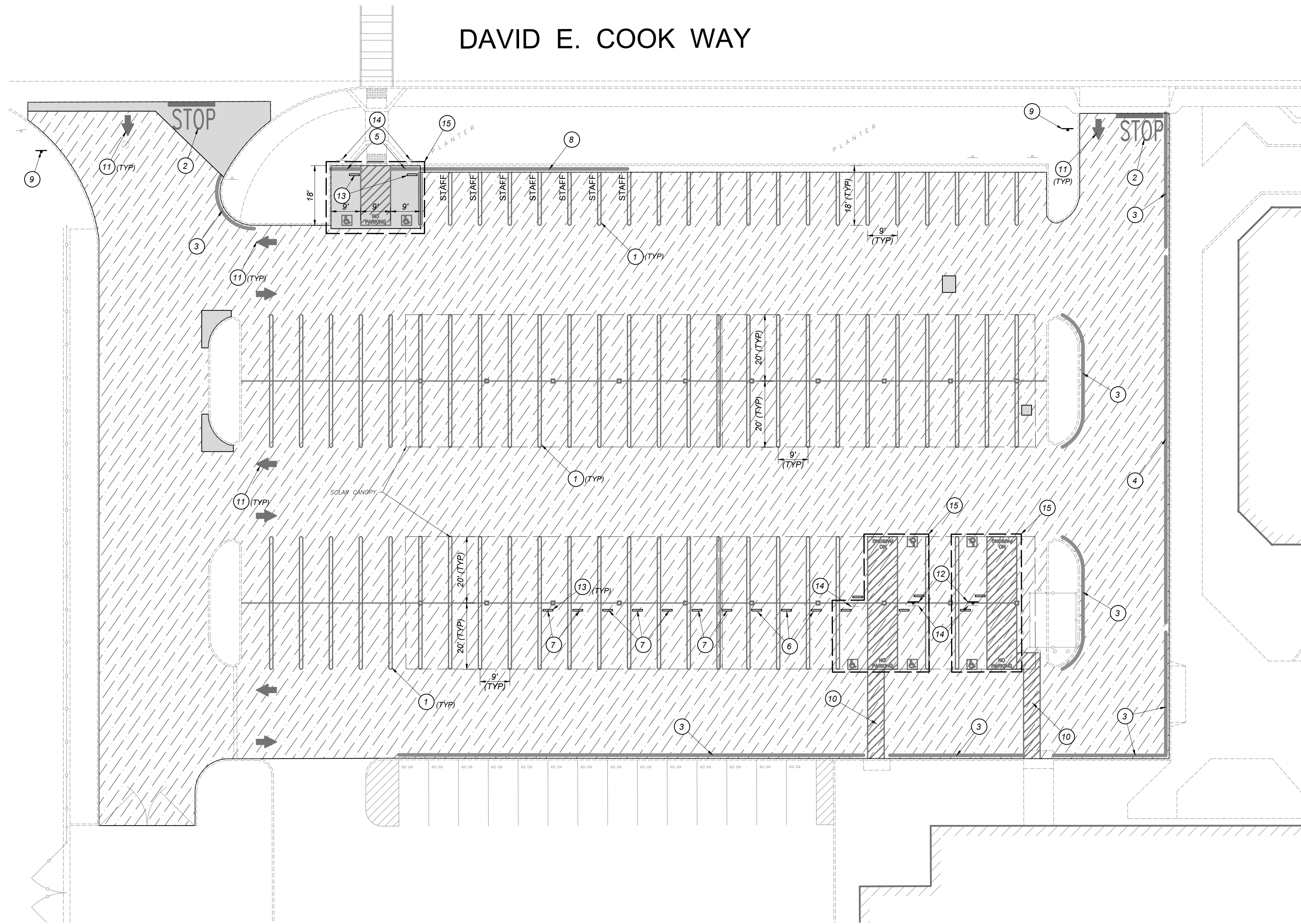

CONSTRUCTION LEGEND:

- [A/PDX-1] [DETAIL DESIGNATION / SHEET LOCATION]
- LIMITS OF CONCRETE IMPROVEMENTS
- LIMITS OF ASPHALTIC CONCRETE PAVEMENT STRUCTURAL SECTION REMOVAL AND REPLACEMENT PER PER DETAIL [A/PDX-1]
- CRACKFILL PER DETAIL [C/PDX-1] AND APPLY A SAND SLURRY SEAL COAT PER PROJECT SPECIFICATIONS
- LIMITS OF DETECTABLE WARNINGS SURFACING
- LIMITS OF PAINTED CURB
- 1 PAINT 4" WIDE WHITE STRIPE PER DETAIL [H/PDX-1]
- 2 PAINT "STOP" 36" HIGH WHITE LETTERING
- 3 PAINT TOP AND FACE OF CURB RED WITH 4" HIGH LETTERING, "NO PARKING - FIRE LANE," AT 30' ON CENTER.
- 4 PAINT TOP AND FACE OF CURB GREEN WITH 4" HIGH LETTERING, "1-HOUR" TO MATCH EXISTING
- 5 PAINT TOP AND FACE OF CURB BLUE
- 6 PAINT WHEELSTOP GREEN WITH 4" HIGH LETTERING, "15 MIN. VISITOR" TO MATCH EXISTING
- 7 PAINT WHEELSTOP ORANGE WITH 4" HIGH LETTERING, "PDB ADMIN" TO MATCH EXISTING
- 8 PAINT TOP AND FACE OF CURB ORANGE WITH 4" HIGH LETTERING AS NOTED AT EACH STALL ON THE SITE PLAN
- 9 NEW ENTRY SIGN PER DETAIL [E/PDX-1]
- 10 PAINT ACCESS AREA WITH 4" WIDE WHITE BORDER, PAINT INSIDE ACCESS AREA WITH 4" WIDE WHITE DIAGONAL LINES AT 36" O.C.
- 11 PAINT DIRECTIONAL ARROW PER DETAIL [D/PDX-2]
- 12 NEW ACCESSIBLE PARKING SIGNAGE PER DETAIL [C/PDX-2]
- 13 REINSTALL SALVAGED WHEELSTOP PER DETAIL [I/PDX-1] AFTER SEALCOAT HAS BEEN APPLIED
- 14 EXISTING ACCESSIBLE PARKING SIGNAGE THAT MEETS THE MINIMUM REQUIREMENTS OF DETAIL [C/PDX-2]. NO WORK REQUIRED AS PART OF THIS PROJECT.
- 15 ACCESSIBLE PARKING STALLS AND ACCESS AISLES. SEE DETAIL [A/PDX-2] FOR ALL ACCESSIBILITY REQUIREMENTS

A PARKING LOT 'A' SITE PLAN
 PD-30

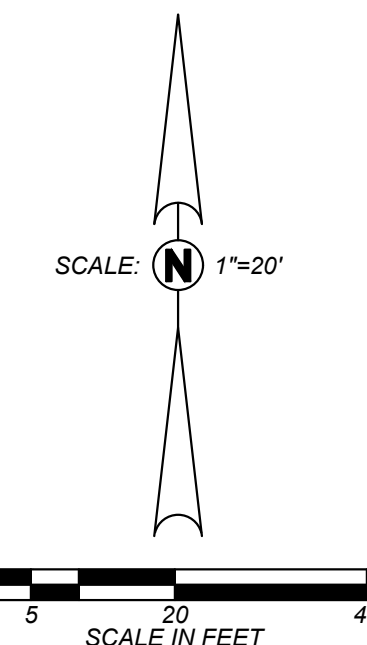

<p>Blair, Church & Flynn CONSULTING ENGINEERS</p>		CONSULTANT	REF. & REV.	CLOVIS UNIFIED SCHOOL DISTRICT	
		Blair, Church & Flynn Consulting Engineers 455. Clovis Avenue, Suite 500 Clovis, California 93612 Tel (559) 326-1400 Fax (559) 326-1500			2022 PAVEMENT REHABILITATION VARIOUS SITES PROFESSIONAL DEVELOPMENT SITE PLAN

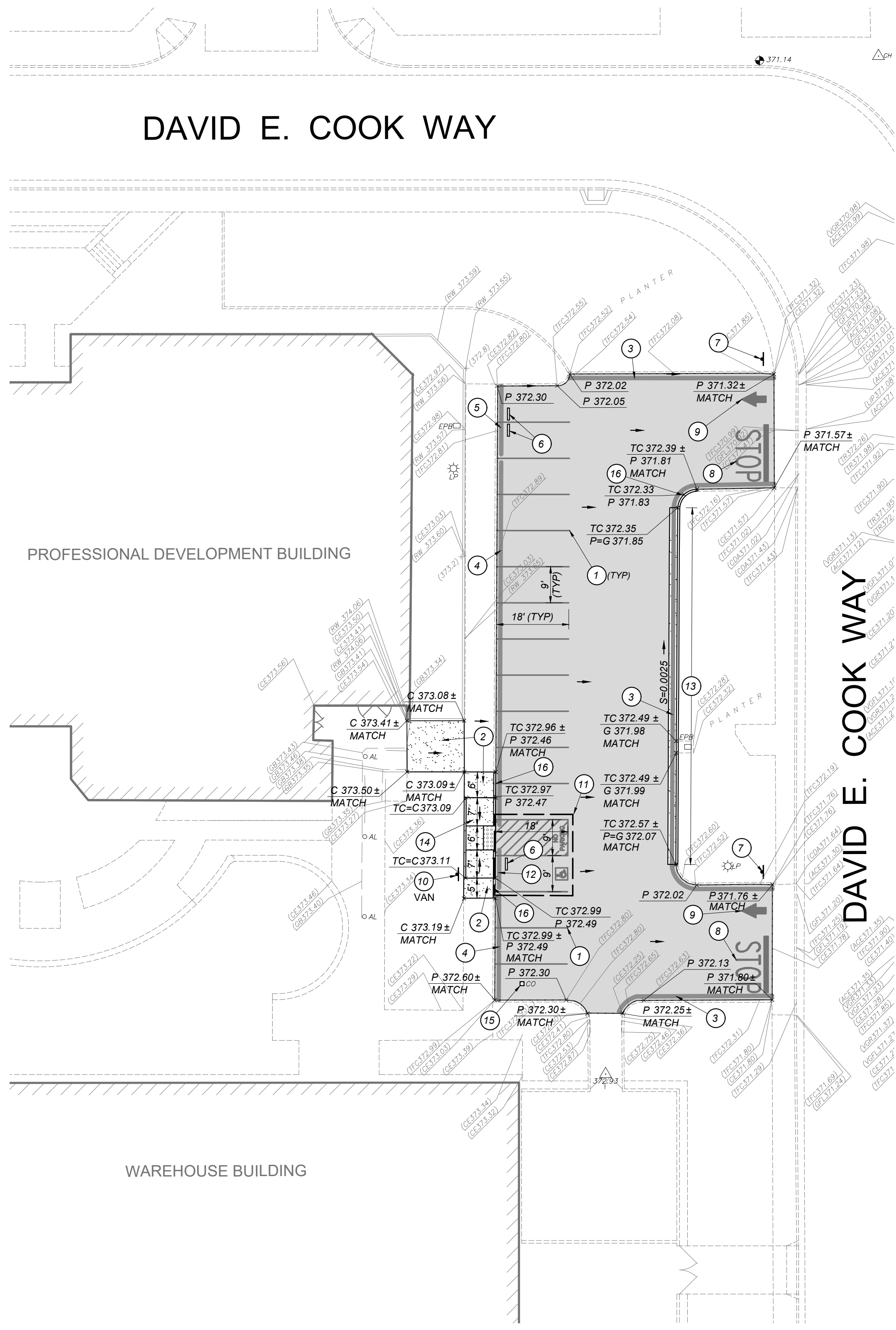

CONSTRUCTION LEGEND:

- [A/PDX-1] [DETAIL DESIGNATION / SHEET LOCATION]
- LIMITS OF CONCRETE IMPROVEMENTS
- LIMITS OF ASPHALTIC CONCRETE PAVEMENT
STRUCTURAL SECTION REMOVAL AND REPLACEMENT
PER PER DETAIL [A/CDX-1]
- LIMITS OF DETECTABLE WARNINGS SURFACING
- LIMITS OF PAINTED CURB
- C CONCRETE
- G GUTTER
- P PAVEMENT
- TC TOP OF CURB
- (368.20) EXISTING ELEVATION
- P 368.33 NEW FINISHED GRADE
- DIRECTION OF DRAINAGE
- 1 PAINT 4' WIDE WHITE STRIPE
- 2 CONCRETE SIDEWALK PER DETAIL [B/PDX-1]
- 3 PAINT TOP AND FACE OF CURB RED WITH 4' HIGH
WHITE LETTERING, "NO PARKING - FIRE LANE", AT 30' ON
CENTER.
- 4 PAINT TOP AND FACE OF CURB ORANGE
- 5 PAINT TOP AND FACE OF CURB ORANGE WITH 4'
HIGH WHITE LETTERING "DISTRICT ELECTRIC
VEHICLE ONLY" TO MATCH EXISTING.
- 6 REINSTALL SALVAGED WHEELSTOP PER DETAIL
[I/PDX-1] AFTER SEALCOAT HAS BEEN APPLIED
- 7 NEW ENTRY SIGN PER DETAIL [E/PDX-1]
- 8 PAINT "STOP" 36" HIGH WHITE LETTERING
- 9 PAINT DIRECTIONAL ARROW PER DETAIL [D/PDX-2]
- 10 ACCESSIBLE SIGNAGE PER DETAIL [C/PDX-2]
- 11 ACCESSIBLE PARKING STALL AND ACCESS AISLE. SEE
DETAIL [A/PDX-2] FOR ALL ACCESSIBILITY
REQUIREMENTS
- 12 PAINT TOP AND FACE OF CURB BLUE
- 13 NEW CURB AND GUTTER PER DETAIL [L/PDX-1]
- 14 PARALLEL CURB RAMP PER DETAIL [E/PDX-2]
- 15 ADJUST UTILITY LID TO MATCH NEW GRADES AND
PROVIDE A CONCRETE COLLAR PER DETAIL [F/PDX-1]
- 16 CONCRETE CURB PER DETAIL [I/PDX-1]

A PARKING LOT 'B' SITE PLAN
 PD-31

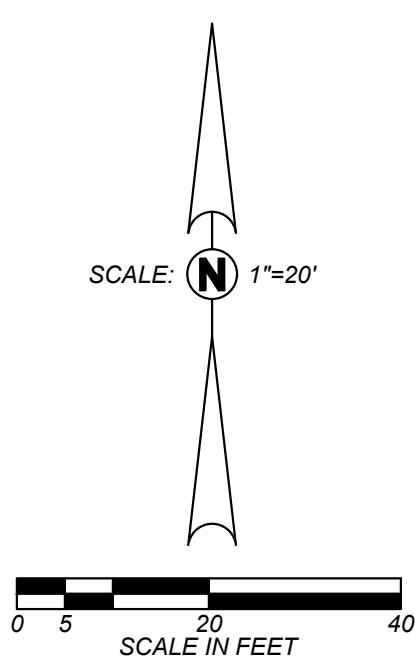

Blair, Church & Flynn
 CONSULTING ENGINEERS
 455. Clovis Avenue,
 Suite 500
 Clovis, California 93612
 Tel (559) 326-1400
 Fax (559) 326-1500

CONSULTANT	REF. & REV.	CLOVIS UNIFIED SCHOOL DISTRICT	
Blair, Church & Flynn Consulting Engineers 455. Clovis Avenue, Suite 500 Clovis, California 93612 Tel (559) 326-1400 Fax (559) 326-1500		2022 PAVEMENT REHABILITATION VARIOUS SITES PROFESSIONAL DEVELOPMENT SITE AND GRADING PLAN	
		CONST. DOCUMENTS	PD-31
		DR. BY: AH	
		CH. BY: JF	
		DATE: 01/21/2022	
		SCALE AS NOTED	

NOTE:
 1. CONTRACTOR MAY SUBSTITUTE THE SECTION SHOWN IN DETAIL (D/PDX-1) FOR SMALL AREAS OF PAVEMENT REPLACEMENT
 2. SEAL COAT IS ONLY APPLIED TO NEW PAVEMENT WHEN IT IS ADJACENT TO EXISTING PAVEMENT THAT IS RECEIVING A SEAL COAT

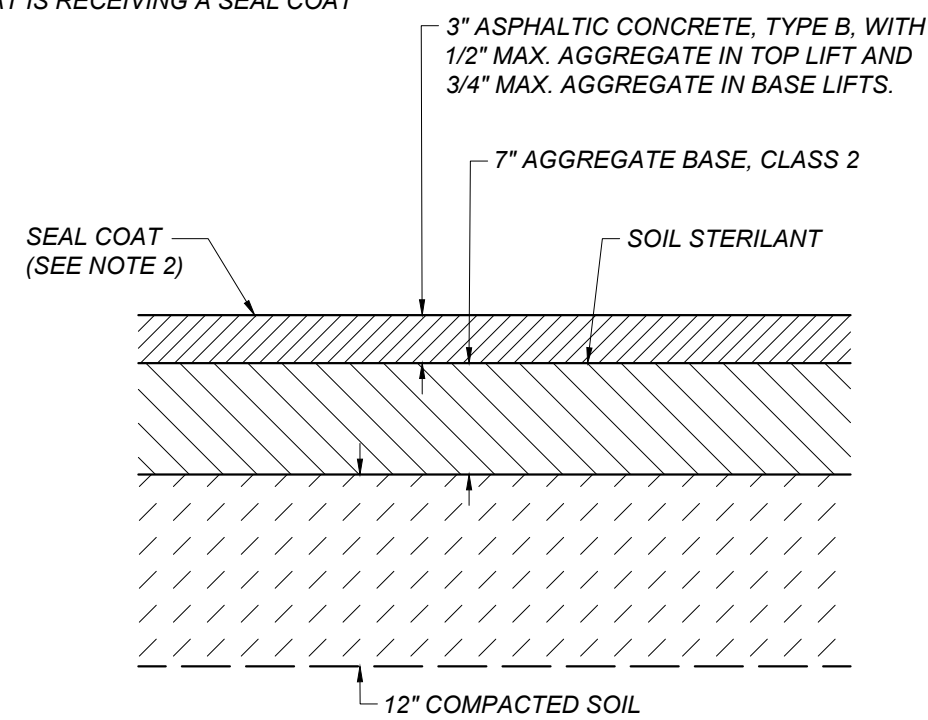

A ASPHALT CONCRETE PAVEMENT SECTION
 PDX-1 NOT TO SCALE

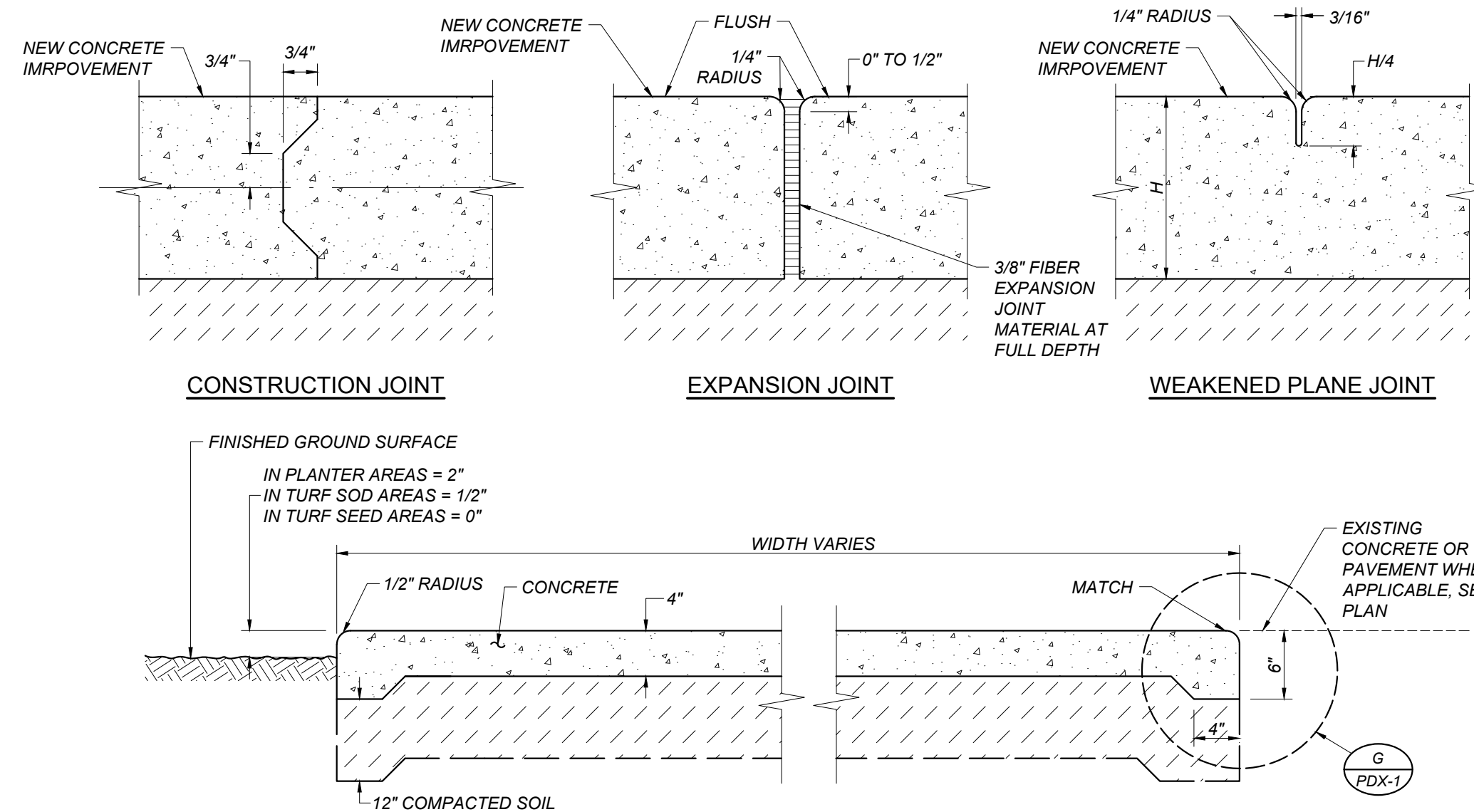

B CONCRETE SIDEWALK
 PDX-1 NOT TO SCALE

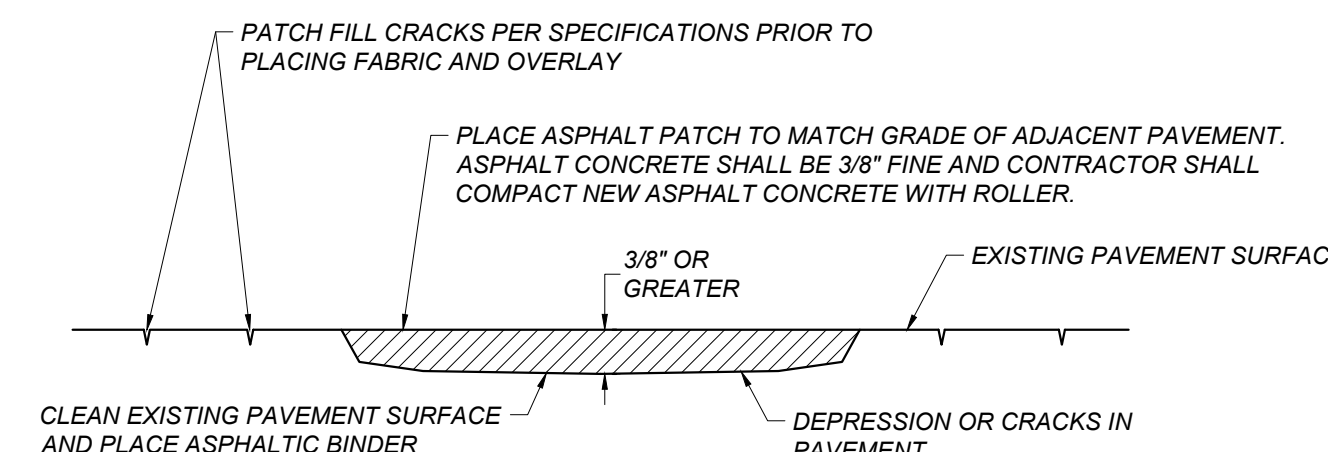

C CRACK PATCHING DETAIL
 PDX-1 NOT TO SCALE

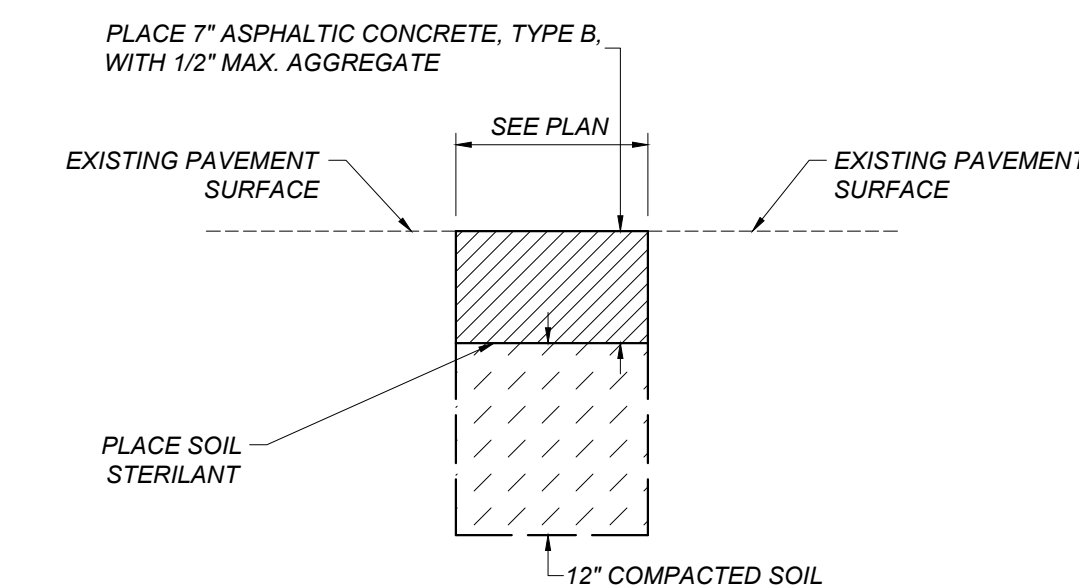

D ASPHALT CONCRETE PLUG
 PDX-1 NOT TO SCALE

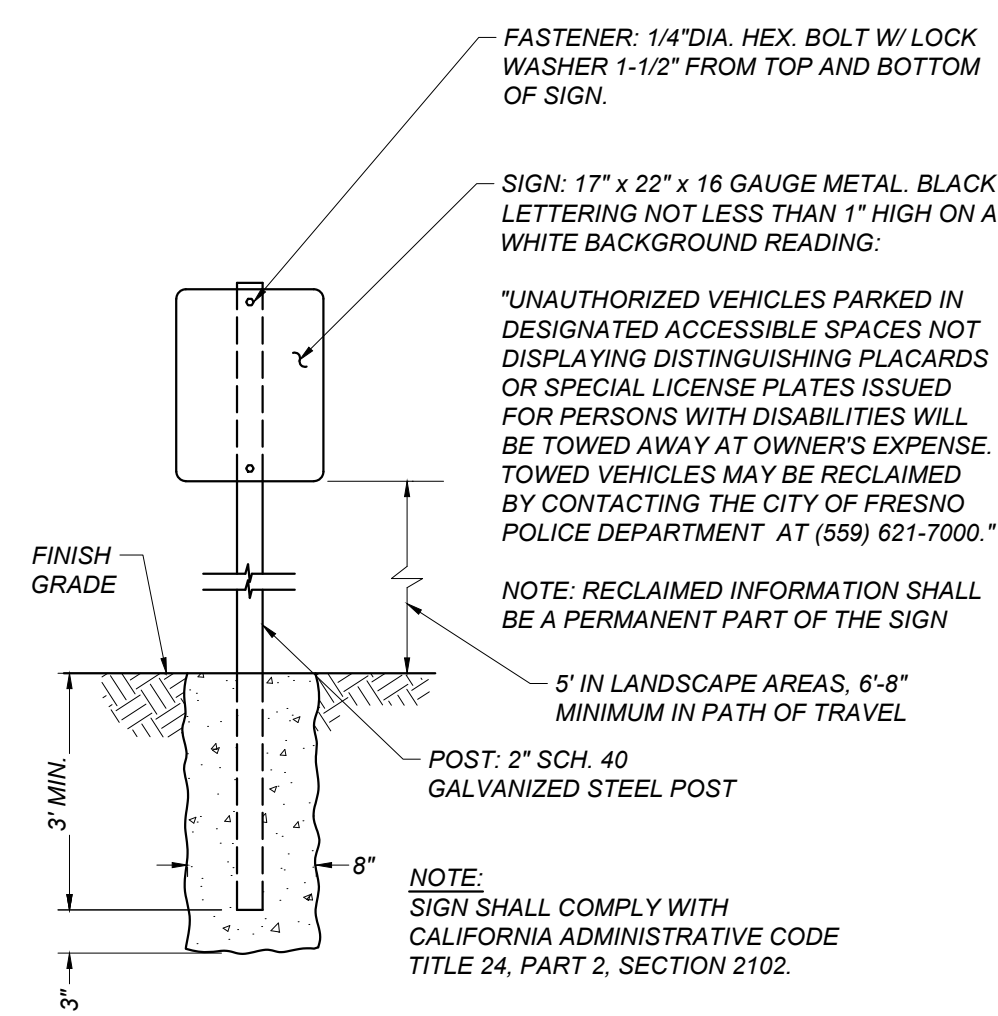

E ENTRY SIGN
 PDX-1 NOT TO SCALE

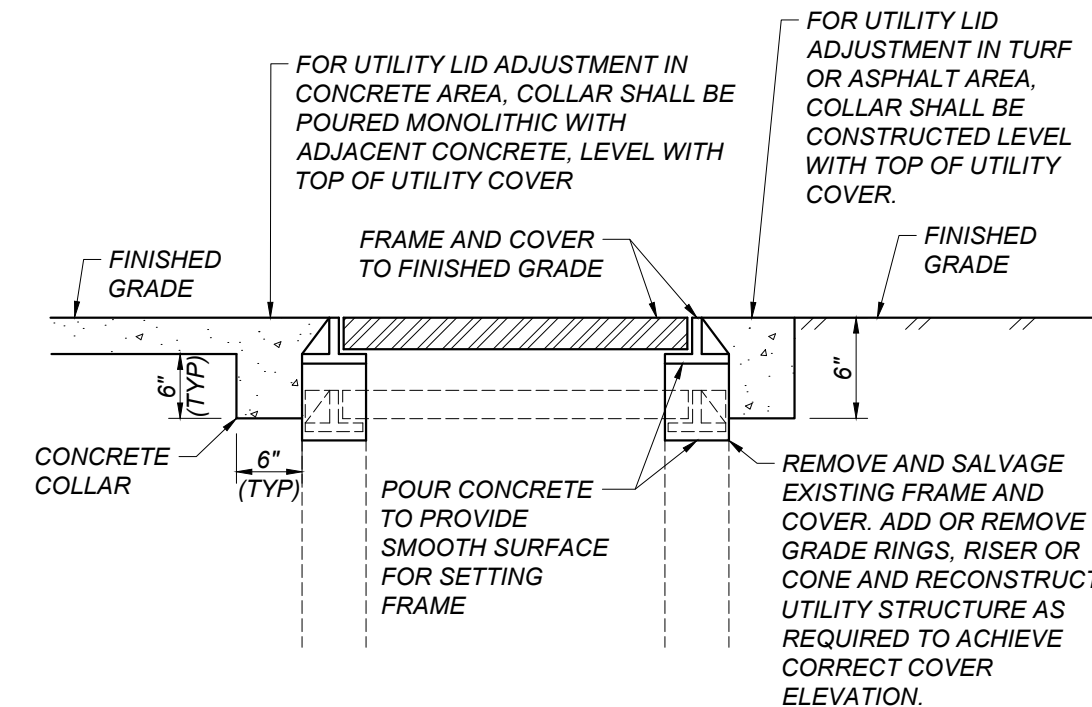

F ADJUST UTILITY LID
 PDX-1 NOT TO SCALE

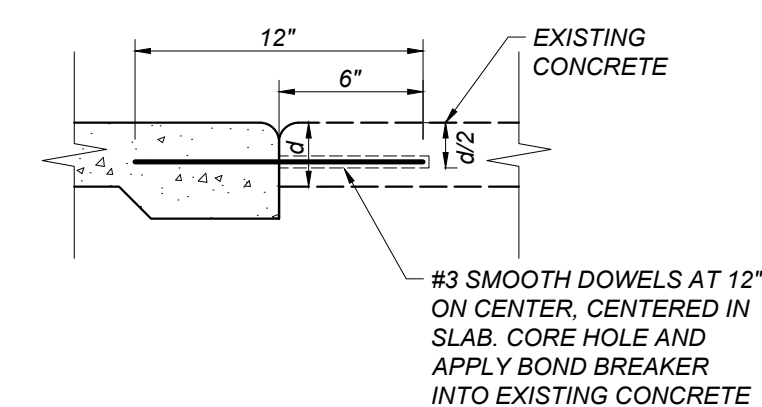

G DOWEL BAR DETAIL
 PDX-1 NOT TO SCALE

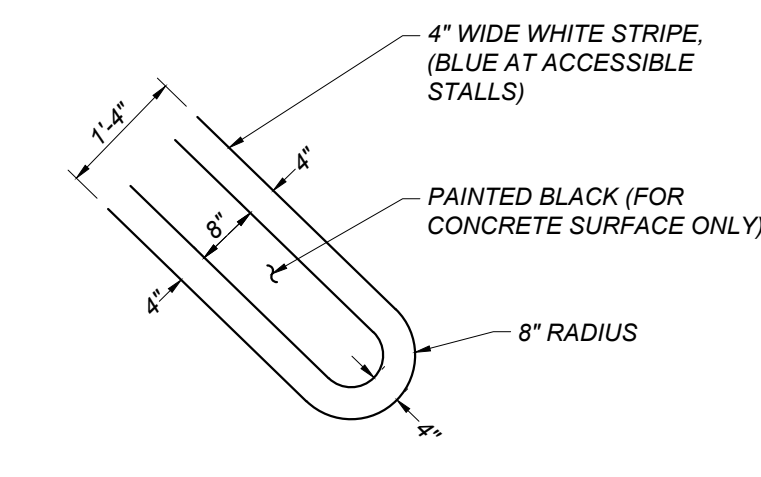

H DOUBLE PAVING STRIPE
 PDX-1 NOT TO SCALE

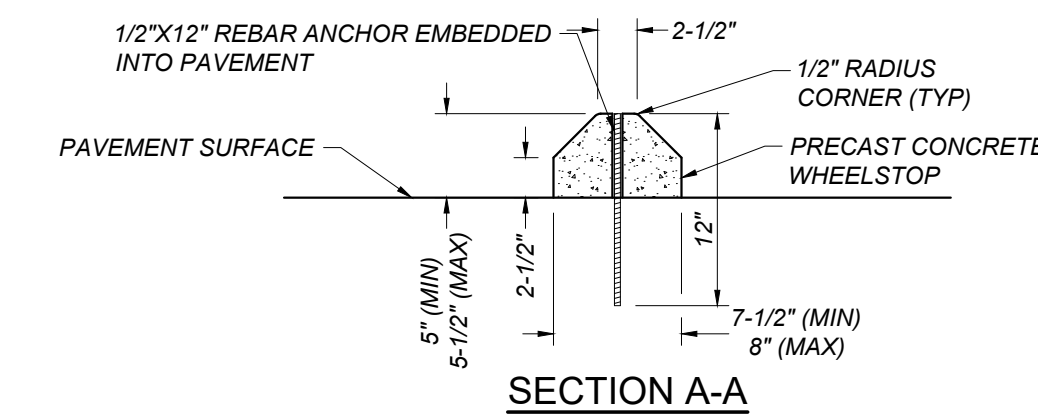
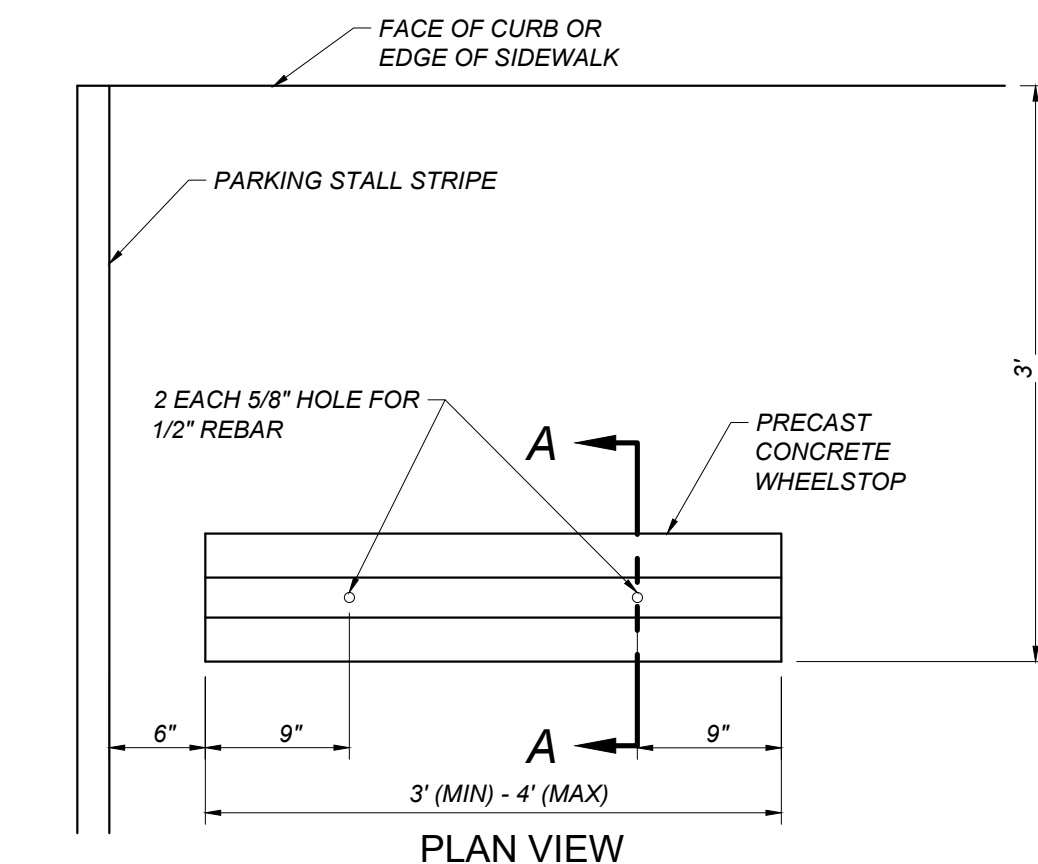

I DETAIL OF TYPICAL WHEELSTOP
 PDX-1 NOT TO SCALE

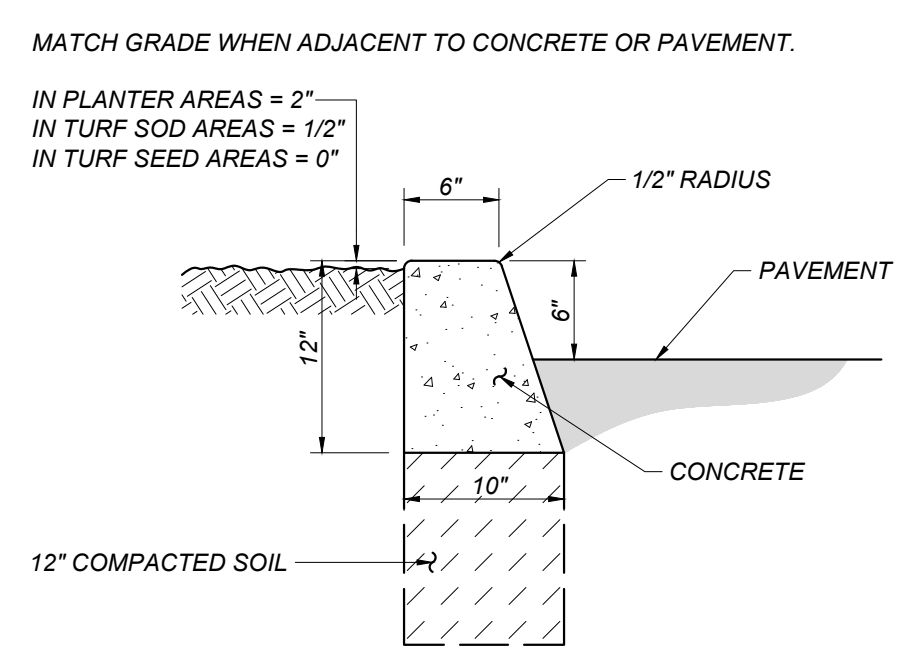

**J 6\"/>
 PDX-1 NOT TO SCALE**

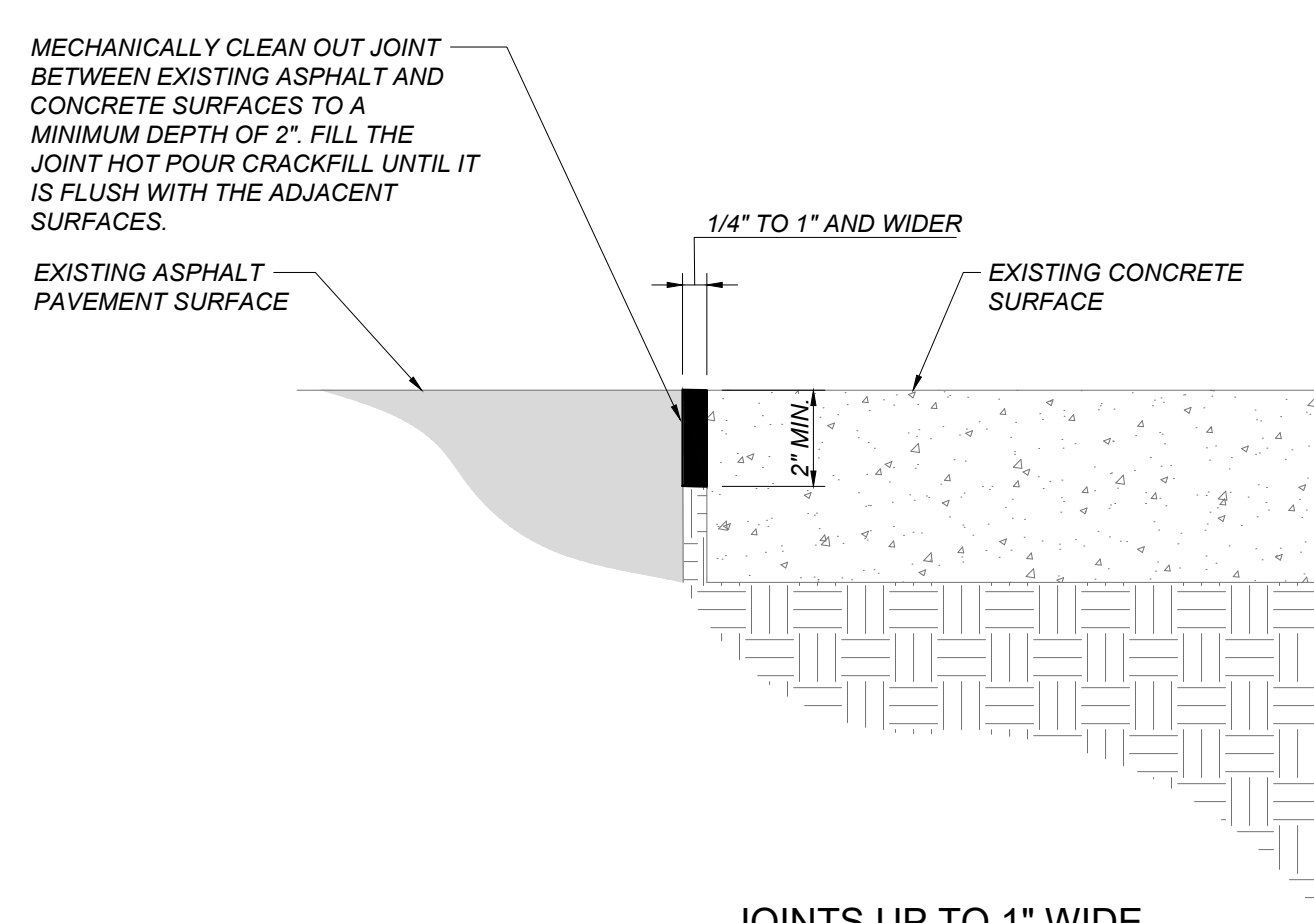

K ASPHALT EDGE CONDITION TREATMENT
 PDX-1 NOT TO SCALE

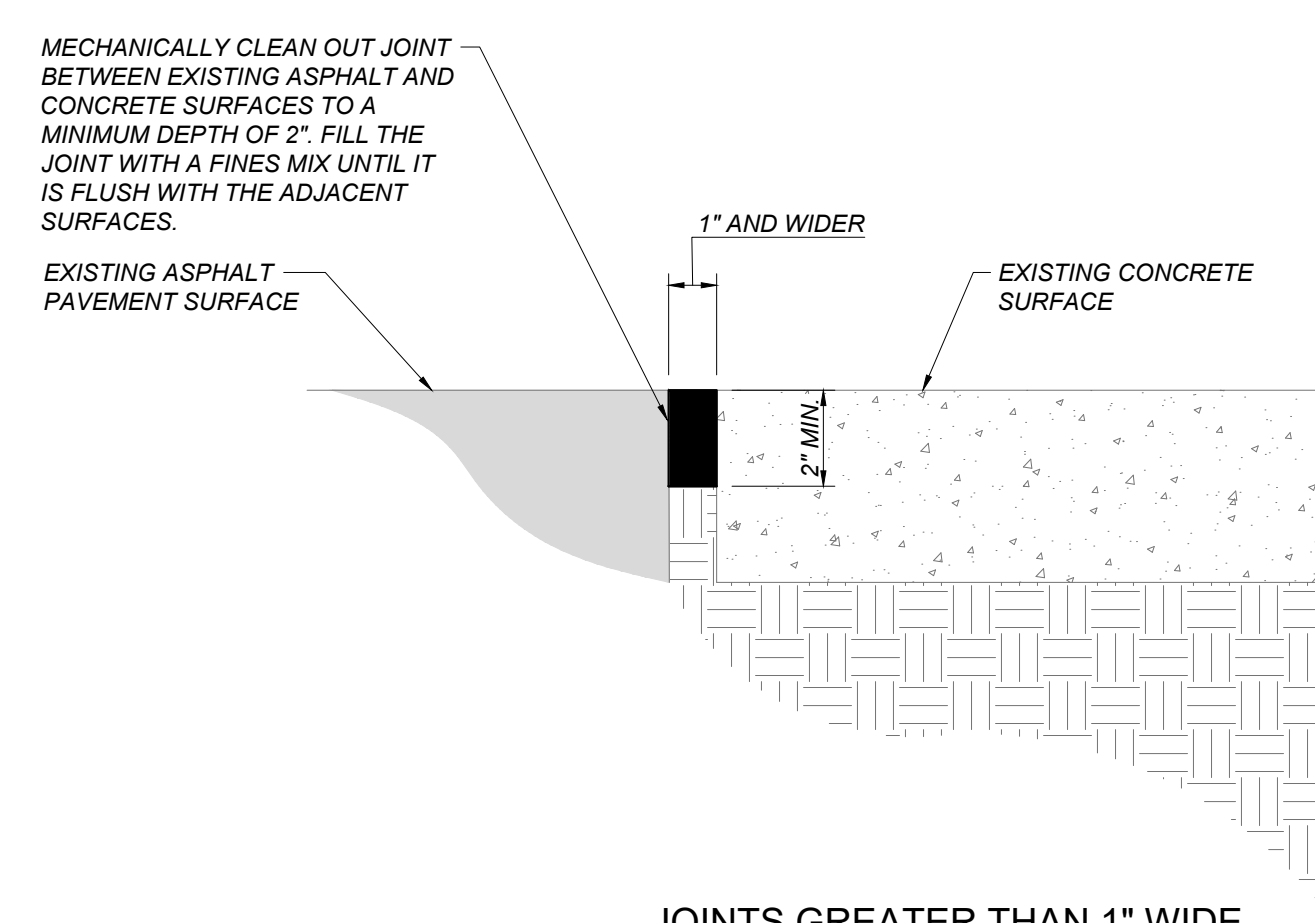

L CONCRETE CURB AND GUTTER
 PDX-1 NOT TO SCALE

	CONSULTANT	REF. & REV.	CLOVIS UNIFIED SCHOOL DISTRICT	
	Blair, Church & Flynn Consulting Engineers 451 Clovis Avenue, Suite 200 Clovis, California 93612 Tel (559) 326-1400 Fax (559) 326-1500		2022 PAVEMENT REHABILITATION VARIOUS SITES PROFESSIONAL DEVELOPMENT DETAILS	
CONST. DOCUMENTS DR. BY: AH CH. BY: JF DATE: 01/21/2022 SCALE AS NOTED		PDX-1		

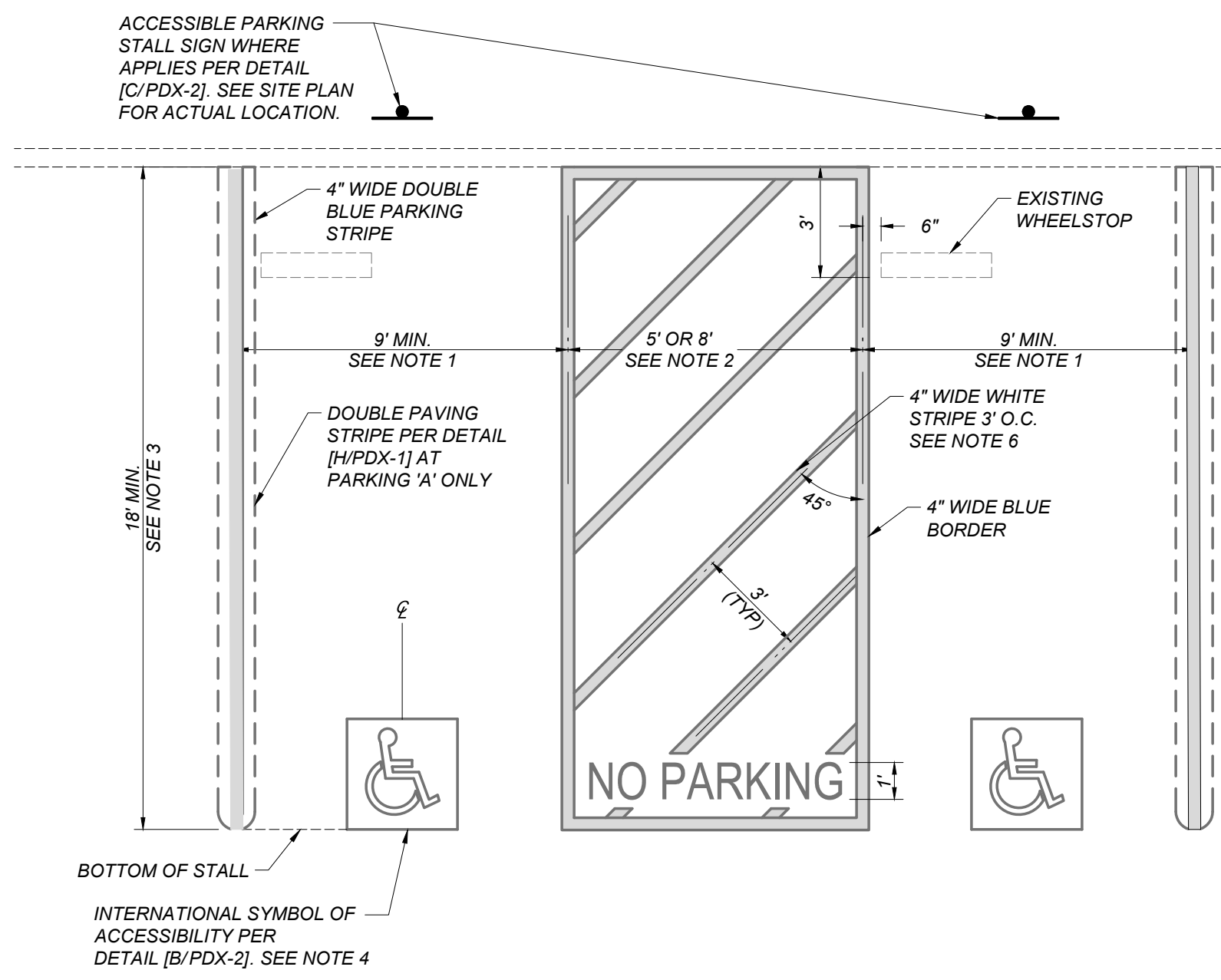

- NOTES:**
1. ACCESSIBLE STALLS SHALL BE A MINIMUM OF 9' WIDE AND MEASURED FROM THE CENTERLINE OF PARKING STALLS AND ACCESS AISLES. MATCH EXISTING DIMENSIONS ON SITE.
 2. ACCESS AISLES SHALL BE A MINIMUM OF 5', AND 8' WHEN ADJACENT TO A VAN ACCESSIBLE STALL. MATCH EXISTING DIMENSIONS ON SITE.
 3. ACCESSIBLE STALLS SHALL BE A MINIMUM OF 18' LONG. MATCH EXISTING DIMENSIONS ON SITE.
 4. CENTERLINE OF INTERNATIONAL SYMBOL OF ACCESSIBILITY SHALL BE A MAXIMUM OF 6" FROM THE CENTERLINE OF THE STALL, AND THE BOTTOM SHALL BE ALIGNED WITH THE BOTTOM OF THE STALL.
 5. SLOPES AT ACCESSIBLE STALLS AND ACCESS AISLES SHALL NOT EXCEED 2% IN ANY DIRECTION.
 6. PROVIDE BLUE HATCHED LINES WHEN ACCESS AISLE IS STRIPED ON CONCRETE TO COMPLY WITH CBC 11B-502.3.3

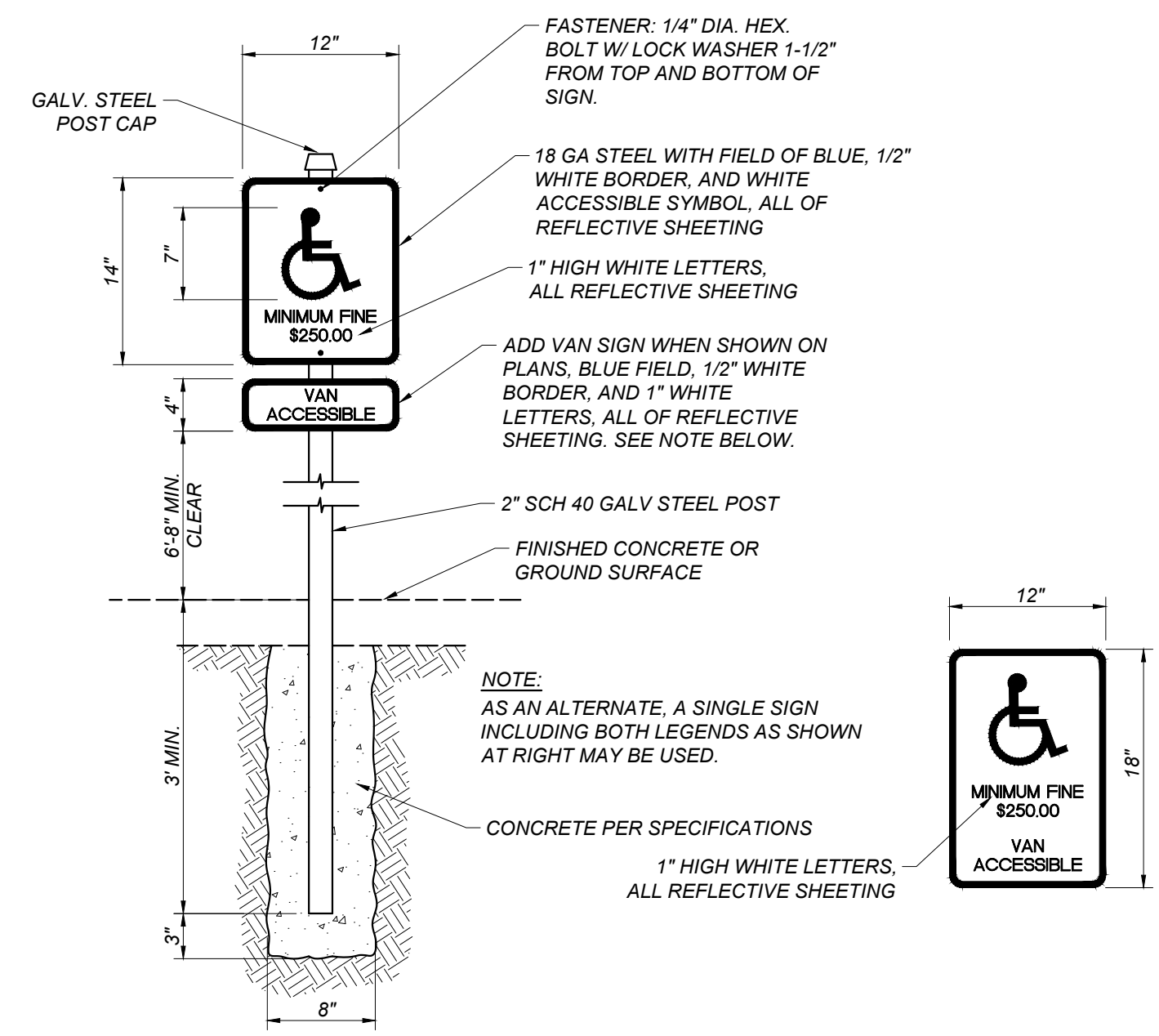
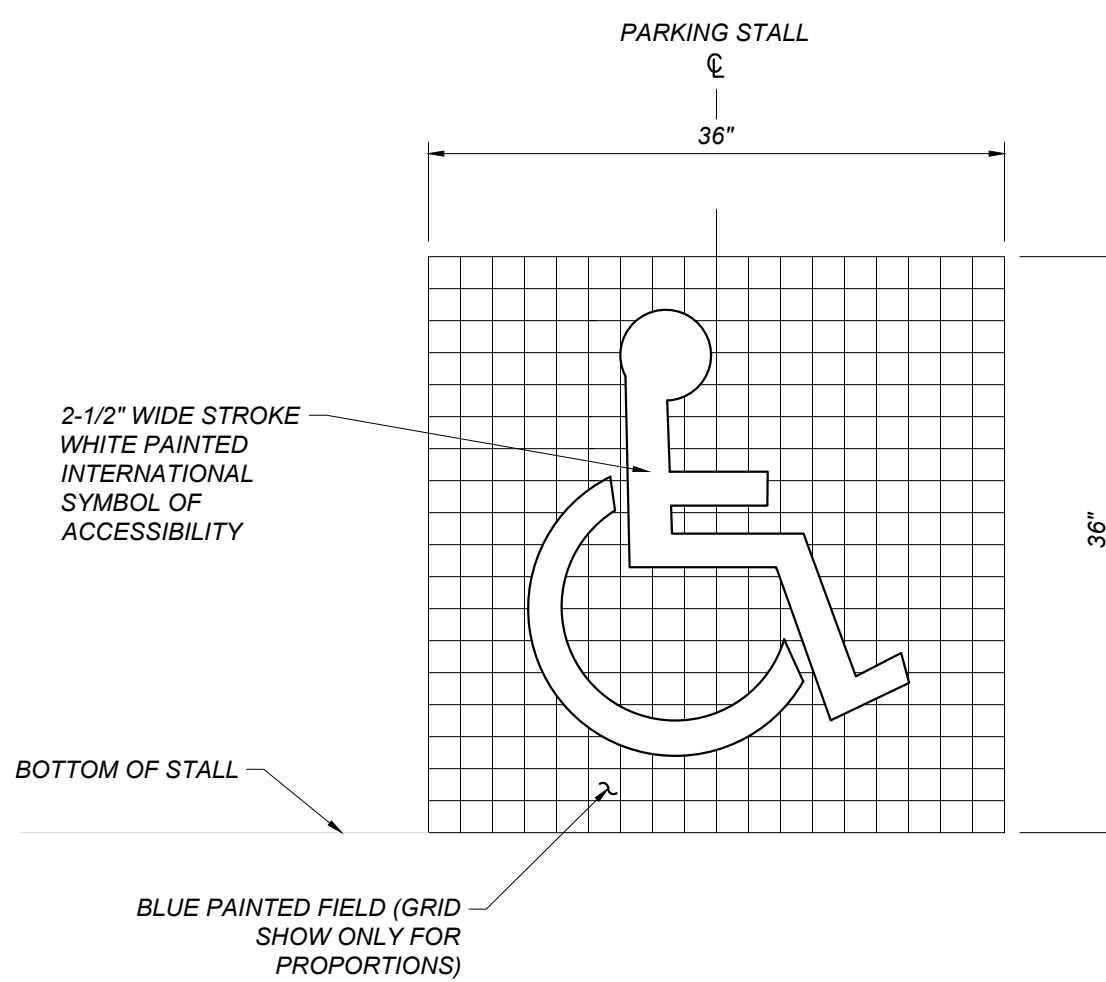

A ACCESSIBLE PARKING STALL DETAIL
 PDX-2 NOT TO SCALE

B ACCESSIBLE SYMBOL
 PDX-2 NOT TO SCALE

C ACCESSIBLE PARKING STALL SIGNAGE
 PDX-2 NOT TO SCALE

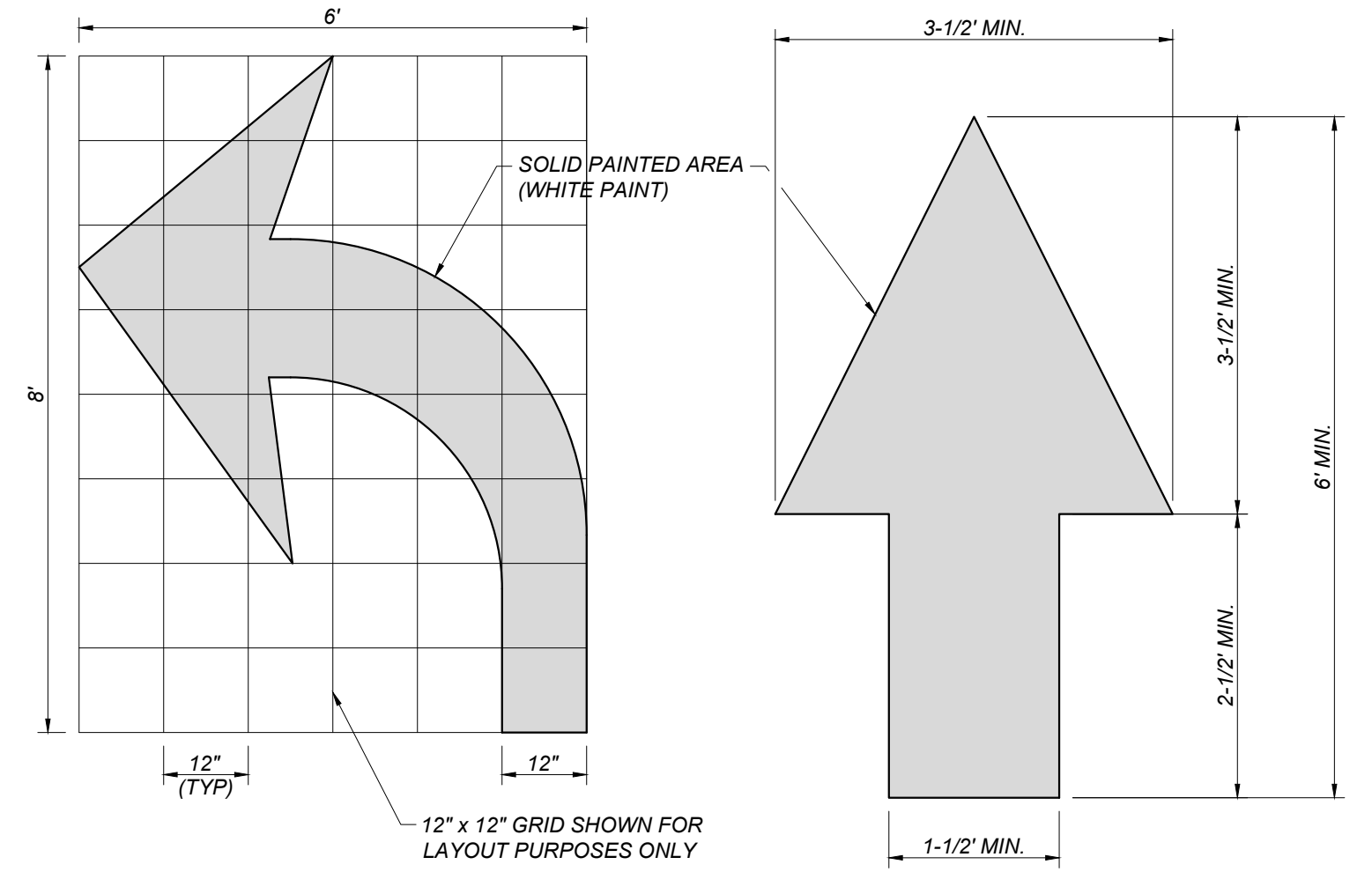

NOTE:
 CALTRANS TYPE (V/L) SHOWN. USE MIRROR IMAGE FOR RIGHT TURN.

D DIRECTIONAL ARROWS
 PDX-2 NOT TO SCALE

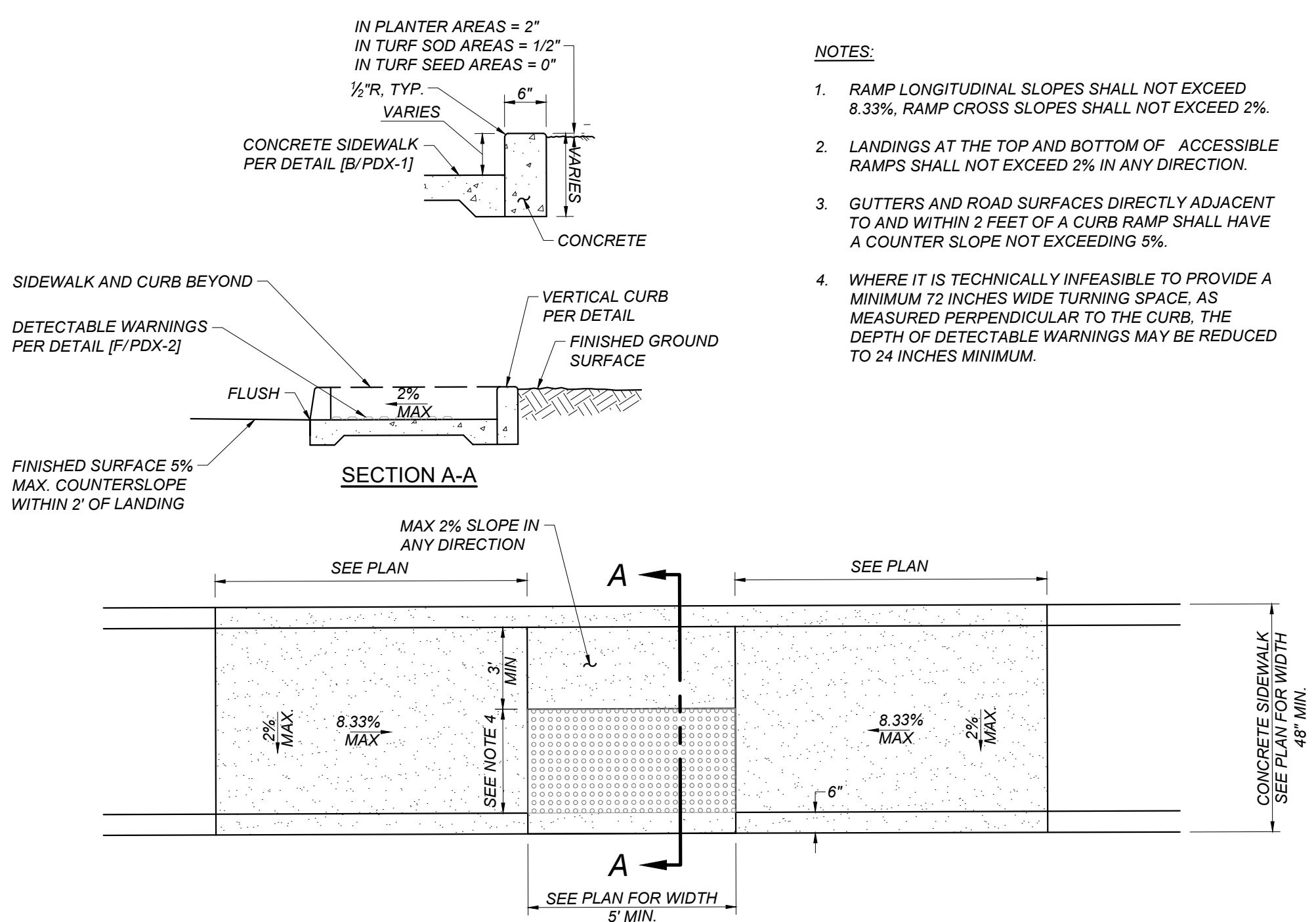

- NOTES:**
1. RAMP LONGITUDINAL SLOPES SHALL NOT EXCEED 8.33%. RAMP CROSS SLOPES SHALL NOT EXCEED 2%.
 2. LANDINGS AT THE TOP AND BOTTOM OF ACCESSIBLE RAMPS SHALL NOT EXCEED 2% IN ANY DIRECTION.
 3. GUTTERS AND ROAD SURFACES DIRECTLY ADJACENT TO AND WITHIN 2 FEET OF A CURB RAMP SHALL HAVE A COUNTER SLOPE NOT EXCEEDING 5%.
 4. WHERE IT IS TECHNICALLY INFEASIBLE TO PROVIDE A MINIMUM 72 INCHES WIDE TURNING SPACE, AS MEASURED PERPENDICULAR TO THE CURB, THE DEPTH OF DETECTABLE WARNINGS MAY BE REDUCED TO 24 INCHES MINIMUM.

E CONCRETE CURB RAMP
 PDX-2 NOT TO SCALE

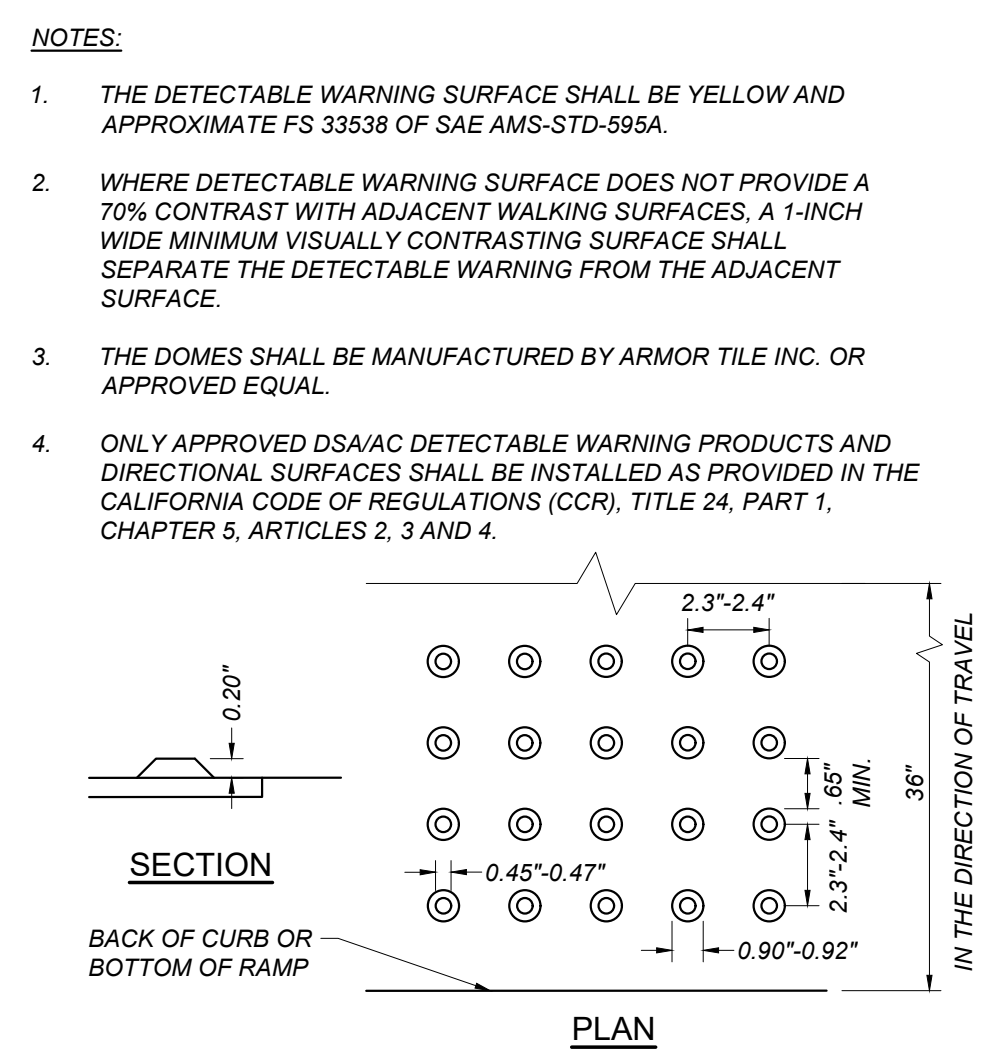

- NOTES:**
1. THE DETECTABLE WARNING SURFACE SHALL BE YELLOW AND APPROXIMATE FS 33538 OF SAE AMS-STD-595A.
 2. WHERE DETECTABLE WARNING SURFACE DOES NOT PROVIDE A 70% CONTRAST WITH ADJACENT WALKING SURFACES, A 1-INCH WIDE MINIMUM VISUALLY CONTRASTING SURFACE SHALL SEPARATE THE DETECTABLE WARNING FROM THE ADJACENT SURFACE.
 3. THE DOMES SHALL BE MANUFACTURED BY ARMOR TILE INC. OR APPROVED EQUAL.
 4. ONLY APPROVED DSA/AC DETECTABLE WARNING PRODUCTS AND DIRECTIONAL SURFACES SHALL BE INSTALLED AS PROVIDED IN THE CALIFORNIA CODE OF REGULATIONS (CCR), TITLE 24, PART 1, CHAPTER 5, ARTICLES 2, 3 AND 4.

F DETECTABLE WARNINGS
 PDX-2 NOT TO SCALE